

**The Female
Flare Swivel Transition**

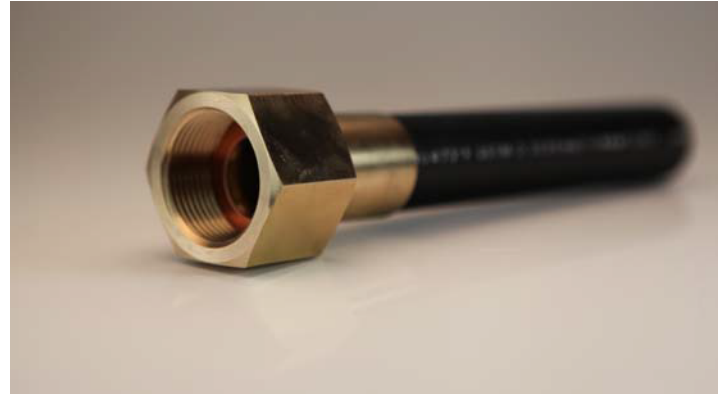
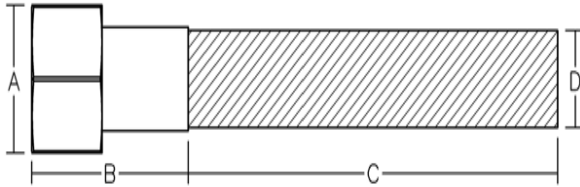

Flare Size	POLY-CAM Male Flare Material	Coupling Diameter	Coupling Length	HDPE Length	HDPE Diameter Size
		<i>A</i>	<i>B</i>	<i>C</i>	<i>D</i>
3/4	C954	1.520	1.725	4.0	1.050
1	C954	1.865	2.000	4.0	1.315
1 1/4	C954	2.400	2.350	5.0	1.660
1 1/2	C954	2.825	2.650	5.0	1.900
2	C954	3.550	3.500	5.0	2.375

Fully pressure rated to pipe SDR installed (160PSI, 200PSI)
 Type 304 Stainless Steel insert install to meet and exceed ASTM D2513 Category 1.
 It is a material that complies with California AB1953, SB1334 and SB1935.
 Requires a copper gasket.

Fully pressure rated . Standard SDR sizes 7, 9, 11,
 Manufactured to ASTM D2513 Cat. 1 D1599, D1598, F-714, ASTM D3350