

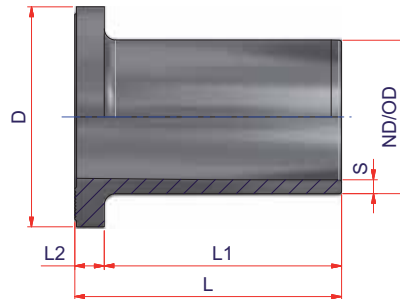



BUTT FUSION FITTINGS



LONG SPIGOT STUB END

PE4710 230PSI SDR11 • IPS

Code	Nominal Diameter ϕ (ND)	Pack.	Q.ty pallet	Weight lb/p.	Volume ft ³ /p.	OD	S min	L2	D	L1	L	
12EICRT02	2" IPS	75	900	0.475	0.0378	2.375	0.216	0.39	3.94	5.47	5.91	150 PSI
12EICRT03	3" IPS	70	280	1.006	0.1029	3.500	0.318	0.63	5.00	5.39	6.06	150 PSI
12EICRT04	4" IPS	-	-	1.445	-	4.500	0.409	0.75	6.02	5.28	6.06	150 PSI
12EICRT06	6" IPS	-	-	4.287	-	6.625	0.603	0.98	8.58	6.97	7.99	150 PSI
12EICRT08	8" IPS	-	-	7.665	-	8.625	0.785	1.02	10.63	8.27	9.33	150 PSI
12EICRT10	10" IPS	-	-	11.046	-	10.750	0.977	1.38	12.52	7.64	9.06	150 PSI
12EICRT12	12" IPS	-	-	21.055	-	12.750	1.159	1.61	15.04	10.35	12.01	150 PSI
12EICRT14	14" IPS	-	-	25.749	-	14.000	1.273	1.67	16.93	10.28	12.01	150 PSI
12EICRT16	16" IPS	-	-	34.493	-	16.000	1.455	1.89	19.25	10.06	12.01	150 PSI
12EICRT18	18" IPS	-	-	39.387	-	18.000	1.636	2.03	21.26	9.92	12.01	150 PSI
12EICRT20	20" IPS	-	-	51.117	-	20.000	1.818	2.30	22.91	9.65	12.01	150 PSI
12EICRT24	24" IPS	-	-	74.752	-	24.000	2.182	2.76	27.26	9.19	12.01	150 PSI
12EICRT28	28" IPS	-	-	113.770	-	28.000	2.545	3.27	31.30	10.28	13.60	150 PSI
12EICRT30	30" IPS	-	-	130.341	-	30.000	2.727	3.52	33.94	10.31	13.90	
12EICRT36	36" IPS	-	-	209.956	-	36.000	3.273	4.15	39.13	11.38	15.59	