

ELECTROFUSION FITTINGS

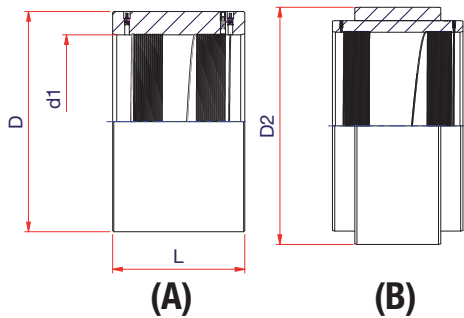
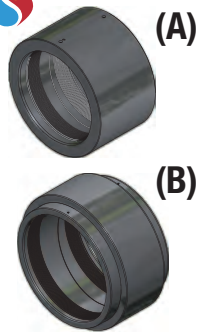

IPS ELECTROFUSION COUPLER

With pre-heating bar code from (ø)10"

PE4710 230PSI

Code	Nominal Size IPS	Min DR	pcs/ box	Q.ty pallet	Weight kg./p.	Volume m ³ /p.	d1 (IPS)	D	D2	L
12EIME10 (A)	10"	17.00	12	24	9.417	0.0424	10"	13.98	-	8.66
12EIME12 (A)	12"	17.00	10	20	10.600	0.0509	12"	15.75	-	9.45
12EIME14 (A)	14"	17.00	6	12	16.600	0.0848	14"	17.72	-	10.24
12EIME16 (A)	16"	17.00	6	12	21.160	0.0848	16"	19.68	-	11.42
12EIME18 (A)	18"	17.00	4	4	30.500	0.2256	18"	22.05	-	13.38
12EIME20 (A)	20"	17.00	4	8	-	0.1272	20"	24.09	-	14.17
12EIME22 (B)	22"	17.00	3	3	50.660	0.3040	22"	-	27.95	15.75
12EIME24 (A)	24"	17.00	3	6	-	0.1696	24"	27.95	-	17.32
12EIME30 (B)	30"	17.00	1	1	-	-	30"	-	35.43	18.89

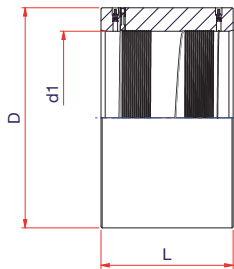

DIPS ELECTROFUSION COUPLER

With pre-heating bar code from (ø) 10"

PE4710

Code	Nominal Size DIPS	Min DR	pcs/ box	Q.ty pallet	Weight kg./p.	Volume m ³ /p.	d1 (DIPS)	D	L
12EIMED08	8"	-	24	48	4.150	0.0212	8"	11.02	7.09
12EIMED10	10"	-	12	24	9.417	0.0424	10"	13.97	8.66
12EIMED12	12"	-	10	20	10.600	0.0509	12"	15.75	8.66
12EIMED14	14"	-	6	12	16.600	0.0848	14"	-	-
12EIMED16	16"	-	6	12	21.160	0.0848	16"	-	-
12EIMED18	18"	-	4	8	30.500	0.2256	18"	-	-
12EIMED20	20"	-	4	8	-	0.1272	20"	-	-
12EIMED22	22"	-	1	1	50.660	0.3040	22"	-	-
12EIMED24	24"	-	1	1	-	0.1696	24"	-	-

ELECTROFUSION FITTINGS

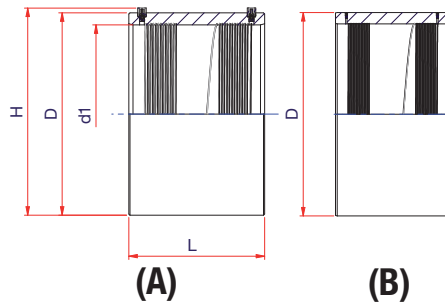

IPS ELECTROFUSION COUPLER

With pre-heating bar code from (ø) 10"

PE4710 160PSI

Code	Nominal Size IPS	Min DR	pcs/box	Q.ty pallet	Weight kg./p.	Volume m ³ /p.	d1 (IPS)	D	H	L
12DIME08 (A)	8"	21.00	24	48	-	-	8"	9.84	10.36	7.08
12DIME10 (A)	10"	21.00	16	32	-	-	10"	12.40	12.79	8.66
12DIME12 (A)	12"	21.00	12	24	-	-	12"	15.75	15.75	8.66
12DIME14 (A)	14"	21.00	10	20	-	-	14"	15.74	15.94	10.23
12DIME16 (A)	16"	21.00	6	12	-	-	16"	17.72	17.91	11.42
12DIME18 (A)	18"	21.00	4	8	-	-	18"	19.69	19.88	13.39
12DIME20 (B)	20"	21.00	4	8	-	-	20"	22.05	-	14.17
12DIME22 (B)	22"	21.00	3	3	-	-	22"	24.80	-	15.75
12DIME24 (B)	24"	21.00	1	2	-	-	24"	27.95	-	17.32
12DIME28 (B)	28"	21.00	1	2	-	-	28"	31.50	-	18.90
12DIME32 (B)	32"	21.00	1	1	-	-	32"	35.43	-	19.68
12DIME36 (B)	36"	21.00	1	1	-	-	36"	39.37	-	19.68

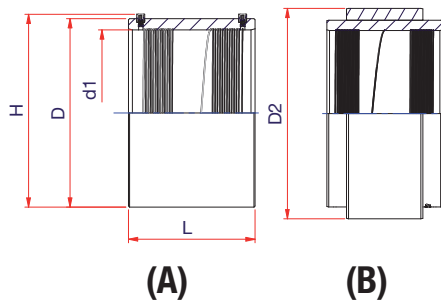

DIPS ELECTROFUSION COUPLER

With pre-heating bar code from (ø)10"

PE4710 160PSI

Code	Nominal Size DIPS	Min DR	pcs/box	Q.ty pallet	Weight kg./p.	Volume m ³ /p.	d1 (DIPS)	D	H	D2	L
12DIMED08 (A)	8"	21.00	16	32	-	-	8"	9.84	10.27	-	7.08
12DIMED10 (A)	10"	21.00	22	44	-	-	10"	13.98	13.98	-	8.66
12DIMED12 (A)	12"	21.00	12	24	-	-	12"	15.75	15.75	-	8.66
12DIMED14 (A)	14"	21.00	10	20	-	-	14"	17.72	17.72	-	10.24
12DIMED16 (A)	16"	21.00	6	12	-	-	16"	19.69	19.69	-	13.38
12DIMED18 (A)	18"	21.00	4	8	-	-	18"	22.05	22.05	-	14.17
12DIMED20 (A)	20"	21.00	4	8	-	-	20"	24.80	24.80	-	15.75
12DIMED24 (B)	24"	21.00	2	4	-	-	24"	27.95	-	31.50	17.32

ELECTROFUSION FITTINGS

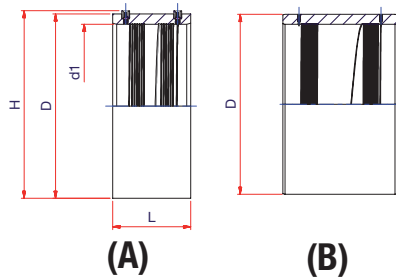
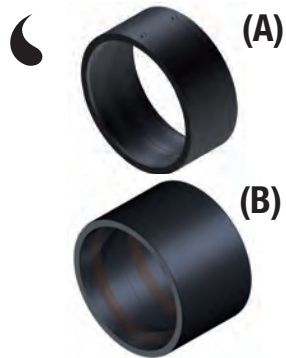

IPS SEWAGE ELECTROFUSION COUPLER

With pre-heating bar code

PE4710 45PSI

Code	Nominal Size IPS	Min DR	pcs/ box	Q.ty pallet	Weight kg./p.	Volume m ³ /p.	d1 (IPS)	D	H	L
12FIME10 (A)	10"	33.00	22	44	-	-	10"	12.40	12.79	6.30
12FIME12 (A)	12"	33.00	12	24	-	-	12"	15.75	15.75	6.30
12FIME14 (A)	14"	33.00	10	20	-	-	14"	15.74	15.94	8.27
12FIME16 (A)	16"	33.00	6	12	-	-	16"	17.72	17.91	8.27
12FIME18 (A)	18"	33.00	4	8	-	-	18"	19.69	19.88	8.27
12FIME20 (B)	20"	33.00	4	8	-	-	20"	22.05	-	8.27
12FIME22 (B)	22"	33.00	1	-	-	-	22"	24.80	-	9.84
12FIME24 (B)	24"	33.00	1	-	-	-	24"	27.95	-	9.84

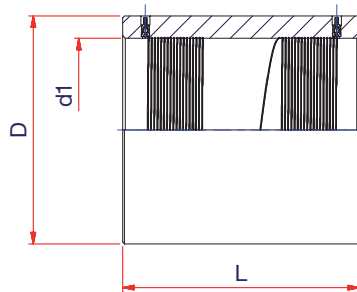

IPS ELECTROFUSION COUPLER

With pre-heating bar code from (ø) 8"

PE4710 380PSI

Code	Nominal Size IPS	Min DR	pcs/ box	Q.ty pallet	Weight kg./p.	Volume m ³ /p.	d1 (IPS)	D	L
12GIME06	06"	7.4	-	-	-	-	06"	-	-
12GIME08	08"	7.4	33	33	7.212	0.0276	08"	11.02	10.63
12GIME10	10"	7.4	12	12	13.500	0.0752	10"	13.98	12.60
12GIME12	12"	7.4	10	10	14.850	0.0900	12"	15.75	12.60