

# HDPE CHECK VALVE

STANDARD: ANSI

Fluid control valve. Allows flow in only one direction and prevents backflow.

Applications: irrigation, waterworks, agriculture, mining, industry, etc.



## DESIGN SPECIFICATIONS

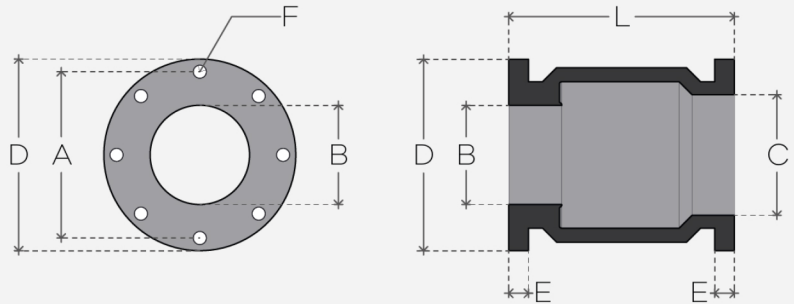

Nominal valve size inch	D inch/mm	A inch/mm	B inch/mm	C inch/mm	L inch/mm	E inch/mm	Bolt Holes Nº	ØF inch/mm	Weight lbs/kg
3"	7.5 / 191	6 / 152	3 / 75	4 / 102	10 / 255	1 / 25	4	0.7 / 18	6.0 / 2.7
4"	9 / 229	7.5 / 191	3.9 / 100	5 / 126	11 / 280	1 / 25	8	0.7 / 18	9.3 / 4.2
6"	11 / 279	9.5 / 241	5.7 / 145	6.7 / 170	14.2 / 360	1.2 / 30	8	0.9 / 22	18.3 / 8.3
8"	13.5 / 343	11.7 / 298	7.5 / 190	8.8 / 224	15.7 / 400	1.4 / 35	8	0.9 / 22	28.7 / 13
10"	16 / 406	14.3 / 362	9.3 / 236	10.2 / 260	17.3 / 440	1.5 / 38	12	1 / 25	32.4 / 14.7
12"	19 / 483	17 / 432	11 / 280	11 / 280	18.1 / 460	2 / 50	12	1 / 25	60.2 / 27.3
14"	21 / 533	18.7 / 476	10.7 / 272	11.4 / 289	20.9 / 530	2.2 / 55	12	1.1 / 29	83.8 / 38
16"	23.5 / 597	21.3 / 540	13.9 / 352	14.6 / 370	23.6 / 600	2.4 / 60	16	1.1 / 29	119.1 / 54

## COMPONENTS/MATERIALS

- HDPE body and flapper.
- 316 stainless steel mechanism, springs, bolts and washers.
- Rubber seal.

## OPERATING CONDITIONS

<b>Pressure Range (PSI)</b>	5 PSI / 150 PSI
<b>Temperature Range (°F/°C)</b>	-85°F/160°F -65°C/70°C
<b>Corrosion Resistance</b>	Supports sulphuric acid and most common corrosive fluids.

## CHARACTERISTICS

- Installation:** Fast, easy and lightweight one-man job.
- Pipe/Fitting connection:** flange connection, according to standard.
- Maintenance:** easy on-site maintenance kits available.
- Disposal:** 100% recyclable components.

## FEATURES

- Extremely low flow resistance:** when the flapper is wide open, the mechanism's force on it is at its minimum, allowing a smooth flow.
- Very low opening pressure:** flapper opens at barely 5 PSI.
- No noisy hammering:** flapper closes right before the reverse flow starts (at nearly zero flow), thus eliminating any hammering.
- Operates in any position:** works effectively horizontally, vertically or in any angle.