

INTEGRITY Fusion Products, Inc.

IntegriFuse™

**HDPE Fittings
and Equipment**

Product Catalog



www.IntegrityFusion.com



Product Catalog Table of Contents

Molded Butt Fusion	7
90 Degree Elbows	Caps
45 Degree Elbows	Flange Adapters
Tees	SDR 11 DI Backup Rings
Reducing Tees	SDR 7 DI Backup Rings
Reducers	SDR 11 316SS Backup Rings
Lateral Wyes	MJ Adapters & Kits
Electrofusion	33
Couplers	Specialy Fittings
SDR 11	90 Degree Elbow
SDR 17	45 Degree Elbow
SDR 26	Tees
SDR 7	Reducers
Branch Saddles	Flex Restraints
Tapping Tees	
Socket Fusion.....	53
90 Degree Elbows	Couplers
Tees	Caps
Reducers	Socket x Brass Transitions
Transitions Fittings	59
Supertech ID Controlled	Standard NPT
Threaded	MPT or FPT Epoxy Coated
Weld End	MPT or FPT 304 Stainless Steel
Grooved	MPT or FPT 316 Stainless Steel
IntegriFuse OD Controlled	Grooved Epoxy Coated
Threaded	
Grooved	
Poly Ball Valves	69
Equipment	73



PE3408 / PE4710 / PE100 HDPE Fittings Specifications

IntegriFuse fittings are manufactured with black high density bimodal polyethylene copolymer designed for use in, but not limited to, potable water, natural gas, industrial, landfill, oil & gas, and mining applications.

Fittings meet AWWA and ASTM-D2513 & ASTM-D3261 requirements, and are manufactured with material that is NSF Standard 14 certified, and complies with ANSI/ NSF Standard 61 health effects requirements. IntegriFuse fittings are recognized by the Plastic Pipe Institute as having a material designation code of PE 3408, PE3608, PE 4710, and PE 100.

Physical Properties	Metric	English	Comments
Density	.959 g/cm ³	0.0346 lb/in	Black: ASTM D4883
Environmental Stress Crack Resistance	>= 5000 hour	>= 5000 hour	Condition C; ASTM D1693
Carbon Black Loading	2.30%	2.30%	ASTM D1603
Melt Flow	8.00 g/10 min @Load 21.6 kg, Temperature 190 °C	8.00 g/10 min @Load 47.6 lb, Temperature 374 °F	ASTM D1238
Mechanical Properties	Metric	English	Comments
PENT	>= 10000 hour	>= 10000 hour	Notched Tensile; ASTM F1473
Hardness, Shore D	66.0	66.0	ASTM D2240
Tensile Strength at Break	37.9 MPa	5500 PSI	2 in/min; ASTM D638
Tensile Strength Yield	24.99 MPa	3625 PSI	2 in/min; ASTM D638
Elongation at Break	>= 600%	>= 600%	2 in/min; ASTM D638
Flexural Modulus	1.03 GPa	150 KSI	2% Secant-Method; ASTM D790
Izod Impact, Notched	4.81 J/cm	9.00 ft-lb/in	ASTM D256
Hydrostatic Design Basis	6.89 MPa	1000 PSI	At 60 °C; ASTM D2837
	11.0 MPa	1600 PSI	Room Temp; ASTM D2837
Thermal Properties	Metric	English	Comments
Vicat Softening Point	126 °C	259 °F	ASTM D1525
Brittleness Temperature	,= -118 °C	<= -180 °F	ASTM D746
Decomposition Temperature	>= 220 °C	>= 428 °F	Thermal Stability; ASTM D2513
Descriptive Properties	Metric	English	Comments
Cell Classification		445574C	ASTM D3350
Process		Injection Molding	



Order & Price Information

Pricing: Please contact Integrity Fusion Products, Inc, or your local authorized distributor for pricing inquiries. We welcome all inquiries via telephone, email, or fax.

Phone: 770-632-7530

Fax: 770-632-7540

E-mail: Info@IntegrityFusion.com

Ordering: Minimum Billing: \$50.00 (orders less than \$50.00 will be subject to a handling charge)

Terms: Net 30 days from date of invoice for established accounts.

Freight Charges: All orders greater than \$3,000 will be shipped freight allowed via standard ground transportation (excluding equipment, backup rings, MJ Adapter kits, fabricated & non-stock items). Air-freight or expedited shipments will incur appropriate freight charges. For orders less than \$3,000, freight will be prepaid and added to the invoice unless otherwise specified.

Order Placement: Orders are accepted by our Customer Service department via fax or email and require a written purchase order. Integrity Fusion Products, Inc sells only to approved distributors.

Availability of Product: Integrity Fusion Products Inc. has a large inventory of HDPE fittings and accessories. Items that are in stock are typically shipped within 24 hours. Non-stock or out of stock items will be processed with an estimated ship date given upon receipt of order.

Cancellations: Cancellation of items that have been ordered may be subject to cancellation charges. Some non-stock items may not be returnable.

Rental Policy: Rental charges begin the date that the unit ships and continues up to, and including, the date returned. Accrued rental costs cannot be applied to the purchase of equipment.



Return Policy

All returns must be approved by Integrity Fusion Products, Inc prior to return.

An approved, RGA (Return Goods Authorization) form must be obtained by contacting our Customer Service department. Upon approval, the RGA form, including a list of all items to be returned, conditions concerning restocking fees and/or credit information, and shipping instructions(if applicable) will be issued and sent via fax or email. A copy of the RGA form must accompany the returned shipment for proper credit to be issued.

Policies concerning returned materials:

Products stored outside will not be accepted for return.

Standard Stock Items:

A restocking fee will be charged for the return of standard stock items:

- 25% restock within 1 - 30 days
- 35% restock within 31- 180 days
- 50% restock within 181 – 365 days

Integrity Fusion will not accept returns after 365 days.

Material must be returned in a saleable condition. Items stored outside will not be accepted for return or credit.

Customer will be responsible for freight charges incurred with the return of the materials.

Non-stock or Custom Ordered Items:

Most non-stock or custom ordered items are non-cancelable/non-returnable. Any product that is not a standard stock item is subject to factory acceptance for return approval.

Freight instructions will be issued for these items on the approved RGA form obtained by our Customer Service department.



INTEGRITY Fusion Products, Inc. **Limited Warranty**

Integrity Fusion Products, Inc. warrants its materials to be free of defects in workmanship under normal use, service and when used for the purposes under the conditions for which they are intended.

This warranty shall not apply to any Integrity Fusion Products, Inc. material that has been altered, repaired and/or used in any way, stored outside, or has been subject to misuse, negligence, accident and/or has not been installed in accordance with installation instructions.

Installation of EF fittings requiring 42V-48V to fuse must be carried out using an IntegriFuse EF processor. The IntegriFuse processor is an 8-48-volt output multi-voltage fusion processor with temperature compensating feature operating at 110/120 VAC requiring power supplied through a portable power generator rated at 6500 continuous watts (minimum). If pipe is more than 1.5% out of round the use of a ReRound Clamp is recommended to ensure proper installation.

Installation instructions must be adhered to or our Limited Warranty is null and void. Installation of electrofusion fittings must be carried out by properly trained and qualified operator(s) and/or by witness of the factory representative.

The obligation of Integrity Fusion Products, Inc. under this warranty shall be limited to the replacement of any part that may prove defective under normal use.

Integrity Fusion Products, Inc. shall have the right to inspect said material and purchaser shall, if requested, return defective product prepaid to Integrity Fusion Products, Inc. Purchaser shall assume all responsibility and expenses for removal, reinstallation and freight charges in connection with the foregoing remedy.

Integrity Fusion Products, Inc. shall not be liable for indirect, special, incidental or consequential damage or penalties and does not assume any liability of purchaser to others, or to anyone for injury to persons and/or property.

Integrity Fusion Products, Inc. shall not be held liable for any delays caused by shipping any material or equipment by third party shipping companies. Integrity Fusion Products, Inc. shall not be responsible for any delays caused by shipping errors of material and/or equipment.

Any claim regarding shortage or damages from shipment of material must be submitted in writing to Integrity Fusion Products, Inc within 10 days after receipt of shipment. Buyer shall note loss or damage on shipment Bill of Lading and provide a delivery receipt stating such with driver's signature.

Purchaser is responsible for passing on this Limited Warranty to their customer.

IntegriFuse™

Molded Butt Fusion Fittings



90 Degree Elbows



45 Degree Elbows



Tees



Reducing Tees



Reducers



Wyes



Caps



Flange Adapters

Backup Rings



MJ Adapters & Kits





Molded Butt Fusion 90 Degree Elbows

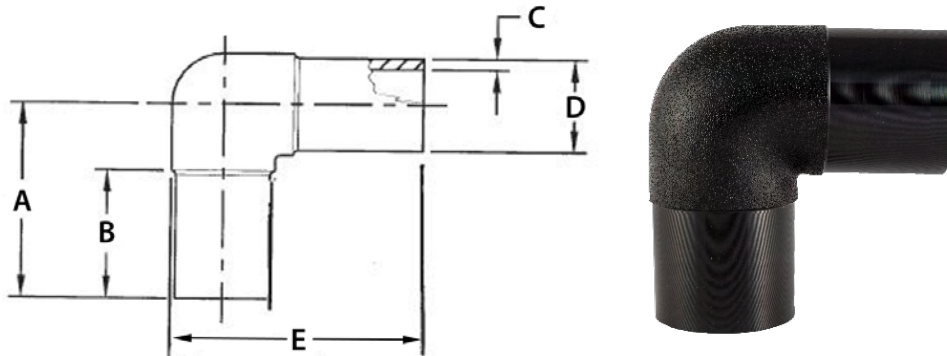

SDR 17 (Standard Dimension Ratio) 125 PSI (Working Pressure at 73.4° F)							
Nominal IPS Pipe Size	A inches	B inches	C inches	D inches	E inches	Weight lbs.	Item Code
2"	4.25	2.95	0.14	2.38	5.44	0.28	90BI-2IPS-17
3"	5.91	4.06	0.21	3.50	7.66	0.80	90BI-3IPS-17
4"	6.89	4.53	0.26	4.50	9.14	1.64	90BI-4IPS-17
6"	9.06	5.63	0.39	6.63	12.37	4.80	90BI-6IPS-17
8"	11.81	7.20	0.51	8.63	16.13	10.05	90BI-8IPS-17
10"	13.78	8.27	0.63	10.75	19.15	18.33	90BI-10IPS-17
12"	14.96	8.46	0.75	12.75	21.33	27.47	90BI-12IPS-17
SDR 11 (Standard Dimension Ratio) 200 PSI (Working Pressure at 73.4° F)							
Nominal IPS Pipe Size	A inches	B inches	C inches	D inches	E inches	Weight lbs.	Item Code
¾"	3.19	2.14	0.10	1.05	3.82	0.10	90BI-0075I-11
1"	3.31	2.18	0.12	1.32	4.06	0.15	90BI-010I-11
1 ¼"	3.48	2.15	0.15	1.66	4.41	0.25	90BI-0125I-11
1 ½"	3.92	2.37	0.17	1.90	5.00	0.38	90BI-0150I-11
2"	4.25	2.95	0.22	2.38	5.44	0.43	90BI-2IPS-11
3"	5.91	4.06	0.32	3.50	7.66	1.25	90BI-3IPS-11
4"	6.89	4.53	0.41	4.50	9.14	2.42	90BI-4IPS-11
6"	9.06	5.63	0.60	6.63	12.37	6.76	90BI-6IPS-11
8"	11.81	7.20	0.79	8.63	16.13	15.08	90BI-8IPS-11
10"	13.78	8.27	0.98	10.75	19.15	27.06	90BI-10IPS-11
12"	14.96	8.46	1.16	12.75	21.33	41.05	90BI-12IPS-11





Molded Butt Fusion 90 Degree Elbows

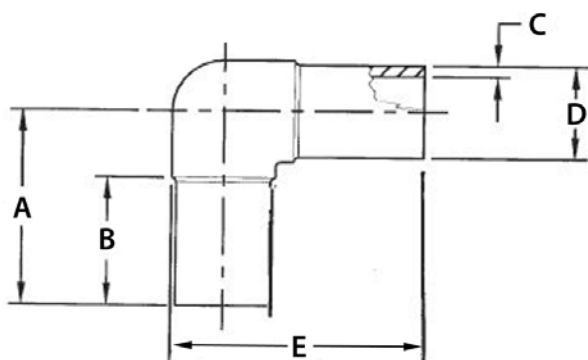

SDR 9 (Standard Dimension Ratio) 255 PSI (Working Pressure at 73.4° F)							
Nominal IPS Pipe Size	A inches	B inches	C inches	D inches	E inches	Weight lbs.	Item Code
2"	4.25	2.95	0.26	2.38	5.44	1.00	90BI-2IPS-9
3"	5.91	4.06	0.39	3.50	7.66	2.00	90BI-3IPS-9
4"	6.89	4.53	0.50	4.50	9.14	3.00	90BI-4IPS-9
6"	9.06	5.63	0.74	6.63	12.37	9.00	90BI-6IPS-9
8"	11.81	7.20	0.96	8.63	16.13	22.00	90BI-8IPS-9
SDR 7 (Standard Dimension Ratio) 335 PSI (Working Pressure at 73.4° F)							
Nominal IPS Pipe Size	A inches	B inches	C inches	D inches	E inches	Weight lbs.	Item Code
2"	4.25	2.95	0.34	2.38	5.44	1.50	90BI-2IPS-7
3"	5.91	4.06	0.50	3.50	7.66	3.00	90BI-3IPS-7
4"	6.89	4.53	0.64	4.50	9.14	5.00	90BI-4IPS-7
6"	9.06	5.63	0.95	6.63	12.37	12.00	90BI-6IPS-7
8"	11.81	7.20	1.23	8.63	16.13	25.00	90BI-8IPS-7





Molded Butt Fusion 45 Degree Elbows

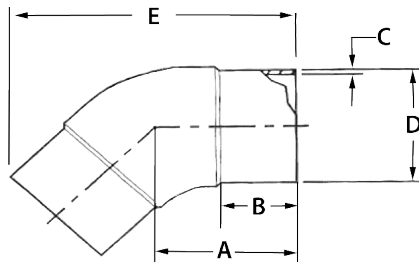

SDR 17 (Standard Dimension Ratio) 125 PSI (Working Pressure at 73.4° F)

Nominal IPS Pipe Size	A inches	B inches	C inches	D inches	E inches	Weight lbs.	Item Code
2"	3.23	2.64	0.14	2.38	6.38	0.23	45BI-2IPS-17
3"	4.72	3.86	0.21	3.50	9.33	0.72	45BI-3IPS-17
4"	5.31	4.21	0.26	4.50	10.63	1.32	45BI-4IPS-17
6"	6.89	5.35	0.39	6.63	14.09	3.77	45BI-6IPS-17
8"	8.46	6.54	0.51	8.63	17.48	8.03	45BI-8IPS-17
10"	10.04	7.64	0.63	10.75	20.94	14.44	45BI-10IPS-17
12"	10.63	7.80	0.75	12.75	22.64	21.30	45BI-12IPS-17

SDR 11 (Standard Dimension Ratio) 200 PSI (Working Pressure at 73.4° F)

Nominal IPS Pipe Size	A inches	B inches	C inches	D inches	E inches	Weight lbs.	Item Code
2"	3.23	2.64	0.22	2.38	6.38	0.35	45BI-2IPS-11
3"	4.72	3.86	0.32	3.50	9.33	1.07	45BI-3IPS-11
4"	5.31	4.21	0.41	4.50	10.63	2.00	45BI-4IPS-11
6"	6.89	5.35	0.60	6.63	14.09	5.55	45BI-6IPS-11
8"	8.46	6.54	0.79	8.63	17.48	11.64	45BI-8IPS-11
10"	10.04	7.64	0.98	10.75	20.94	21.30	45BI-10IPS-11
12"	10.63	7.80	1.16	12.75	22.64	31.84	45BI-12IPS-11





Molded Butt Fusion 45 Degree Elbows

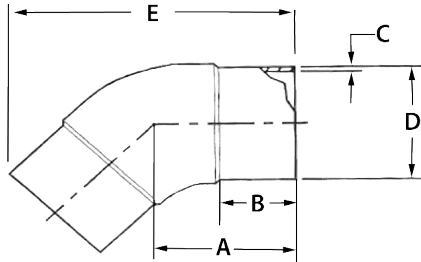

SDR 9 (Standard Dimension Ratio) 255 PSI (Working Pressure at 73.4° F)							
Nominal IPS Pipe Size	A inches	B inches	C inches	D inches	E inches	Weight lbs.	Item Code
2"	3.23	2.64	0.26	2.38	6.38	1.00	45BI-2IPS-9
3"	4.72	3.86	0.39	3.50	9.33	2.00	45BI-3IPS-9
4"	5.31	4.21	0.50	4.50	10.63	3.00	45BI-4IPS-9
6"	6.89	5.35	0.74	6.63	14.09	9.00	45BI-6IPS-9
8"	8.46	6.54	0.96	8.63	17.48	22.00	45BI-8IPS-9
SDR 7 (Standard Dimension Ratio) 335 PSI (Working Pressure at 73.4° F)							
Nominal IPS Pipe Size	A inches	B inches	C inches	D inches	E inches	Weight lbs.	Item Code
2"	3.23	2.64	0.34	2.38	6.38	1.50	45BI-2IPS-7
3"	4.72	3.86	0.50	3.50	9.33	3.00	45BI-3IPS-7
4"	5.31	4.21	0.64	4.50	10.63	5.00	45BI-4IPS-7
6"	6.89	5.35	0.95	6.63	14.09	12.00	45BI-6IPS-7
8"	8.46	6.54	1.23	8.63	17.48	25.00	45BI-8IPS-7





Molded Butt Fusion Tees

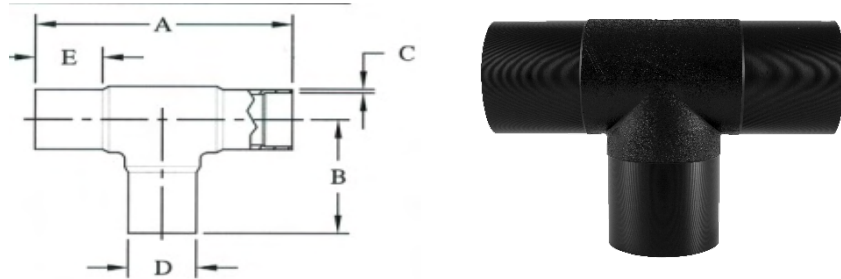

SDR 17 (Standard Dimension Ratio) 125 PSI (Working Pressure at 73.4° F)							
Nominal IPS Pipe Size	A inches	B inches	C inches	D inches	E inches	Weight lbs.	Item Code
3"	11.81	5.91	0.21	3.50	3.54	1.45	TEEBI-3IPS-17
4"	13.78	6.89	0.26	4.50	3.94	2.58	TEEBI-4IPS-17
6"	18.11	9.06	0.39	6.63	4.72	7.24	TEEBI-6IPS-17
8"	23.62	11.81	0.51	8.63	5.71	16.60	TEEBI-8IPS-17
10"	27.56	13.78	0.63	10.75	6.30	28.90	TEEBI-10IPS-17
12"	31.57	15.97	0.75	12.75	7.52	45.32	TEEBI-12IPS-17
SDR 11 (Standard Dimension Ratio) 200 PSI (Working Pressure at 73.4° F)							
Nominal IPS Pipe Size	A inches	B inches	C inches	D inches	E inches	Weight lbs.	Item Code
¾"	6.38	3.19	0.10	1.05	2.14	0.13	TEEBI-0075I-11
1"	6.62	3.31	0.12	1.32	2.18	0.25	TEEBI-010I-11
1 ¼"	6.97	3.48	0.15	1.66	2.15	0.35	TEEBI-0125I-11
1 ½"	7.84	3.92	0.17	1.90	2.37	0.50	TEEBI-0150I-11
2"	8.66	4.33	0.22	2.38	2.48	0.82	TEEBI-02IPS-11
3"	11.81	5.91	0.32	3.50	3.54	2.18	TEEBI-03IPS-11
4"	13.78	6.89	0.41	4.50	3.94	4.02	TEEBI-04IPS-11
6"	18.11	9.06	0.60	6.63	4.72	10.91	TEEBI-06IPS-11
8"	23.62	11.81	0.79	8.63	5.71	24.61	TEEBI-08IPS-11
10"	27.56	13.78	0.98	10.75	6.30	42.60	TEEBI-10IPS-11
12"	31.57	15.97	1.16	12.75	7.52	67.85	TEEBI-12IPS-11





Molded Butt Fusion Tees

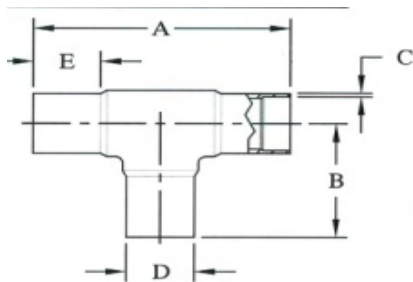

SDR 9 (Standard Dimension Ratio) 255 PSI (Working Pressure at 73.4° F)							
Nominal IPS Pipe Size	A inches	B inches	C inches	D inches	E inches	Weight lbs.	Item Code
2"	8.66	4.33	0.14	2.38	2.47	0.53	TEEBI-02IPS-9
3"	11.81	5.91	0.21	3.50	3.54	1.45	TEEBI-03IPS-9
4"	13.78	6.89	0.26	4.50	3.94	2.58	TEEBI-04IPS-9
6"	18.11	9.06	0.39	6.63	4.72	7.24	TEEBI-06IPS-9
8"	23.62	11.81	0.51	8.63	5.71	16.60	TEEBI-08IPS-9
SDR 7 (Standard Dimension Ratio) 335 PSI (Working Pressure at 73.4° F)							
Nominal IPS Pipe Size	A inches	B inches	C inches	D inches	E inches	Weight lbs.	Item Code
2"	8.66	4.33	0.14	2.38	2.47	0.53	TEEBI-02IPS-7
3"	11.81	5.91	0.21	3.50	3.54	1.45	TEEBI-03IPS-7
4"	13.78	6.89	0.26	4.50	3.94	2.58	TEEBI-04IPS-7
6"	18.11	9.06	0.39	6.63	4.72	7.24	TEEBI-06IPS-7
8"	23.62	11.81	0.51	8.63	5.71	16.60	TEEBI-08IPS-7





Molded Butt Fusion Reducing Tees

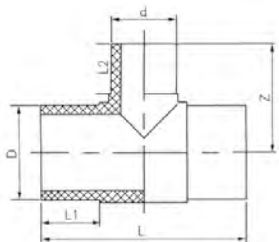

SDR 17 (Standard Dimension Ratio) 125 PSI (Working Pressure at 73.4° F)								
Nominal IPS Pipe Size	L inches	D inches	d inches	L1 inches	L2 inches	Z inches	Weight	Item Code
3" x 2"	11.80	3.50	2.38	3.62	2.48	5.90	1.69	TRED-3x2IPS-17
4" x 2"	13.78	4.50	2.38	3.94	2.48	6.89	2.94	TRED-4x2IPS-17
4" x 3"	13.78	4.50	3.50	3.94	3.62	6.89	3.16	TRED-4x3IPS-17
6" x 2"	18.10	6.63	2.38	4.72	2.48	9.06	7.32	TRED-6x2IPS-17
6" x 3"	18.10	6.63	3.50	4.72	3.62	9.06	7.72	TRED-6x3IPS-17
6" x 4"	18.10	6.63	4.50	4.72	3.94	9.06	8.11	TRED-6x4IPS-17
8" x 2"	23.60	8.63	2.38	5.71	2.48	11.80	16.75	TRED-8x2IPS-17
8" x 3"	23.60	8.63	3.50	5.71	3.62	11.80	17.26	TRED-8x3IPS-17
8" x 4"	23.60	8.63	4.50	5.71	3.94	11.80	17.89	TRED-8x4IPS-17
8" x 6"	23.60	8.63	6.63	5.71	4.72	11.80	18.85	TRED-8x6IPS-17
10" x 4"	27.40	10.75	4.50	6.30	3.94	13.78	31.98	TRED-10x4IPS-17
10" x 6"	27.40	10.75	6.63	6.30	4.72	13.78	33.09	TRED-10x6IPS-17
10" x 8"	27.40	10.75	8.63	6.30	5.71	13.78	34.63	TRED-10x8IPS-17
12" x 6"	31.40	12.75	6.63	7.48	4.72	15.95	47.12	TRED-12x6IPS-17
12" x 8"	31.40	12.75	8.63	7.48	5.71	15.95	48.88	TRED-12x8IPS-17
12" x 10"	31.40	12.75	10.75	7.48	6.30	15.95	53.05	TRED-12x10IPS-17





Molded Butt Fusion Reducing Tees

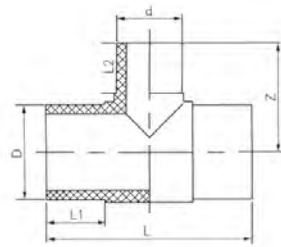

SDR 11 (Standard Dimension Ratio) 200 PSI (Working Pressure at 73.4° F)

Nominal IPS Pipe Size	L inches	D inches	d inches	L1 inches	L2 inches	Z inches	Weight	Item Code
3" x 2"	11.80	3.50	2.38	3.62	2.48	5.90	2.19	TRED-3x2IPS-11
4" x 2"	13.78	4.50	2.38	3.94	2.48	6.89	3.91	TRED-4x2IPS-11
4" x 3"	13.78	4.50	3.50	3.94	3.62	6.89	4.12	TRED-4x3IPS-11
6" x 2"	18.10	6.63	2.38	4.72	2.48	9.06	10.30	TRED-6x2IPS-11
6" x 3"	18.10	6.63	3.50	4.72	3.62	9.06	10.98	TRED-6x3IPS-11
6" x 4"	18.10	6.63	4.50	4.72	3.94	9.06	11.53	TRED-6x4IPS-11
8" x 2"	23.60	8.63	2.38	5.71	2.48	11.80	21.26	TRED-8x2IPS-11
8" x 3"	23.60	8.63	3.50	5.71	3.62	11.80	22.18	TRED-8x3IPS-11
8" x 4"	23.60	8.63	4.50	5.71	3.94	11.80	23.25	TRED-8x4IPS-11
8" x 6"	23.60	8.63	6.63	5.71	4.72	11.80	24.35	TRED-8x6IPS-11
10" x 4"	27.40	10.75	4.50	6.30	3.94	13.78	42.38	TRED-10x4IPS-11
10" x 6"	27.40	10.75	6.63	6.30	4.72	13.78	43.59	TRED-10x6IPS-11
10" x 8"	27.40	10.75	8.63	6.30	5.71	13.78	45.96	TRED-10x8IPS-11
12" x 6"	31.40	12.75	6.63	7.48	4.72	15.95	63.35	TRED-12x6IPS-11
12" x 8"	31.40	12.75	8.63	7.48	5.71	15.95	66.86	TRED-12x8IPS-11
12" x 10"	31.40	12.75	10.75	7.48	6.30	15.95	68.52	TRED-12x10IPS-11





Molded Butt Fusion Wyes

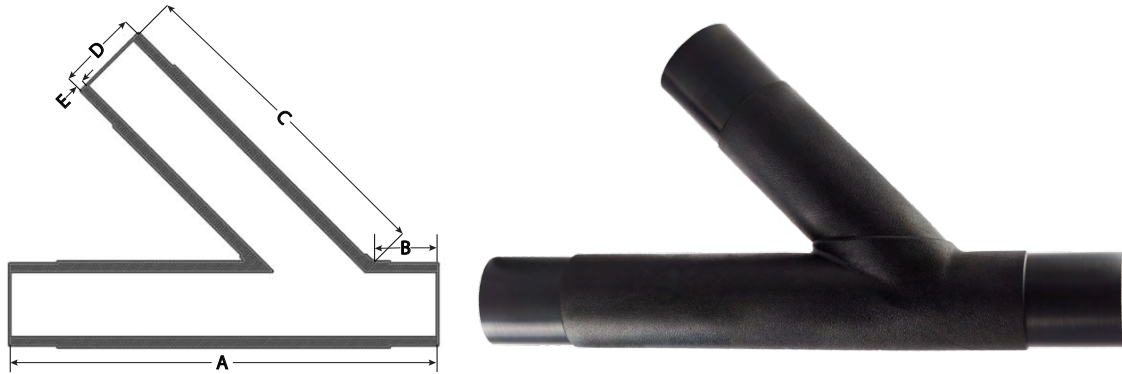

SDR 17 (Standard Dimension Ratio) 125 PSI (Working Pressure at 73.4° F)							
Nominal IPS Pipe Size	A inches	B inches	C inches	D inches	E inches	Weight	Item Code
2"	23.74	5.28	13.10	2.38	0.14	2.0	WYEBI-020I-17
3"	24.56	5.90	13.10	3.50	0.21	4.2	WYEBI-030I-17
4"	28.50	5.70	20.60	4.50	0.26	7.9	WYEBI-040I-17
6"	34.65	5.30	26.00	6.63	0.39	26.3	WYEBI-060I-17
8"	37.40	5.70	27.56	8.63	0.51	44.9	WYEBI-080I-17





Molded Butt Fusion Wyes

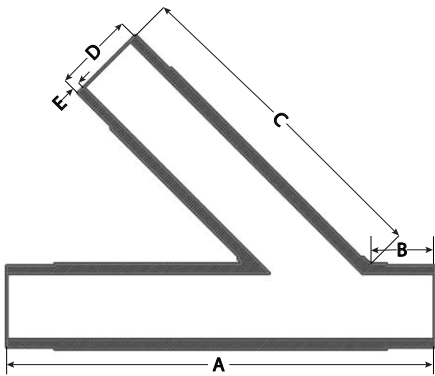

SDR 11 (Standard Dimension Ratio) 200 PSI (Working Pressure at 73.4° F)							
Nominal IPS Pipe Size	A inches	B inches	C inches	D inches	E inches	Weight	Item Code
2"	23.74	5.28	13.10	2.38	0.22	2.6	WYEBI-020I-11
3"	24.56	5.90	13.10	3.50	0.32	5.3	WYEBI-030I-11
4"	28.50	5.70	20.60	4.50	0.41	10.6	WYEBI-040I-11
6"	34.45	5.52	26.00	6.63	0.60	32.0	WYEBI-060I-11
8"	37.40	5.70	27.56	8.63	0.79	54.8	WYEBI-080I-11





Molded Butt Fusion Reducers

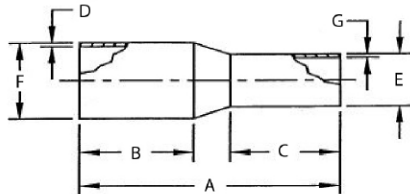

SDR 17 (Standard Dimension Ratio) 125 PSI (Working Pressure at 73.4° F)

Nominal IPS Pipe Size	A inches	B inches	C inches	D (wall) inches	E (OD) inches	F (OD) inches	G (wall) inches	Weight lbs.	Item Code
3" x 2"	7.87	3.94	2.95	0.21	2.38	3.50	0.14	0.47	REDBI-3X2IPS-17
4" x 2"	9.06	4.33	2.95	0.26	2.38	4.50	0.14	0.80	REDBI-4X2IPS-17
4" x 3"	9.06	4.33	3.94	0.26	3.50	4.50	0.21	0.94	REDBI-4X3IPS-17
6" x 3"	11.03	5.06	3.71	0.39	3.50	6.63	0.21	2.13	REDBI-6X3IPS-17
6" x 4"	11.42	5.12	4.33	0.39	4.50	6.63	0.26	2.39	REDBI-6X4IPS-17
8" x 4"	12.80	5.99	4.05	0.51	4.50	8.63	0.26	4.23	REDBI-8X4IPS-17
8" x 6"	12.80	6.10	5.12	0.51	6.63	8.63	0.39	4.92	REDBI-8X6IPS-17
10" x 6"	14.06	6.16	5.29	0.75	6.63	10.75	0.39	7.73	REDBI-10X6IPS-17
10" x 8"	14.37	6.25	5.81	0.75	8.63	10.75	0.51	10.21	REDBI-10X8IPS-17
12" x 6"	16.00	6.95	5.22	0.75	6.63	12.75	0.39	11.32	REDBI-12X6IPS-17
12" x 8"	16.54	7.09	6.10	0.75	8.63	12.75	0.51	12.82	REDBI-12X8IPS-17
12" x 10"	16.54	7.09	6.69	0.75	10.75	12.75	0.63	14.43	REDBI-12X10IPS-17





Molded Butt Fusion Reducers

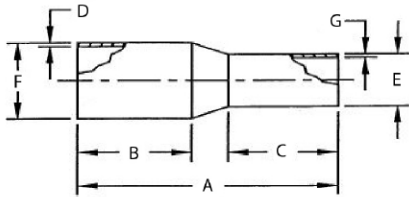

SDR 11 (Standard Dimension Ratio) 200 PSI (Working Pressure at 73.4° F)

Nominal IPS Pipe Size	A inches	B inches	C inches	D (wall) inches	E (OD) inches	F (OD) inches	G (wall) inches	Weight lbs.	Item Code
1" x ¾"	4.58	2.17	2.17	0.12	1.05	1.32	0.10	0.08	REDBI-010I-075I-11
1 ¼" x 1"	4.66	2.20	2.15	0.15	1.32	1.66	0.12	0.11	REDBI-0125I-010I-11
1 ½" x 1"	5.12	2.44	2.16	0.17	1.32	1.90	0.12	0.15	REDBI-0150I-010I-11
1 ½" x 1 ¼"	4.83	2.44	2.17	0.17	1.66	1.90	0.15	0.16	REDBI-0150I-0125I-11
2" x 1"	5.62	2.53	2.13	0.22	1.32	2.38	0.12	0.23	REDBI-020I-010I-11
2" x 1 ¼"	5.34	2.53	2.15	0.22	1.66	2.38	0.12	0.25	REDBI-020I-0125I-11
2" x 1 ½"	5.40	2.53	2.42	0.22	1.90	2.38	0.15	0.26	REDBI-020I-0150I-11
3" x 2"	7.87	3.94	2.95	0.32	2.38	3.50	0.22	0.70	REDBI-3X2IPS-11
4" x 2"	9.06	4.33	2.95	0.41	2.38	4.50	0.22	1.21	REDBI-4X2IPS-11
4" x 3"	9.06	4.33	3.94	0.41	3.50	4.50	0.32	1.41	REDBI-4X3IPS-11
6" x 3"	11.03	5.06	3.71	0.60	3.50	6.63	0.32	3.18	REDBI-6X3IPS-11
6" x 4"	11.42	5.12	4.33	0.60	4.50	6.63	0.41	3.54	REDBI-6X4IPS-11
8" x 4"	12.80	5.99	4.05	0.79	4.50	8.63	0.41	6.31	REDBI-8X6IPS-11
8" x 6"	12.80	6.10	5.12	0.79	6.63	8.63	0.60	7.31	REDBI-8X6IPS-11
10" x 6"	14.06	6.16	5.29	1.16	6.63	10.75	0.60	10.28	REDBI-8X4IPS-11
10" x 8"	14.37	6.25	5.88	1.16	8.63	10.75	0.79	14.45	REDBI-10X6IPS-11
12" x 6"	16.00	6.95	5.22	1.16	6.63	12.75	0.60	16.64	REDBI-10X8IPS-11
12" x 8"	16.54	7.09	6.10	1.16	8.63	12.75	0.79	19.11	REDBI-12X6IPS-11
12" x 10"	16.54	7.09	6.69	1.16	10.75	12.75	0.98	21.66	REDBI-12X8IPS-11





Molded Butt Fusion Reducers

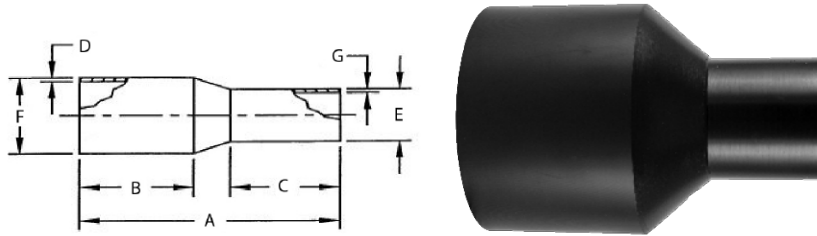

SDR 9 (Standard Dimension Ratio) 255 PSI (Working Pressure at 73.4° F)									
Nominal IPS Pipe Size	A inches	B inches	C inches	D (wall) inches	E (OD) inches	F (OD) inches	G (wall) inches	Weight lbs.	Item Code
3" x 2"	7.87	3.94	2.95	0.32	2.38	3.50	0.22	0.70	REDBI-3X2IPS-9
4" x 2"	9.06	4.33	2.95	0.41	2.38	4.50	0.22	1.21	REDBI-4X2IPS-9
4" x 3"	9.06	4.33	3.94	0.41	3.50	4.50	0.32	1.41	REDBI-4X3IPS-9
6" x 4"	11.42	5.12	4.33	0.60	4.50	6.63	0.41	3.54	REDBI-6X4IPS-9
8" x 6"	12.80	6.10	5.12	0.79	6.63	8.63	0.60	7.31	REDBI-8X6IPS-9
SDR 7 (Standard Dimension Ratio) 335 PSI (Working Pressure at 73.4° F)									
Nominal IPS Pipe Size	A inches	B inches	C inches	D (wall) inches	E (OD) inches	F (OD) inches	G (wall) inches	Weight lbs.	Item Code
3" x 2"	7.87	3.94	2.95	0.32	2.38	3.50	0.22	0.70	REDBI-3X2IPS-7
4" x 2"	9.06	4.33	2.95	0.41	2.38	4.50	0.22	1.21	REDBI-4X2IPS-7
4" x 3"	9.06	4.33	3.94	0.41	3.50	4.50	0.32	1.41	REDBI-4X3IPS-7
6" x 4"	11.42	5.12	4.33	0.60	4.50	6.63	0.41	3.54	REDBI-6X4IPS-7
8" x 6"	12.80	6.10	5.12	0.79	6.63	8.63	0.60	7.31	REDBI-8X6IPS-7





Molded Butt Fusion Caps

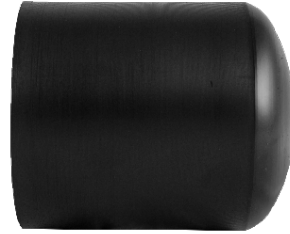
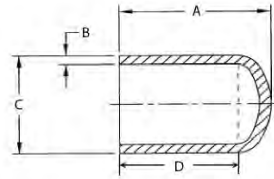

SDR 17 (Standard Dimension Ratio) 125 PSI (Working Pressure at 73.4° F)						
Nominal IPS Pipe Size	A inches	B inches	C inches	D inches	Weight lbs.	Item Code
2"	3.23	0.14	2.38	2.52	0.12	CAPBI-2IPS-17
3"	4.72	0.21	3.50	3.70	0.39	CAPBI-3IPS-17
4"	5.31	0.26	4.50	3.98	0.71	CAPBI-4IPS-17
6"	6.89	0.39	6.63	4.84	1.98	CAPBI-6IPS-17
8"	8.66	0.51	8.63	5.83	4.23	CAPBI-8IPS-17
SDR 11 (Standard Dimension Ratio) 200 PSI (Working Pressure at 73.4° F)						
Nominal IPS Pipe Size	A inches	B inches	C inches	D inches	Weight lbs.	Item Code
¾"	2.55	0.10	1.05	2.18	0.04	CAPBI-0075I-11
1"	2.64	0.12	1.32	2.18	0.05	CAPBI-010I-11
1 ¼"	2.77	0.15	1.66	2.18	0.08	CAPBI-0125I-11
1 ½"	3.10	0.17	1.90	2.42	0.74	CAPBI-0150I-11
2"	3.23	0.22	2.38	2.52	0.19	CAPBI-2IPS-11
3"	4.72	0.32	3.50	3.70	0.59	CAPBI-3IPS-11
4"	5.31	0.41	4.50	3.98	1.07	CAPBI-4IPS-11
6"	6.89	0.60	6.63	4.84	2.88	CAPBI-6IPS-11
8"	8.66	0.79	8.63	5.83	6.32	CAPBI-8IPS-11





Molded Butt Fusion Caps

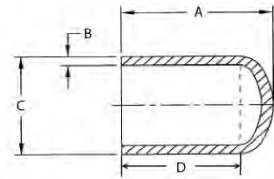

SDR 9 (Standard Dimension Ratio) 255 PSI (Working Pressure at 73.4° F)

Nominal IPS Pipe Size	A inches	B inches	C inches	D inches	Weight lbs.	Item Code
2"	3.230	0.26	2.375	2.520	0.26	CAPBI-2IPS-9
3"	4.720	0.39	3.500	3.700	0.81	CAPBI-3IPS-9
4"	5.310	0.50	4.500	3.980	2.37	CAPBI-4IPS-9
6"	6.890	0.74	6.625	4.840	2.79	CAPBI-6IPS-9
8"	8.660	0.96	8.625	5.830	5.60	CAPBI-8IPS-9

SDR 7 (Standard Dimension Ratio) 335 PSI (Working Pressure at 73.4° F)

Nominal IPS Pipe Size	A inches	B inches	C inches	D inches	Weight lbs.	Item Code
2"	3.230	0.34	2.375	2.520	0.32	CAPBI-2IPS-7
3"	4.720	0.50	3.500	3.700	1.00	CAPBI-3IPS-7
4"	5.310	0.64	4.500	3.980	2.37	CAPBI-4IPS-7
6"	6.890	0.95	6.625	4.840	2.79	CAPBI-6IPS-7
8"	8.660	1.23	8.625	5.830	5.60	CAPBI-8IPS-7





Molded Butt Fusion Flange Adapters

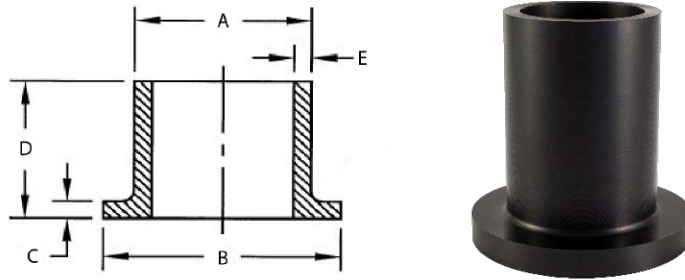

SDR 17 (Standard Dimension Ratio) 125 PSI (Working Pressure at 73.4° F)							
Nominal IPS Pipe Size	A (OD) inches	B inches	C inches	D (length) inches	E (wall) inches	Weight lbs.	Item Code
2"	2.38	3.94	0.55	6.10	0.14	0.37	FAI-2IPS-17
3"	3.50	5.00	0.67	6.10	0.21	0.71	FAI-3IPS-17
4"	4.50	6.61	0.79	6.10	0.26	1.27	FAI-4IPS-17
6"	6.63	8.50	1.02	8.07	0.39	3.02	FAI-6IPS-17
8"	8.63	10.63	1.02	10.67	0.51	6.02	FAI-8IPS-17
10"	10.75	12.99	1.18	11.50	0.63	10.06	FAI-10IPS-17
12"	12.75	15.75	1.38	10.83	0.75	14.17	FAI-12IPS-17
14"	14.00	17.50	1.62	12.00	0.82	26.00	FAI-14IPS-17
16"	16.00	20.00	1.85	12.00	0.94	37.00	FAI-16IPS-17
18"	18.00	21.12	2.08	12.00	1.06	43.00	FAI-18IPS-17
20"	20.00	23.50	2.31	12.00	1.18	56.00	FAI-20IPS-17
24"	24.00	28.00	2.77	14.00	1.41	79.00	FAI-24IPS-17
28"	28.00	32.30	3.23	14.00	1.65	84.00	FAI-28IPS-17
30"	30.00	34.30	3.46	14.00	1.77	87.00	FAI-30IPS-17
32"	32.00	34.30	3.69	14.00	1.88	106.00	FAI-32IPS-17
36"	36.00	40.80	4.16	14.00	2.12	141.00	FAI-36IPS-17

Beveled Flanges available upon request.
Standard 45° bevel unless otherwise requested.





Molded Butt Fusion Flange Adapters

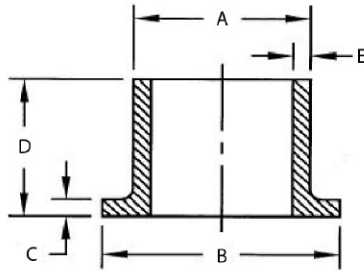

SDR 11 (Standard Dimension Ratio) 200 PSI (Working Pressure at 73.4° F)							
Nominal IPS Pipe Size	A (OD) inches	B inches	C inches	D (length) inches	E (wall) inches	Weight lbs.	Item Code
2"	2.38	3.94	0.55	6.10	0.22	0.48	FAI-2IPS-11
3"	3.50	5.00	0.67	6.10	0.32	0.93	FAI-3IPS-11
4"	4.50	6.61	0.79	6.10	0.41	1.66	FAI-4IPS-11
6"	6.63	8.50	1.02	8.07	0.60	4.07	FAI-6IPS-11
8"	8.63	10.63	1.02	10.67	0.79	8.73	FAI-8IPS-11
10"	10.75	12.99	1.18	11.50	0.98	14.11	FAI-10IPS-11
12"	12.75	15.75	1.38	10.83	1.16	19.88	FAI-12IPS-11
14"	14.00	17.50	1.62	12.00	1.27	26.00	FAI-14IPS-11
16"	16.00	20.00	1.85	12.00	1.45	37.00	FAI-16IPS-11
18"	18.00	21.12	2.08	12.00	1.64	43.00	FAI-18IPS-11
20"	20.00	23.50	2.31	12.00	1.82	56.00	FAI-20IPS-11
24"	24.00	28.00	2.77	14.00	2.18	94.00	FAI-24IPS-11
28"	28.00	32.30	3.23	14.00	2.55	129.00	FAI-28IPS-11
30"	30.00	34.30	3.46	14.00	2.73	134.00	FAI-30IPS-11
32"	32.00	34.30	3.69	14.00	2.91	163.00	FAI-32IPS-11
36"	36.00	40.80	4.16	14.00	3.27	218.00	FAI-36IPS-11

Beveled Flanges available upon request.
Standard 45° bevel unless otherwise requested.





Molded Butt Fusion Flange Adapters

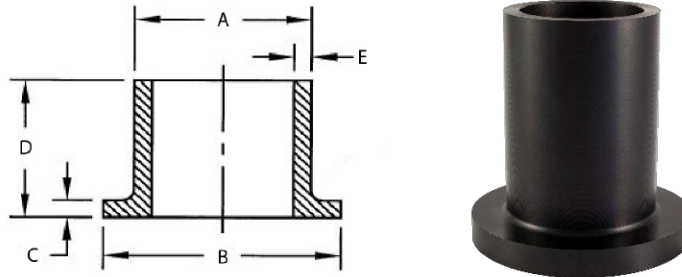

SDR 9 (Standard Dimension Ratio) 255 PSI (Working Pressure at 73.4° F)							
Nominal IPS Pipe Size	A (OD) inches	B inches	C inches	D (length) inches	E (wall) inches	Weight lbs.	Item Code
2"	2.38	3.94	0.55	6.10	0.26	1.00	FAI-2IPS-9
3"	3.50	5.00	0.67	6.10	0.39	2.00	FAI-3IPS-9
4"	4.50	6.61	0.79	6.10	0.50	3.00	FAI-4IPS-9
6"	6.63	8.50	1.02	8.07	0.74	7.00	FAI-6IPS-9
8"	8.63	10.63	1.02	10.67	0.96	10.00	FAI-8IPS-9
10"	10.75	12.99	1.18	11.50	1.19	19.00	FAI-10IPS-9
12"	12.75	15.75	1.38	10.83	1.42	25.00	FAI-12IPS-9
SDR 7 (Standard Dimension Ratio) 335 PSI (Working Pressure at 73.4° F)							
Nominal IPS Pipe Size	A (OD) inches	B inches	C inches	D (length) inches	E (wall) inches	Weight lbs.	Item Code
2"	2.38	3.94	0.55	6.10	0.34	2.00	FAI-2IPS-7
3"	3.50	5.00	0.67	6.10	0.50	3.00	FAI-3IPS-7
4"	4.50	6.61	0.79	6.10	0.64	4.00	FAI-4IPS-7
6"	6.63	8.50	1.02	8.07	0.95	8.00	FAI-6IPS-7
8"	8.63	10.63	1.02	10.67	1.23	12.00	FAI-8IPS-7

Beveled Flanges available upon request.
Standard 45° bevel unless otherwise requested.





SDR 11 Epoxy Coated Backup Rings

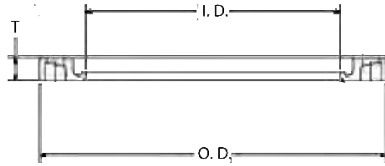

SDR 11 (Standard Dimension Ratio) 200 PSI							
Nominal IPS Pipe Size	Pressure Class	OD inches	ID inches	Bolt Holes	Thickness Inches	Weight lbs.	Item Code
2"	SDR 11	6.00	2.46	4	0.55	1.8	BUR-2IPSDI-11
3"	SDR 11	7.50	3.60	4	0.55	2.7	BUR-3IPSDI-11
4"	SDR 11	9.00	4.60	8	0.60	3.8	BUR-4IPSDI-11
6"	SDR 11	11.00	6.75	8	0.65	5.2	BUR-6IPSDI-11
8"	SDR 11	13.50	8.75	8	0.80	10.0	BUR-8IPSDI-11
10"	SDR 11	16.00	10.92	12	1.01	14.0	BUR-10IPSDI-11
12"	SDR 11	19.00	12.92	12	1.26	23.0	BUR-12IPSDI-11
14"	SDR 11	21.00	14.18	12	1.40	36.0	BUR-14IPSDI-11
16"	SDR 11	23.50	16.19	16	1.66	43.0	BUR-16IPSDI-11
18"	SDR 11	25.00	18.20	16	1.70	49.0	BUR-18IPSDI-11
20"	SDR 11	27.50	20.38	20	1.98	60.0	BUR-20IPSDI-11
24"	SDR 11	32.00	24.38	20	2.30	88.0	BUR-24IPSDI-11
28"	SDR 11	36.50	28.38	28	2.11	118.0	BUR-28IPSDI-11
28"	100 PSI	36.50	28.38	28	1.73	100.0	BUR-28IPSDI-100
30"	SDR 11	38.75	30.50	28	2.60	145.0	BUR-30IPSDI-11
32"	SDR 11	41.75	32.50	28	2.75	175.0	BUR-32IPSDI-11
36"	SDR 11	46.00	36.50	32	3.10	235.0	BUR-36IPSDI-11





SDR 7 - SDR 9 Epoxy Coated Backup Rings

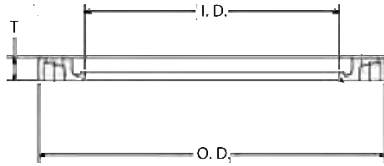

SDR 7 (Standard Dimension Ratio) 335 PSI SDR 9 (Standard Dimension Ratio) 255 PSI							
Nominal IPS Pipe Size	Pressure Class	OD inches	ID inches	Bolt Holes	Thickness Inches	Weight lbs.	Item Code
2"	SDR 7	6.00	2.46	4	0.70	2.5	BUR-2IPSDI-7
3"	SDR 7	7.50	3.60	4	0.82	4.5	BUR-3IPSDI-7
4"	SDR 7	9.00	4.60	8	0.82	6.0	BUR-4IPSDI-7
6"	SDR 7	11.00	6.75	8	0.85	8.3	BUR-6IPSDI-7
8"	SDR 7	13.50	8.75	8	0.93	12.5	BUR-8IPSDI-7
10"	SDR 7	16.00	10.92	12	0.97	16.2	BUR-10IPSDI-7
12"	SDR 7	19.00	12.92	12	1.02	22.7	BUR-12IPSDI-7
14"	SDR 7	21.00	14.18	12	1.35	44.0	BUR-14IPSDI-7
16"	SDR 7	23.50	16.19	16	1.40	54.0	BUR-16IPSDI-7
18"	SDR 7	25.00	18.20	16	1.53	50.0	BUR-18IPSDI-7
20"	SDR 9	27.50	20.38	20	1.83	70.0	BUR-20IPSDI-9
24"	SDR 9	32.00	24.38	20	1.71	90.0	BUR-24IPSDI-9





SDR 11 316 Stainless Steel Backup Rings

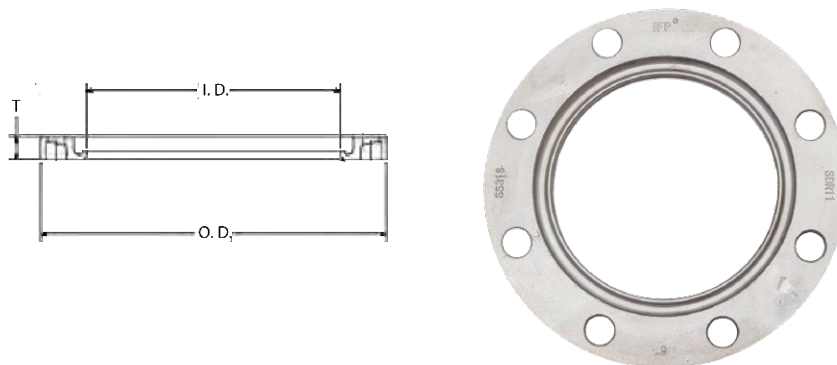

SDR 11 (Standard Dimension Ratio) 200 PSI							
Nominal IPS PipeSize	Pressure Class	OD inches	ID inches	Bolt Holes	Thickness Inches	Weight lbs.	Item Code
2"	SDR 11	6.00	2.46	4	0.45	1.7	BURSS-02IPS-11
3"	SDR 11	7.50	3.75	4	0.53	2.6	BURSS-03IPS-11
4"	SDR 11	9.00	4.80	8	0.55	3.7	BURSS-04IPS-11
6"	SDR 11	11.00	6.90	8	0.63	5.6	BURSS-06IPS-11
8"	SDR 11	13.50	8.90	8	0.85	10.0	BURSS-08IPS-11
10"	SDR 11	16.00	11.00	12	0.98	14.5	BURSS-10IPS-11
12"	SDR 11	19.00	13.15	12	1.25	25.0	BURSS-12IPS-11
14"	SDR 11	21.00	14.42	12	1.38	35.0	BURSS-14IPS-11
16"	SDR 11	23.50	16.47	16	1.52	45.0	BURSS-16IPS-11
18"	SDR 11	25.00	18.52	16	1.65	51.0	BURSS-18IPS-11





Molded Butt Fusion MJ Adapters

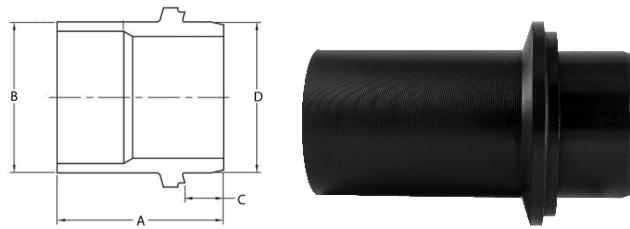

SDR 9 (Standard Dimension Ratio) 255 PSI (Working Pressure at 73.4° F)							
SDR 11 (Standard Dimension Ratio) 200 PSI (Working Pressure at 73.4° F)							
IPS - with or without SS Stiffeners							
Nominal IPS Pipe Size	SDR	A inches	B inches	C inches	D inches	Weight	Item Code
2"	11	8.00	2.38	2.34	2.38	1.90	MJI-2IPS-11
3"	11	9.00	3.50	2.34	3.96	2.10	MJI-3IPS-11
4"	9	10.25	4.50	2.34	4.80	3.38	MJI-4IPS-9
4"	11	10.25	4.50	2.34	4.80	2.96	MJI-4IPS-11
6"	9	11.31	6.63	2.34	6.90	6.96	MJI-6IPS-9
6"	11	11.31	6.63	2.34	6.90	6.26	MJI-6IPS-11
8"	9	11.94	8.63	2.34	9.05	12.65	MJI-8IPS-9
8"	11	11.94	8.63	2.34	9.05	11.11	MJI-8IPS-11
10"	9	13.56	10.75	2.34	11.10	20.90	MJI-10IPS-9
10"	11	13.56	10.75	2.34	11.10	18.10	MJI-10IPS-11
12"	9	13.00	12.75	2.34	13.20	28.00	MJI-12IPS-9
12"	11	13.00	12.75	2.34	13.20	24.16	MJI-12IPS-11
14"	11						MJI-14IPS-11
16"	11						MJI-16IPS-11
18"	11						MJI-18IPS-11
20"	11						MJI-20IPS-11
24"	11						MJI-24IPS-11





Molded Butt Fusion MJ Adapters

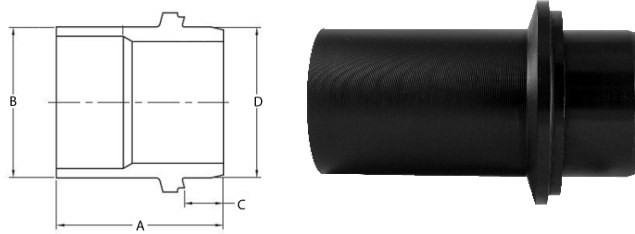

SDR 9 (Standard Dimension Ratio) 255 PSI (Working Pressure at 73.4° F)							
SDR 11 (Standard Dimension Ratio) 200 PSI (Working Pressure at 73.4° F)							
DIPS - with or without SS Stiffeners							
Nominal IPS Pipe Size	SDR	A inches	B inches	C inches	D inches	Weight	Item Code
4"	9	10.25	4.80	2.34	4.80	3.54	MJI-4DIPS-9
4"	11	10.25	4.80	2.34	4.80	3.21	MJI-4DIPS-11
6"	9	11.31	6.90	2.34	6.90	7.69	MJI-6DIPS-9
6"	11	11.31	6.90	2.34	6.90	6.83	MJI-6DIPS-11
8"	9	11.94	9.05	2.34	9.05	12.96	MJI-8DIPS-9
8"	11	11.94	9.05	2.34	9.05	11.25	MJI-8DIPS-11
10"	9	13.56	11.10	2.34	11.10	22.08	MJI-10DIPS-9
10"	11	13.56	11.10	2.34	11.10	19.93	MJI-10DIPS-11
12"	9	13.00	13.20	2.34	13.20	30.20	MJI-12DIPS-9
12"	11	13.00	13.20	2.34	13.20	25.91	MJI-12DIPS-11
14"	11						MJI-14DIPS-11
16"	11						MJI-16DIPS-11
18"	11						MJI-18DIPS-11
20"	11						MJI-20DIPS-11
24"	11						MJI-24DIPS-11





MJ Accessory Kits					
Nominal Pipe Size	Type	Bolt Size	Number of Bolts	Weight in lbs	Item Code
2"	C153	5/8" x 5"	2	6.13	MJKIT-02
3"	C153	5/8" x 4.5"	4	6.70	MJKIT-03
4"	C153	3/4" x 4.5"	4	7.44	MJKIT-04
6"	C153	3/4" x 5"	6	11.20	MJKIT-06
8"	C153	3/4" x 5"	6	12.35	MJKIT-08
10"	C153	3/4" x 6"	8	17.64	MJKIT-10
12"	C153	3/4" x 6"	8	19.21	MJKIT-12
14"	C153				MJKIT-14
16"	C153				MJKIT-16
18"	C153				MJKIT-18
20"	C153				MJKIT-20
24"	C153				MJKIT-24

IntegriFuse™

Electrofusion Fittings



Specialty Fittings



Couplers



Branch Saddles

Tapping Tees



Water - 200-240 PSI @ 73° F Sustainable Max Operating Pressure

Gas - 150 PSI @ 73° F Sustainable Max Operating Pressure

Designed for use on IPS SDR 11-17 Only

Engineered for PE 2406, PE3408, PE4710, PE100 HDPE Pipe Systems

Suitable for Water, Gas, Fluids & Slurry's

Manufactured in accordance with ASTM F-714, ASTM F-1055, ASTM D-2513, ASTM D-3035, ASTM D-3350, AWWA C-901, AWWA C-906, DIN 16963, EN 1555, EN 12201

All IntegriFuse EF Fittings use 4.0mm Pins

www.IntegrityFusion.com

SDR 11 Electrofusion Couplers IPS Series

Water - 200 - 240 PSI / Gas - 150 PSI @ 73° F
Sustainable Maximum Operating Pressure
Designed for use on
IPS SDR 9 - SDR 17 HDPE Pipe Only

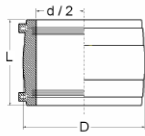

Type A

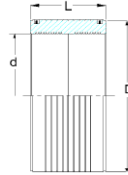

Type B

Nominal IPS Pipe Size	OD inches	D inches	L inches	Unit Weight in lbs.	TYPE	Item Code
½" IPS	0.84	1.34	2.83	0.06	A	CI-0050IPS-240
¾" IPS	1.05	1.57	2.83	0.11	A	CI-0075IPS-240
1" IPS	1.32	1.81	3.15	0.45	A	CI-01IPS-240
1 ¼" IPS	1.66	2.17	3.39	0.50	A	CI-0125IPS-240
1 ½" IPS	1.90	2.52	3.86	0.50	A	CI-0150IPS-240
2" IPS	2.37	3.07	4.21	0.67	A	CI-02IPS-240
3" IPS	3.50	4.41	5.79	1.40	A	CI-03IPS-240
4" IPS	4.50	5.51	6.30	2.43	A	CI-04IPS-240
5" IPS	5.56	6.85	6.73	5.75	A	CI-05IPS-240
6" IPS	6.63	8.11	7.28	5.75	B	CI-06IPS-240
8" IPS	8.63	10.63	8.03	9.40	B	CI-08IPS-240
10" IPS	10.75	13.28	8.66	17.00	B	CI-10IPS-240
12" IPS	12.75	15.75	9.60	20.00	B	CI-12IPS-240
14" IPS (1)	14.00	17.29	10.00	30.00	B	CI-14IPS-240
16" IPS (1)	16.00	19.76	11.81	39.81	B	CI-16IPS-240
18" IPS (1)	18.00	22.24	12.60	52.04	B	CI-18IPS-240
20" IPS (1)	20.00	24.71	14.41	82.29	B	CI-20IPS-240
22" IPS (1)	22.00	27.18	15.70	108.88	B	CI-22IPS-240
24" IPS (1)(2)	24.00	29.65	15.70	131.86	B	CI-24IPS-240
26" IPS (1)(2)	26.00	32.12	17.50	132.72	B	CI-26IPS-240
28" IPS (1)(2)	28.00	34.59	17.52	198.58	B	CI-28IPS-240
30" IPS (1)(2)	30.00	37.06	17.52	223.98	B	CI-30IPS-240
32" IPS (1)(2)	32.00	39.53	18.50	257.20	B	CI-32IPS-240
34" IPS (1)(2)	34.00	42.00	19.69	318.26	B	CI-34IPS-240
36" IPS (1)(2)	36.00	44.47	19.69	310.57	B	CI-36IPS-240

(1) Separate fusion zones
(2) Requires the IntegriFuse EF Processor for installation
All Fittings Available to order in CL150 & CL200





SDR 11 Electrofusion Couplers DIPS Series	Water - 200 - 240 PSI / Gas - 150 PSI @ 73° F Sustainable Maximum Operating Pressure Designed for use on DIPS SDR 9 - SDR 17 HDPE Pipe Only
---	--

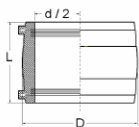

Type A

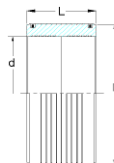

Type B



Nominal DIPS Pipe Size	OD inches	D in inches	L in inches	Unit Weight in lbs	TYPE	Item Code
4"	4.80	6.30	6.60	3.00	A	CT-04DIPS-240
6"	6.90	8.46	7.87	5.63	B	CT-06DIPS-240
8"	9.05	10.60	8.05	10.12	B	CT-08DIPS-240
10"	11.10	13.00	8.66	16.00	B	CT-10DIPS-240
12"	13.20	15.35	9.06	30.00	B	CT-12DIPS-240
14" DIPS (1)	15.30	18.30	11.80	44.00	B	CT-14DIPS-240
16" DIPS (1)	17.40	20.86	12.60	59.00	B	CT-16DIPS-240
18" DIPS (1)	19.50	23.20	14.40	85.00	B	CT-18DIPS-240
20" DIPS (1)	21.60	26.50	15.70	97.00	B	CT-20DIPS-240
24" DIPS (1)(2)	25.80	30.50	16.50	116.00	B	CT-24DIPS-240
30" DIPS (1)(2)	32.00	37.40	18.50	188.85	B	CT-30DIPS-240

- (1) Separate fusion zones
- (2) Requires the IntegriFuse EF Processor for installation
- (3) Available to order in FM CL150 & CL200

SDR 11 Electrofusion Couplers CTS Series	Water - 240 PSI / Gas - 150 PSI @ 73° F Sustainable Maximum Operating Pressure Designed for use on CTS SDR 9 - SDR 17 HDPE Pipe Only
--	---

Nominal IPS Pipe Size	d & d/2 inches	D inches	L inches	Unit Weight in lbs.	TYPE	Item Code
½" CTS	0.84	1.61	2.80	0.06	A	CT-0050IPS-240
¾" CTS	1.05	1.61	2.80	0.11	A	CT-0075IPS-240
1" CTS	1.32	1.89	3.23	0.45	A	CT-01IPS-240





SDR 17
Electrofusion Couplers
 IPS Series

Water - 160 PSI / Gas -100 PSI @ 73° F
 Sustainable Maximum Operating Pressure
 Designed for use on
 IPS SDR 17 - SDR 21 HDPE Pipe Only

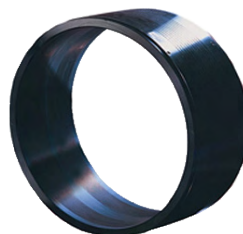
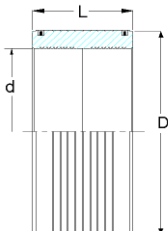

Nominal IPS Pipe Size	OD inches	D inches	L inches	Unit Weight in lbs.	Item Code
18" (1)	18.00	20.77	12.60	38.21	CT-18IPS-160
20" (1)	20.00	23.08	14.41	54.75	CT-20IPS-160
22" (1)	22.00	25.38	15.70	81.97	CT-22IPS-160
24" (1) (2)	24.00	27.69	15.70	92.78	CT-24IPS-160
26" (1) (2)	26.00	30.00	17.50	120.21	CT-26IPS-160
28" (1) (2)	28.00	32.31	17.52	147.71	CT-28IPS-160
30" (1) (2)	30.00	34.62	17.52	182.95	CT-30IPS-160
32" (1) (2)	32.00	36.92	18.50	188.85	CT-32IPS-160
34" (1) (2)	34.00	39.23	19.69	186.84	CT-34IPS-160
36" (1) (2)	36.00	41.54	19.69	238.80	CT-36IPS-160
42" (1) (2)	42.00	48.03	19.69	291.02	CT-42IPS-160
48" (1) (2)	48.00	55.12	20.67	413.04	CT-48IPS-160
54" (1) (2)	54.00	62.99	21.65	620.18	CT-54IPS-160
63" (1) (2)	63.00	72.01	22.64	749.53	CT-63IPS-160

(1) Separate fusion zones
 (2) Requires the IntegriFuse EF Processor for installation





SDR 26 Electrofusion Couplers IPS Series	Water - 100 PSI / Gas - 60 PSI @73° F Sustainable Maximum Operating Pressure Designed for use on IPS SDR 21 - SDR 32.5 HDPE Pipe Only
--	--

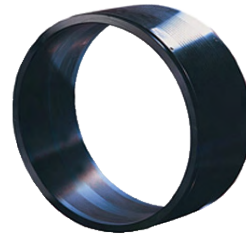
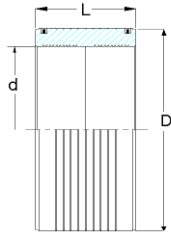

Nominal IPS Pipe Size	d & d/2 inches	D inches	L inches	Unit Weight in lbs.	TYPE	Item Code
18" (1) (2)	18.00	20.08	9.06	25.00	B	CT-18IPS-100
20" (1)	20.00	22.44	9.06	25.54	B	CT-20IPS-100
22" (1) (2)	22.00	24.21	9.84	27.40	B	CT-22IPS-100
24" (1)	24.00	26.77	13.78	52.79	B	CT-24IPS-100
26" (1) (2)	26.00	28.74	13.78	56.27	B	CT-26IPS-100
28" (1) (2)	28.00	30.71	13.78	59.66	B	CT-28IPS-100
30" (1) (2)	30.00	33.07	13.78	72.66	B	CT-30IPS-100
32" (1) (2)	32.00	35.43	13.78	86.85	B	CT-32IPS-100
34" (1) (2)	34.00	37.40	15.75	104.13	B	CT-34IPS-100
36" (1) (2)	36.00	40.55	19.69	186.72	B	CT-36IPS-100
42" (1) (2)	42.00	46.46	19.69	211.28	B	CT-42IPS-100
48" (1) (2)	48.00	53.15	19.69	279.16	B	CT-48IPS-100
54" (1) (2)	54.00	59.06	19.69	306.29	B	CT-54IPS-100
63" (1) (2)	63.00	68.90	19.69	416.89	B	CT-63IPS-100

(1) Separate fusion zones
 (2) Requires the IntegriFuse EF Processor for installation



SDR 7 Electrofusion Couplers

IPS Series

Water - 380 PSI @73° F
Sustainable Maximum Operating Pressure
Designed for use on
IPS SDR 7 - SDR 9 HDPE Pipe Only

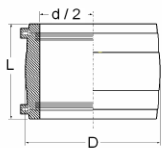

Type A

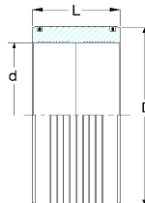

Type B

Nominal IPS Pipe Size	d & d/2 inches	D inches	L inches	TYPE	Unit Weight in lbs.	Item Code
2" (2)	2.38	3.82	4.65	A	1.13	CT-02IPS-380
3" (2)	3.50	5.59	6.57	A	3.40	CT-03IPS-380
4" (2)	4.50	6.26	6.77	A	3.49	CT-04IPS-380
5" (2)	5.56	8.03	7.28	A	6.65	CT-05IPS-380
6" (2)	6.68	9.13	8.35	A	8.83	CT-06IPS-380
8" (2)	8.63	12.20	8.35	B	16.94	CT-08IPS-380
10" (2)	10.75	15.35	8.82	B	28.86	CT-10IPS-380
12" (2)	12.75	17.32	9.13	B	34.20	CT-12IPS-380
14" (1) (2)	14.00	19.29	10.04	B	48.15	CT-14IPS-380
16" (1) (2)	16.00	21.77	11.81	B	70.10	CT-16IPS-380
18" (1) (2)	18.00	24.41	12.60	B	93.23	CT-18IPS-380
20" (1) (2)	20.00	27.17	14.37	B	132.22	CT-20IPS-380
22" (1) (2)	22.00	30.71	15.75	B	196.80	CT-22IPS-380

(1) Separate fusion zones
(2) Requires the IntegriFuse EF Processor for installation



Electrofusion 90 Degree Elbows

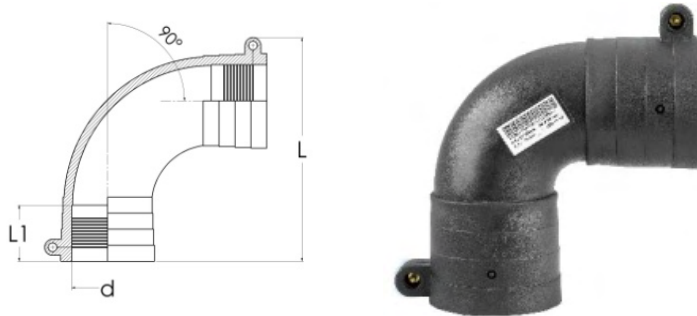

Nominal Pipe Size d	Base Norm	L	L1	Unit Weight in lbs.	PSI	Item Code
¾"	IPS	3.86	1.50	0.15	240	90EF-075-IPS
1"	CTS	4.29	1.61	0.31	240	90EF-1-CTS
1"	IPS	4.29	1.61	0.22	240	90EF-1-IPS
1 ¼"	IPS	5.16	1.85	0.37	240	90EF-125-IPS
1 ½"	IPS	6.10	2.01	0.62	240	90EF-150-IPS
2"	IPS	7.44	1.89	1.15	240	90EF-2-IPS
3"	IPS	9.53	2.76	2.45	240	90EF-3-IPS
4"	IPS	11.69	3.23	6.61	240	90EF-4-IPS
6"	IPS	13.19	3.94	9.19	220	90EF-6-IPS
8"	IPS	19.69	4.13	33.80	220	90EF-8-IPS





Electrofusion 45 Degree Elbows

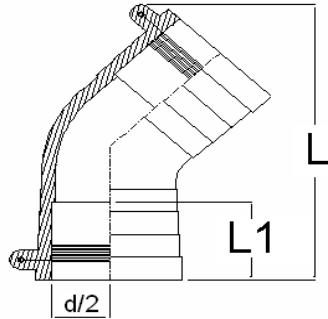

Nominal Pipe Size d	Base Norm	L	L1	Unit Weight in lbs.	PSI	Item Code
¾"	IPS					
1"	CTS	4.57	1.61	0.18	240	45EF-1-CTS
1"	IPS	4.57	1.61	0.18	240	45EF-1-IPS
1 ¼"	IPS	5.47	1.85	0.29	240	45EF-125-IPS
1 ½"	IPS	6.54	2.01	0.51	240	45EF-150-IPS
2"	IPS	7.76	2.28	0.88	240	45EF2-IPS
3"	IPS	9.53	2.83	2.07	240	45EF-3-IPS
4"	IPS	11.89	3.23	5.71	240	45EF-4-IPS
6"	IPS	14.17	3.94	8.64	220	45EF-6-IPS
8"	IPS	25.47	4.13	28.80	220	45EF-8-IPS





Electrofusion Tees

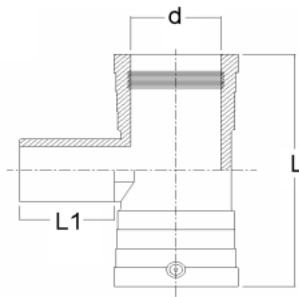

Nominal Pipe Size (d)	Base Norm	L	L1	Weight in lbs.	PSI	Item Code
¾"	IPS	4.25	1.46	1.59	240	TEF-075-IPS
1"	CTS	5.04	1.61	0.29	240	TEF-1-CTS
1"	IPS	5.04	1.61	0.29	240	TEF-1-IPS
1 ¼"	IPS	5.79	1.93	0.37	240	TEF-125-IPS
1 ½"	IPS	6.38	1.93	0.68	240	TEF-125-IPS
2"	IPS	7.32	2.40	1.26	240	TEF-2-IPS
3"	IPS	10.04	2.91	3.26	240	TEF-3-IPS
4"	IPS	11.93	3.11	5.86	240	TEF-4-IPS
6"	IPS	12.89	6.70	17.85	240	TEF-6-IPS
8"	IPS	18.11	7.48	43.85	240	TEF-8-IPS





Electrofusion Reducers

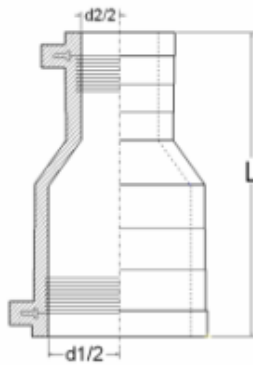

Nominal Pipe Size d1 x d2	L	Unit Weight in lbs.	PSI	Item Code
1" IPS X 1/2" IPS	3.54	0.11	240	REF-1X050-IPXIPS
1" IPS X 3/4" CTS	3.54	0.11	240	REF-1X075-IPXCTS
1" IPS X 3/4" IPS	3.54	0.12	240	REF-1X075-IPXIPS
1 1/4" IPS X 1" IPS	4.61	0.20	240	REF-125X1-IPXIPS
1 1/2" IPS X 1" IPS	5.16	0.33	240	REF-150X1-IPXIPS
2" IPS X 1" IPS	5.59	0.49	240	REF-2X1-IPXIPS
2" IPS X 1 1/4" IPS	5.47	0.54	240	REF-2X125-IPXIPS
2" IPS X 1 1/2" IPS	5.98	0.58	240	REF-2X150-IPXIPS
3" IPS X 2" IPS	7.48	1.30	240	REF-3X2-IPXIPS
4" IPS X 2" IPS	8.23	1.95	240	REF-4X2-IPXIPS
4" IPS X 3" IPS	8.46	2.41	240	REF4X3-IPXIPS





Electrofusion Flex Restraints

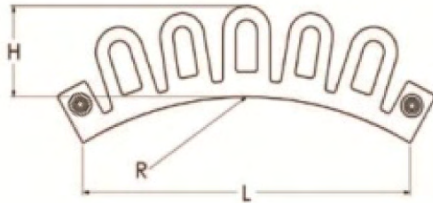

Nominal Base Size	Base Norm	Axial Resistance	H	L	W	Unit Weight in lbs.	Item Code
6" - 63"	IPS/DIPS	9,500 lbs.	1.58	5.98	2.50	0.42	FLEX-EF

6" IPS/DIPS - 10" IPS/DIPS fusible to SDR 9 - SDR 17
12" IPS/DIPS - 63" IPS fusible to SDR 9 to SDR 26



Electrofusion Branch Saddles

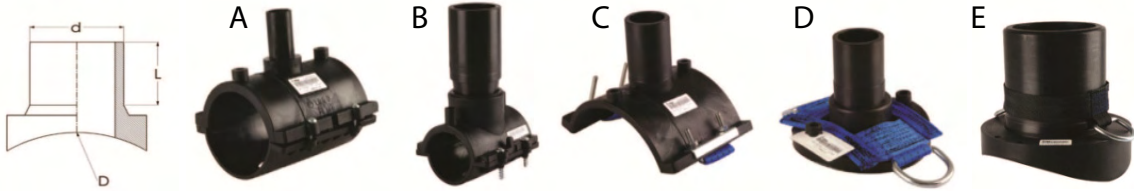

OUTLET (d)	OUTLET NORM	BASE (D)	BASE NORM	L	Weight in lbs	TYPE	PSI	Item Code
1"	IPS	2"	IPS	3.03	0.86	A	240	BST-2X1-IPXIPS
1"	IPS	3"	IPS	3.74	1.52	A	240	BST-3X1-IPXIPS
1"	IPS	4"	IPS	3.74	1.65	A	240	BST-4X1-IPXIPS
1"	IPS	6"	IPS	3.74	2.09	C	240	BST-6X1-IPXIPS
1"	IPS	8"	IPS	3.74	2.03	D	240	BST-8X1-IPXIPS
1"	IPS	10"	IPS	3.94	1.48	D	240	BST-10X1-IPXIPS
1"	IPS	12"	IPS	5.12	1.52	D	240	BST-12X1-IPXIPS
1"	IPS	14"	IPS	5.12	1.72	D	240	BST-14X1-IPXIPS
1"	IPS	16"	IPS	5.12	0.99	D	240	BST-16X1-IPXIPS
1"	IPS	18"	IPS	5.12	0.99	D	240	BST-18X1-IPXIPS
1"	IPS	4"	DIPS	3.74	1.68	B	240	BST-4X1-DIPXIPS
1"	IPS	6"	DIPS	3.74	2.12	C	240	BST-6X1-DIPXIPS
1"	IPS	8"	DIPS	5.12	2.03	D	240	BST-8X1-DIPXIPS
1"	IPS	10"	DIPS	5.12	1.48	D	240	BST-10X1-DIPXIPS
1"	IPS	12"	DIPS	5.12	1.72	D	240	BST-12X1-DIPXIPS
1"	IPS	14"	DIPS	5.12	0.99	D	240	BST-14X1-DIPXIPS
1"	IPS	16"	DIPS	5.12	0.99	D	240	BST-16X1-DIPXIPS
1 ¼"	IPS	2"	IPS	3.03	0.88	A	240	BST-2X125-IPXIPS
1 ¼"	IPS	3"	IPS	3.74	1.54	A	240	BST-3X125-IPXIPS
1 ¼"	IPS	4"	IPS	3.74	1.68	A	240	BST-4X125-IPXIPS
1 ¼"	IPS	2"	IPS	4.92	1.65	A	240	BST-2X150-IPXIPS
1 ½"	IPS	3"	IPS	5.31	1.57	A	240	BST-3X150-IPXIPS
1 ½"	IPS	4"	IPS	5.31	1.70	A	240	BST-4X150-IPXIPS
1 ½"	IPS	6"	IPS	5.31	2.18	C	240	BST-6X150-IPXIPS
1 ½"	IPS	8"	IPS	5.31	2.07	D	240	BST-8X150-IPXIPS
2"	IPS	2"	IPS	4.92	1.76	A	240	BST-2X02-IPXIPS
2"	IPS	3"	IPS	5.31	1.59	A	240	BST-3X2-IPXIPS
2"	IPS	4"	IPS	5.31	1.72	A	240	BST-4X2-IPXIPS

Electrofusion Branch Saddles

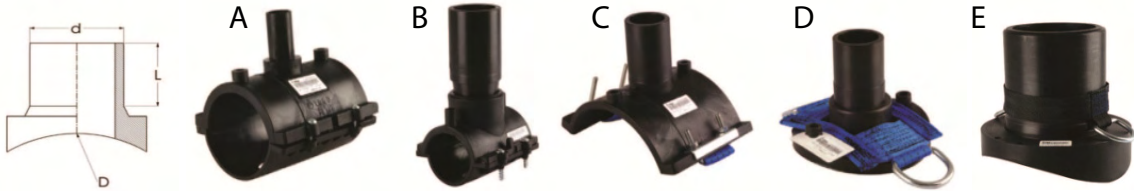

OUTLET (d)	OUTLET NORM	BASE (D)	BASE NORM	L	Weight in lbs	TYPE	PSI	Item Code
2"	IPS	6"	IPS	5.31	2.20	C	240	BST-6X2-IPXSIPS
2"	IPS	8"	IPS	5.31	2.09	D	240	BST-8X2-IPXSIPS
2"	IPS	10"	IPS	4.92	1.54	D	240	BST-10X2-IPXSIPS
2"	IPS	12"	IPS	4.92	1.54	D	240	BST-12X2-IPXSIPS
2"	IPS	14"	IPS	4.92	1.72	D	240	BST-14X2-IPXSIPS
2"	IPS	16"	IPS	4.92	1.15	D	240	BST-16X2-IPXSIPS
2"	IPS	18"	IPS	4.92	1.15	D	240	BST-18X2-IPXSIPS
2"	IPS	20"	IPS	4.92	1.15	D	240	BST-20X2-IPXSIPS
2"	IPS	22"	IPS	4.92	1.15	D	240	BST-22X2-IPXSIPS
2"	IPS	24"	IPS	4.92	1.15	D	240	BST-24X2-IPXSIPS
2"	IPS	26"	IPS	4.92	1.15	D	240	BST-26X2-IPXSIPS
2"	IPS	28"	IPS	4.92	1.15	D	240	BST-28X2-IPXSIPS
2"	IPS	30"	IPS	4.92	1.15	D	240	BST-30X2-IPXSIPS
2"	IPS	32"	IPS	4.92	1.15	D	240	BST-32X2-IPXSIPS
2"	IPS	36"	IPS	4.92	1.15	D	240	BST-36X2-IPXSIPS
2"	IPS	4"	DIPS	5.31	1.76	B	240	BST-4X2-DIPSXIPS
2"	IPS	6"	DIPS	5.31	2.23	C	240	BST-6X2-DIPSXIPS
2"	IPS	8"	DIPS	4.92	2.09	D	240	BST-8X2-DIPSXIPS
2"	IPS	10"	DIPS	4.92	1.46	D	240	BST-10X2-DIPSXIPS
2"	IPS	12"	DIPS	4.92	1.72	D	240	BST-12X2-DIPSXIPS
2"	IPS	14"	DIPS	4.92	1.15	D	240	BST-14X2-DIPSXIPS
2"	IPS	16"	DIPS	4.92	1.15	D	240	BST-16X2-DIPSXIPS
3"	IPS	3"	IPS	3.54	1.32	E	200	BST-03X03-IPXSIPS
3"	IPS	4"	IPS	3.54	1.32	E	240	BST-04X03-IPXSIPS
3"	IPS	5"	IPS	3.54	1.32	E	240	BST-05X03-IPXSIPS
3"	IPS	6"	IPS	3.54	1.32	E	240	BST-06X03-IPXSIPS
3"	IPS	8"	IPS	3.54	1.32	E	240	BST-08X03-IPXSIPS
3"	IPS	10"	IPS	3.54	1.32	E	240	BST-10X03-IPXSIPS

Electrofusion Branch Saddles

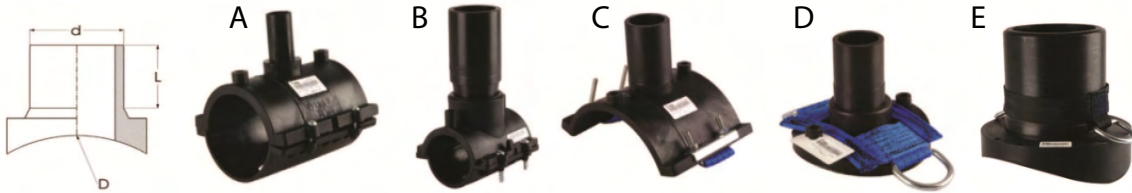

OUTLET (d)	OUTLET NORM	BASE (D)	BASE NORM	L	Weight in lbs	TYPE	PSI	Item Code
3"	IPS	12"	IPS	3.54	1.32	E	240	BST-12X03-IPXIPS
3"	IPS	14"	IPS	3.54	1.32	E	240	BST-14X03-IPXIPS
3"	IPS	16"	IPS	3.54	1.32	E	240	BST-16X03-IPXIPS
3"	IPS	18"	IPS	3.54	1.32	E	240	BST-18X03-IPXIPS
3"	IPS	20"	IPS	3.54	1.32	E	240	BST-20X03-IPXIPS
3"	IPS	22"	IPS	3.54	1.32	E	240	BST-22X03-IPXIPS
3"	IPS	24"	IPS	3.54	1.32	E	240	BST-24X03-IPXIPS
3"	IPS	30"	IPS	3.54	1.32	E	240	BST-30X03-IPXIPS
3"	IPS	32"	IPS	3.54	1.32	E	240	BST-32X03-IPXIPS
3"	IPS	36"	IPS	3.54	1.32	E	240	BST-36X03-IPXIPS
3"	IPS	42"	IPS	3.54	1.32	E	240	BST-42X03-IPXIPS
3"	IPS	48"	IPS	3.54	1.32	E	240	BST-48X03-IPXIPS
3"	IPS	54"	IPS	3.54	1.32	E	240	BST-54X03-IPXIPS
3"	IPS	63"	IPS	3.54	1.32	E	240	BST-63X03-IPXIPS
4"	IPS	4"	IPS	3.54	1.32	E	200	BST-04X04-IPXIPS
4"	IPS	5"	IPS	3.54	2.65	E	240	BST-05X04-IPXIPS
4"	IPS	6"	IPS	3.54	2.65	E	240	BST-06X04-IPXIPS
4"	IPS	8"	IPS	3.54	2.65	E	240	BST-08X04-IPXIPS
4"	IPS	10"	IPS	3.54	2.65	E	240	BST-10X04-IPXIPS
4"	IPS	12"	IPS	3.54	2.65	E	240	BST-12X04-IPXIPS
4"	IPS	14"	IPS	3.54	2.65	E	240	BST-14X04-IPXIPS
4"	IPS	16"	IPS	3.54	2.65	E	240	BST-16X04-IPXIPS
4"	IPS	18"	IPS	3.54	2.65	E	240	BST-18X04-IPXIPS
4"	IPS	20"	IPS	3.54	2.65	E	240	BST-20X04-IPXIPS
4"	IPS	22"	IPS	3.54	2.65	E	240	BST-22X04-IPXIPS
4"	IPS	24"	IPS	3.54	2.65	E	240	BST-24X04-IPXIPS
4"	IPS	30"	IPS	3.54	2.65	E	240	BST-30X04-IPXIPS
4"	IPS	32"	IPS	3.54	2.65	E	240	BST-32X04-IPXIPS
4"	IPS	36"	IPS	3.54	2.65	E	240	BST-36X04-IPXIPS

Electrofusion Branch Saddles

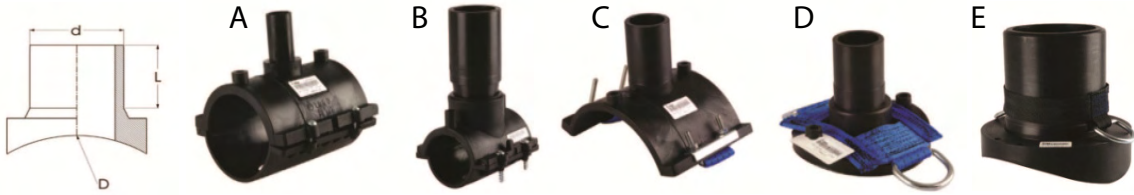

OUTLET (d)	OUTLET NORM	BASE (D)	BASE NORM	L	Weight in lbs	TYPE	PSI	Item Code
4"	IPS	42"	IPS	3.54	2.65	E	240	BST-42X04-IP SXIPS
4"	IPS	48"	IPS	3.54	2.65	E	240	BST-48X04-IP SXIPS
4"	IPS	54"	IPS	3.54	2.65	E	240	BST-54X04-IP SXIPS
4"	IPS	63"	IPS	3.54	2.65	E	240	BST-63X04-IP SXIPS
4"	DIPS	6"	DIPS	3.54	2.65	E	240	BST-06X04-DIP SXDIPS
4"	DIPS	8"	DIPS	3.54	2.65	E	240	BST-08X04-DIP SXDIPS
4"	DIPS	10"	DIPS	3.54	2.65	E	240	BST-10X04-DIP SXDIPS
4"	DIPS	12"	DIPS	3.54	2.65	E	240	BST-12X04-DIP SXDIPS
4"	DIPS	14"	DIPS	3.54	2.65	E	240	BST-14X04-DIP SXDIPS
4"	DIPS	16"	DIPS	3.54	2.65	E	240	BST-16X04-DIP SXDIPS
4"	DIPS	18"	DIPS	3.54	2.65	E	240	BST-18X04-DIP SXDIPS
4"	DIPS	24"	DIPS	3.54	2.65	E	240	BST-24X04-DIP SXDIPS
4"	DIPS	30"	DIPS	3.54	2.65	E	240	BST-30X04-DIP SXDIPS
4"	DIPS	36"	DIPS	3.54	2.65	E	240	BST-36X04-DIP SXDIPS
4"	DIPS	42"	DIPS	3.54	2.65	E	240	BST-42X04DIP SXDIPS
4"	DIPS	48"	DIPS	3.54	2.65	E	240	BST-48X04DIP SXDIPS
6"	IPS	6"	IPS	4.33	3.97	E	240	BST-06X06-IP SXIPS
6"	IPS	8"	IPS	5.91	5.07	E	240	BST-08X06-IP SXIPS
6"	IPS	10"	IPS	5.91	5.07	E	240	BST-10X06-IP SXIPS
6"	IPS	12"	IPS	5.91	5.07	E	240	BST-12X06-IP SXIPS
6"	IPS	14"	IPS	5.91	3.07	E	240	BST-14X06-IP SXIPS
6"	IPS	16"	IPS	5.91	5.07	E	240	BST-16X06-IP SXIPS
6"	IPS	18"	IPS	5.91	5.07	E	240	BST-18X06-IP SXIPS
6"	IPS	20"	IPS	5.91	5.07	E	240	BST-20X06-IP SXIPS
6"	IPS	22"	IPS	5.91	5.07	E	240	BST-22X06-IP SXIPS
6"	IPS	24"	IPS	5.91	5.07	E	240	BST-24X06-IP SXIPS
6"	IPS	30"	IPS	5.91	5.07	E	240	BST-30X06-IP SXIPS
6"	IPS	32"	IPS	5.91	5.07	E	240	BST-32X06-IP SXIPS
6"	IPS	36"	IPS	5.91	5.07	E	240	BST-36X06-IP SXIPS

Electrofusion Branch Saddles

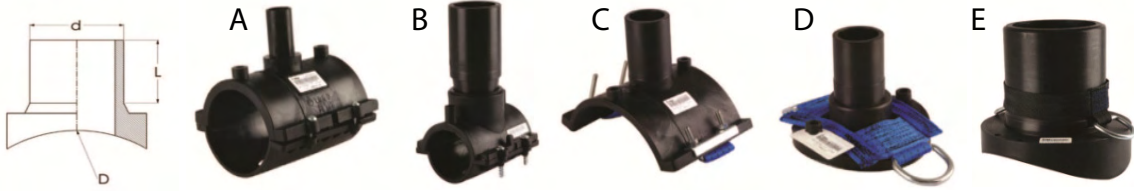

OUTLET (d)	OUTLET NORM	BASE (D)	BASE NORM	L	Weight in lbs	TYPE	PSI	Item Code
6"	IPS	42"	IPS	5.91	5.07	E	240	BST-42X06-IPSXIPS
6"	IPS	48"	IPS	5.91	5.07	E	240	BST-48X06-IPSXIPS
6"	IPS	54"	IPS	5.91	5.07	E	240	BST-54X06-IPSXIPS
6"	IPS	63"	IPS	5.91	5.07	E	240	BST-63X06-IPSXIPS
6"	DIPS	8"	DIPS	5.91	5.07	E	240	BST-08X06-DIPSXDIPS
6"	DIPS	10"	DIPS	5.91	5.07	E	240	BST-10X06-DIPSXDIPS
6"	DIPS	12"	DIPS	5.91	5.07	E	240	BST-12X06-DIPSXDIPS
6"	DIPS	14"	DIPS	5.91	5.07	E	240	BST-14X06-DIPSXDIPS
6"	DIPS	16"	DIPS	5.91	5.07	E	240	BST-16X06-DIPSXDIPS
6"	DIPS	18"	DIPS	5.91	5.07	E	240	BST-18X06-DIPSXDIPS
6"	DIPS	20"	DIPS	5.91	5.07	E	240	BST-20X06-DIPSXDIPS
6"	DIPS	24"	DIPS	5.91	5.07	E	240	BST-24X06-DIPSXDIPS
6"	DIPS	30"	DIPS	5.91	5.07	E	240	BST-30X06-DIPSXDIPS
6"	DIPS	36"	DIPS	5.91	5.07	E	240	BST-36X06-DIPSXDIPS
6"	DIPS	42"	DIPS	5.91	5.07	E	240	BST-42X06DIPSXDIPS
6"	DIPS	48"	DIPS	5.91	5.07	E	240	BST-48X06DIPSXDIPS
8"	IPS	8"	IPS	5.91	5.07	E	240	BST-08X08-IPSXIPS
8"	IPS	10"	IPS	5.91	9.92	E	240	BST-10X08-IPSXIPS
8"	IPS	12"	IPS	5.91	9.92	E	240	BST-12X08-IPSXIPS
8"	IPS	14"	IPS	5.91	9.92	E	240	BST-14X08-IPSXIPS
8"	IPS	16"	IPS	5.91	9.92	E	240	BST-16X08-IPSXIPS
8"	IPS	18"	IPS	5.91	9.92	E	240	BST-18X08-IPSXIPS
8"	IPS	20"	IPS	5.91	9.92	E	240	BST-20X08-IPSXIPS
8"	IPS	22"	IPS	5.91	9.92	E	240	BST-22X08-IPSXIPS
8"	IPS	24"	IPS	5.91	9.92	E	240	BST-24X08-IPSXIPS
8"	IPS	30"	IPS	5.91	9.92	E	240	BST-30X08-IPSXIPS
8"	IPS	32"	IPS	5.91	9.92	E	240	BST-32X08-IPSXIPS
8"	IPS	36"	IPS	5.91	9.92	E	240	BST-36X08-IPSXIPS
8"	IPS	42"	IPS	5.91	9.92	E	240	BST-42X08--IPSXIPS



Electrofusion Branch Saddles

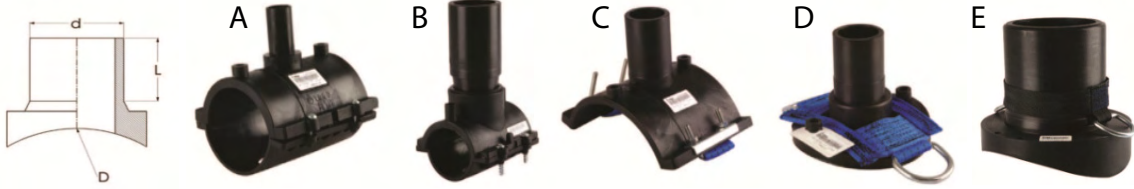

OUTLET (d)	OUTLET NORM	BASE (D)	BASE NORM	L	Weight in lbs	TYPE	PSI	Item Code
8"	IPS	48"	IPS	5.91	9.92	E	240	BST-48X08-IP SXIPS
8"	IPS	54"	IPS	5.91	9.92	E	240	BST-54X08-IP SXIPS
8"	IPS	63"	IPS	5.91	9.92	E	240	BST-63X08-IP SXIPS
8" (2)	DIPS	10"	DIPS	5.91	5.07	E	240	BST-10X08-DIP SXDIPS
8" (2)	DIPS	12"	DIPS	5.91	5.07	E	240	BST-12X08-DIP SXDIPS
8" (2)	DIPS	14"	DIPS	5.91	5.07	E	240	BST-14X08-DIP SXDIPS
8" (2)	DIPS	16"	DIPS	5.91	5.07	E	240	BST-16X08-DIP SXDIPS
8" (2)	DIPS	18"	DIPS	5.91	5.07	E	240	BST-18X08-DIP SXDIPS
8" (2)	DIPS	20"	DIPS	5.91	5.07	E	240	BST-20X08-DIP SXDIPS
8" (2)	DIPS	24"	DIPS	5.91	5.07	E	240	BST-24X08-DIP SXDIPS
8" (2)	DIPS	36"	DIPS	5.91	5.07	E	240	BST-36X08-DIP SXDIPS
8" (2)	DIPS	42"	DIPS	5.91	5.07	E	240	BST-42X08DIP SXDIPS
8" (2)	DIPS	48"	DIPS	5.91	18.74	E	240	BST-48X08DIP SXDIPS

(2) Requires the IntegriFuse EF Processor for installation





Threaded Outlet Electrofusion Branch Saddles

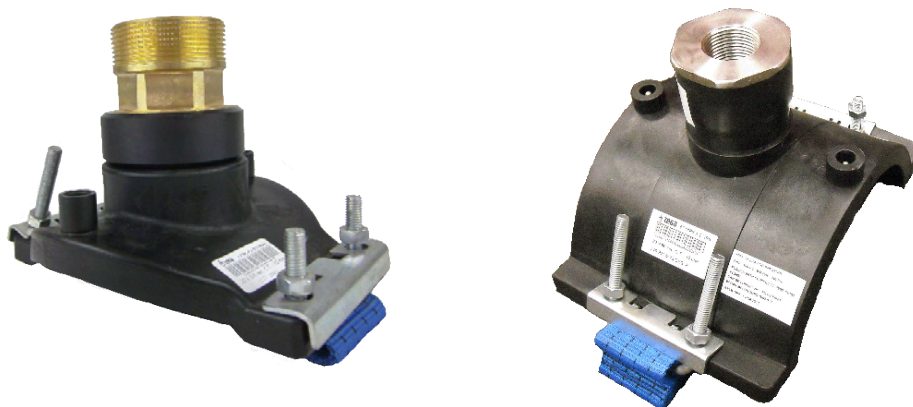

The following IntegriFuse Transitions are available to press on to saddles in Male (MPT) or Female (FPT)

Epoxy Coated Carbon	Brass
304 Stainless Steel	316 Stainless Steel

CC Threads / Corp Saddles Also Available to Order





Electrofusion Tapping Tees

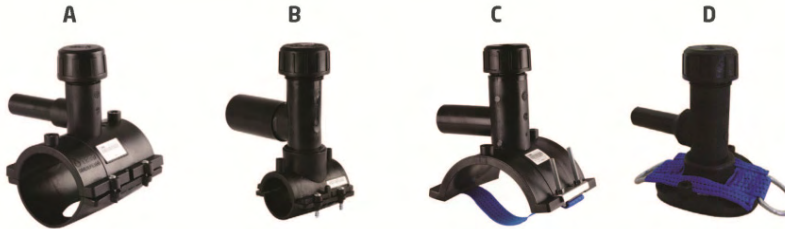
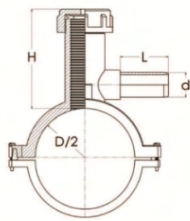

OUTLET (d)	OUTLET NORM	BASE (D)	BASE NORM	H	L	Unit Weight in lbs	TYPE	Item Code
1/2"	CTS	2"	IPS	4.13	2.05	1.23	A	TTT-2X050-IPXCTS
1/2"	CTS	3"	IPS	5.31	1.85	2.16	A	TTT-3X050-IPXCTS
1/2"	CTS	4"	IPS	5.31	1.89	2.27	A	TTT-4X050-IPXCTS
1/2"	CTS	6"	IPS	5.31	2.01	2.91	C	TTT-6X050-IPXCTS
1/2"	CTS	8"	IPS	5.31	2.01	2.91	D	TTT-8X050-IPXCTS
3/4"	IPS	2"	IPS	4.13	2.13	1.27	A	TTT-2X075-IPXIPS
3/4"	CTS	3"	IPS	5.31	1.85	2.16	A	TTT-3X075-IPXCTS
3/4"	IPS	3"	IPS	5.31	2.05	2.18	A	TTT-3X075-IPXIPS
3/4"	CTS	4"	IPS	5.31	1.89	2.27	A	TTT-4X075-IPXCTS
3/4"	IPS	4"	IPS	5.31	2.17	2.29	A	TTT-4X075-IPXIPS
3/4"	CTS	6"	IPS	5.31	2.01	2.91	C	TTT-6X075-IPXCTS
3/4"	IPS	6"	IPS	5.31	1.89	2.83	C	TTT-6X075-IPXIPS
3/4"	CTS	8"	IPS	5.31	2.01	2.91	D	TTT-8X075-IPXCTS
3/4"	IPS	8"	IPS	5.31	1.89	2.69	D	TTT-8X075-IPXIPS
3/4"	CTS	4"	DIPS	5.31	1.89	2.27	A	TTT-4X075-DIPXCTS
3/4"	IPS	4"	DIPS	5.31	2.17	2.29	A	TTT-4X075-DIPXIPS
3/4"	CTS	6"	DIPS	5.31	2.01	2.91	C	TTT-6X075-DIPXCTS
3/4"	IPS	6"	DIPS	5.31	1.89	2.69	C	TTT-6X075-DIPXIPS
3/4"	CTS	8"	DIPS	5.31	2.01	2.91	D	TTT-8X075-DIPXCTS
3/4"	IPS	8"	DIPS	5.31	1.89	2.69	D	TTT-8X075-DIPXIPS
1"	CTS	2"	IPS	4.13	2.13	1.30	A	TTT-2X1-IPXCTS
1"	IPS	2"	IPS	4.13	3.35	1.30	A	TTT-2X1-IPXIPS
1"	CTS	3"	IPS	5.31	2.05	2.18	A	TTT-3X1-IPXCTS
1"	IPS	3"	IPS	5.31	2.52	2.20	A	TTT-3X1-IPXIPS



Electrofusion Tapping Tees

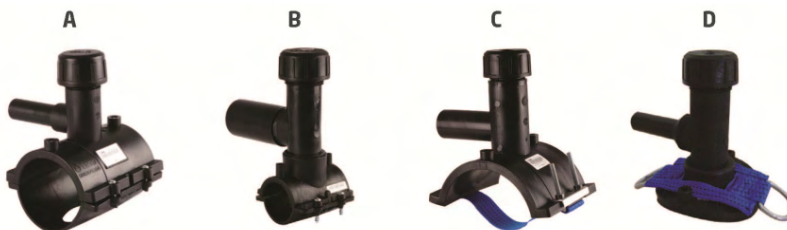
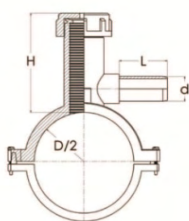

OUTLET (d)	OUTLET NORM	BASE (D)	BASE NORM	H	L	Unit Weight in lbs	TYPE	Item Code
1"	CTS	4"	IPS	5.31	2.17	2.29	A	TTT-4X1-IP SXCTS
1"	IPS	4"	IPS	5.31	2.68	2.36	A	TTT-4X1-IP SXIPS
1"	CTS	6"	IPS	5.31	1.89	2.83	C	TTT-6X1-IP SXCTS
1"	IPS	6"	IPS	5.31	3.27	2.82	C	TTT-6X1-IP SXIPS
1"	CTS	8"	IPS	5.31	1.89	2.69	D	TTT-8X1-IP SXCTS
1"	IPS	8"	IPS	5.31	3.27	2.65	D	TTT-8X1-IP SXIPS
1"	CTS	4"	DIPS	5.31	2.17	2.29	A	TTT-4X1-DIP SXCTS
1"	IPS	4"	DIPS	5.31	2.68	2.36	A	TTT-4X1-DIP SXIPS
1"	CTS	6"	DIPS	5.31	1.89	2.69	C	TTT-6X1-DIP SXCTS
1"	IPS	6"	DIPS	5.31	3.27	2.65	C	TTT-6X1-DIP SXIPS
1"	CTS	8"	DIPS	5.31	1.89	2.69	D	TTT-8X1-DIP SXCTS
1"	IPS	8"	DIPS	5.31	3.27	2.65	D	TTT-8X1-DIP SXIPS
1 ¼"	IPS	2"	IPS	4.13	3.54	1.30	A	TTT-2X125-IP SXIPS
1 ¼"	IPS	3"	IPS	5.31	3.50	2.23	A	TTT-3X125-IP SXIPS
1 ¼"	IPS	4"	IPS	5.31	2.76	2.38	A	TTT-4X125-IP SXIPS
1 ½"	IPS	4"	IPS	5.31	2.95	3.31	A	TTT-4X150-IP SXIPS
2"	IPS	2"	IPS	7.87	4.17	2.65	A	TTT-2X2-IP SXIPS
2"	IPS	3"	IPS	7.09	4.33	3.28	A	TTT-3X2-IP SXIPS
2"	IPS	4"	IPS	7.09	2.95	3.31	A	TTT-4X2-IP SXIPS
2"	IPS	6"	IPS	7.09	4.33	4.01	C	TTT-6X2-IP SXIPS
2"	IPS	8"	IPS	7.09	4.45	3.79	D	TTT-8X2-IP SXIPS

IntegriFuse™

Socket Fusion



90 Degree Elbows



Tees

Reducers



Couplers



Caps

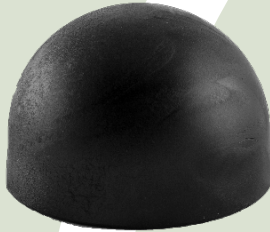

Socket x Brass Transitions



IntegriFuse Socket Fusion Kit





Molded Socket Fusion 90 Degree Elbows

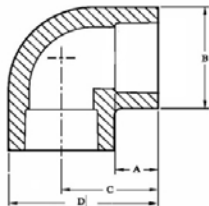

SDR 11 - 7 (Standard Dimension Ratio) up to 335 PSI (Working Pressure at 73.4° F)						
Nominal IPS Pipe Size	A inches	B inches	C inches	D inches	Weight lbs.	Item Code
¾"	0.75	1.50	1.63	2.38	0.11	90SK-075
1"	0.77	1.83	1.69	2.61	0.16	90SK-100
1 ¼"	0.95	2.27	2.09	3.23	0.27	90SK-125
1 ½"	0.98	2.63	2.33	3.65	0.41	90SK-150
2"	1.00	3.28	2.73	4.37	0.73	90SK-200



Molded Socket Fusion Tees

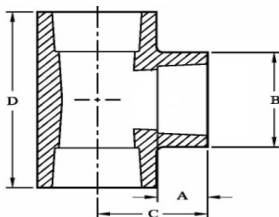

SDR 11 - 7 (Standard Dimension Ratio) up to 335 PSI (Working Pressure at 73.4° F)						
Nominal IPS Pipe Size	A inches	B inches	C inches	D inches	Weight lbs.	Item Code
¾"	0.73	1.49	1.63	3.25	0.14	TEESK-075
1"	0.75	1.84	1.69	3.41	0.21	TEESK-100
1 ¼"	0.98	2.30	2.10	4.22	0.38	TEESK-125
1 ½"	0.97	2.65	2.34	4.67	0.55	TEESK-150
2"	0.97	3.26	2.78	5.40	0.99	TEESK-200





Molded Socket Fusion Reducers

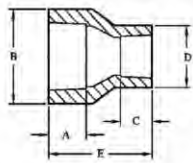

SDR 11 - 7 (Standard Dimension Ratio) up to 335 PSI (Working Pressure at 73.4° F)

Nominal IPS Pipe Size	A inches	B inches	C inches	D inches	E inches	Weight lbs.	Item Code
1" x 3/4"	0.75	1.83	0.68	1.46	1.98	0.08	REDSK-1X075
1 1/4" x 3/4"	1.00	2.26	0.72	1.46	2.18	0.13	REDSK-125X075
1 1/4" x 1"	0.96	2.26	0.81	1.83	2.27	0.15	REDSK-125X1
1 1/2" x 1"	0.96	2.56	0.77	1.84	2.15	0.15	REDSK-150X1
1 1/2" x 1 1/4"	0.97	2.56	0.95	2.30	2.16	0.18	REDSK-150X125
2" x 1"	0.99	3.27	0.76	1.83	2.52	0.27	REDSK-2X1
2" x 1 1/4"	1.00	3.28	0.96	2.28	2.55	0.29	REDSK-2X125
2" x 1 1/2"	0.99	3.27	0.97	2.55	2.56	0.30	REDSK-2X150



Molded Socket Fusion Couplers

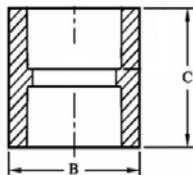

SDR 11 - 7 (Standard Dimension Ratio) up to 335 PSI (Working Pressure at 73.4° F)

Nominal IPS Pipe Size	B inches	C inches	Weight lbs.	Item Code
3/4"	1.46	2.19	0.07	CPLSK-075
1"	1.82	2.20	0.11	CPLSK-100
1 1/4"	2.27	2.19	0.15	CPLSK-125
1 1/2"	2.55	2.18	0.19	CPLSK-150
2"	3.27	2.36	0.34	CPLSK-200





Molded Socket Fusion Caps

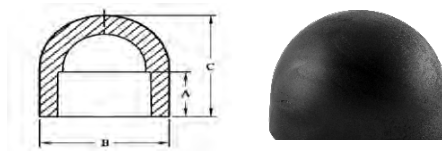

SDR 11 - 7 (Standard Dimension Ratio) up to 335 PSI (Working Pressure at 73.4° F)					
Nominal IPS Pipe Size	A inches	B inches	C inches	Weight lbs.	Item Code
¾"	0.74	1.45	1.56	0.05	CAPSK-075
1"	0.78	1.83	1.78	0.08	CAPSK-100
1 ¼"	0.98	2.28	2.23	0.16	CAPSK-125
1 ½"	0.98	2.55	2.00	0.17	CAPSK-150
2"	0.99	3.28	2.23	0.30	CAPSK-200



Molded Socket x Brass Transitions

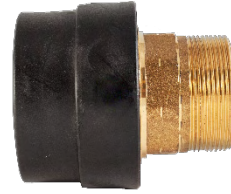
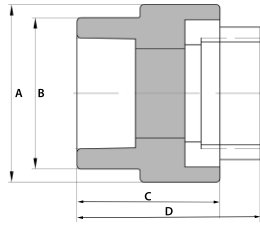

Male Socket x Brass Transitions						
Nominal IPS Pipe Size	A inches	B inches	C inches	D inches	Weight lbs.	Item Code
3/4"						
1"	2.14	1.77	2.06	2.78	0.58	TRANMSBRI-01
1 1/4"	2.59	2.20	2.09	3.54	0.80	TRANMSBRI-0125
1 1/2"						
2"	3.67	3.50	2.35	4.12	1.66	TRANMSBRI-02

Female Socket x Brass Transitions						
Nominal IPS Pipe Size	A inches	B inches	C inches	D inches	Weight lbs.	Item Code
3/4"						
1"	2.14	1.77	2.06	2.04	0.36	TRANFSBRI-01
1 1/4"	2.59	2.20	2.09	2.68	0.65	TRANFSBRI-0125
1 1/2"						
2"	3.67	3.50	2.35	3.09	1.24	TRANFSBRI-02

IntegriFuse™

Transition Fittings

Supertech ID Controlled

Threaded

Weld End

Grooved End

IntegriFuse OD Controlled

Threaded

Grooved

Standard NPT

Male Pipe Threads

Female Pipe Threads

Grooved





Supertech ID Controlled Transition Fitting Threaded - Internally and Externally Coated

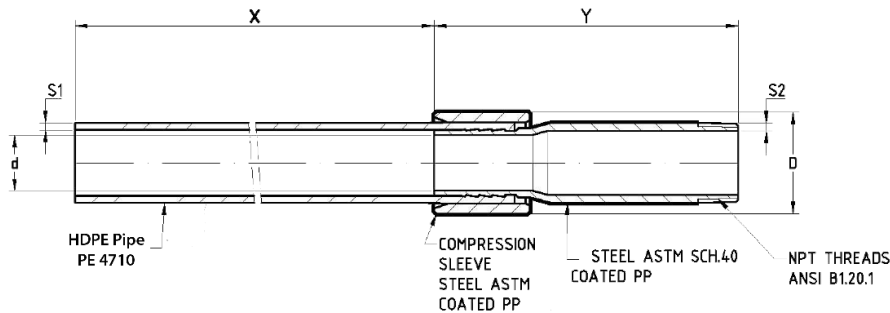

SDR 11 (Standard Dimension Ratio) 200 PSI (Working Pressure at 73.4° F)

Nom. Size Steel x HDPE (IPS)	X Inches	Y Inches	D Inches	d Inches	S1 Inches	S2 Inches	Item Code
1" x 1"	11.90	5.52	1.67	1.04	0.12	0.13	TR-TH0100-11
1 ¼" x 1 ¼"	11.94	5.88	1.90	1.32	.015	0.14	TR-TH0125-11
1 ½" x 1 ½"	12.03	6.19	2.37	1.52	0.17	0.15	TR-TH0150-11
2" x 2"	12.16	6.22	2.87	1.90	0.22	0.15	TR-TH0200-11
3" x 3"	11.97	7.03	4.00	2.82	0.32	0.22	TR-TH0300-11
4" x 4"	12.06	7.06	5.50	3.64	0.41	0.24	TR-TH0400-11
6" x 6"	17.40	12.09	7.63	5.38	0.60	0.28	TR-TH0600-11

SDR 9 (Standard Dimension Ratio) 255 PSI (Working Pressure at 73.4° F)

Nom. Size Steel x HDPE (IPS)	X Inches	Y Inches	D Inches	d Inches	S1 Inches	S2 Inches	Item Code
1" x 1"	11.90	5.52	1.67	0.99	0.14	0.13	TR-TH0100-9
1 ¼" x 1 ¼"	11.94	5.88	1.90	1.29	0.18	0.14	TR-TH0125-9
2" x 2"	12.16	6.22	2.87	1.82	0.26	0.15	TR-TH0200-9
3" x 3"	11.97	7.03	4.00	2.71	0.38	0.22	TR-TH0300-9
4" x 4"	12.06	7.06	5.50	3.49	0.48	0.24	TR-TH0400-9
6" x 6"	17.40	12.09	7.63	5.16	0.71	0.28	TR-TH0600-9

SDR 7 (Standard Dimension Ratio) based on 335 PSI (Working Pressure at 73.4° F)

Nom. Size Steel x HDPE (IPS)	X Inches	Y Inches	D Inches	d Inches	S1 Inches	S2 Inches	Item Code
1 ¼" x 1 ¼"	11.94	5.88	1.90	1.15	.028	0.14	TR-TH0125-7
2" x 2"	12.16	6.22	2.87	1.66	0.34	0.15	TR-TH0200-7
3" x 3"	11.97	7.03	4.00	2.46	0.50	0.22	TR-TH0300-7
4" x 4"	12.06	7.06	5.50	3.18	.64	0.24	TR-TH0400-7
6" x 6"	17.40	12.09	7.626	4.697	0.95	0.280	TR-TH0600-7





Supertech ID Controlled Transition Fitting Weld End - Externally Coated

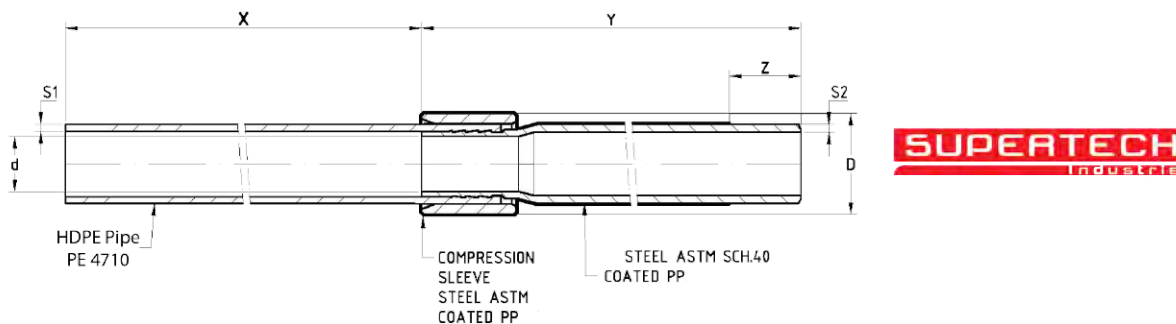

SDR 11 (Standard Dimension Ratio) 200 PSI (Working Pressure at 73.4° F)

Nom. Size Steel x HDPE (IPS)	X Inches	Y Inches	D Inches	d Inches	S1 Inches	S2 Inches	Z Inches	Item Code
1" x 1"	11.90	13.16	1.67	1.04	0.12	0.13	2	TR-WE0100-11
1 ¼" x 1 ¼"	11.94	13.44	1.90	1.32	.015	0.14	2	TR-WE0125-11
2" x 2"	12.16	13.78	2.87	1.90	0.22	0.15	2	TR-WE0200-11
3" x 3"	11.97	14.84	4.00	2.82	0.32	0.22	2	TR-WE0300-11
4" x 4"	12.06	14.88	5.50	3.64	0.41	0.24	2	TR-WE0400-11
6" x 6"	17.40	17.90	7.63	5.38	0.60	0.28	2	TR-WE0600-11
8" x 8"	24.44	22.88	9.63	7.02	.078	0.32	2	TR-WE0800-11

SDR 9 (Standard Dimension Ratio) 255 PSI (Working Pressure at 73.4° F)

Nom. Size Steel x HDPE (IPS)	X Inches	Y Inches	D Inches	d Inches	S1 Inches	S2 Inches	Z Inches	Item Code
2" x 2"	12.16	13.78	2.87	1.82	0.26	0.15	2	TR-WE0200-9
3" x 3"	11.97	14.84	4.00	2.71	0.38	0.22	2	TR-WE0300-9
4" x 4"	12.06	14.88	5.50	3.49	0.48	0.24	2	TR-WE0400-9
6" x 6"	17.40	17.90	7.63	5.16	0.71	0.28	2	TR-WE0600-9

SDR 7 (Standard Dimension Ratio) based on 335 PSI (Working Pressure at 73.4° F)

Nom. Size Steel x HDPE (IPS)	X Inches	Y Inches	D Inches	d Inches	S1 Inches	S2 Inches	Z Inches	Item Code
1 ¼" x 1 ¼"	11.94	13.44	1.90	1.32	.015	0.14	2	TR-WE0125-7
2" x 2"	12.16	13.78	2.87	1.90	0.22	0.15	2	TR-WE0200-7
3" x 3"	11.97	14.84	4.00	2.82	0.32	0.22	2	TR-WE0300-7
4" x 4"	12.06	14.88	5.50	3.64	0.41	0.24	2	TR-WE0400-7
6" x 6"	17.40	17.90	7.63	5.38	0.60	0.28	2	TR-WE0600-7
8" x 8"	24.44	22.88	9.63	7.02	.078	0.32	2	TR-WE0800-7





Supertech ID Controlled Transition Fitting Grooved End - Internally and Externally Coated

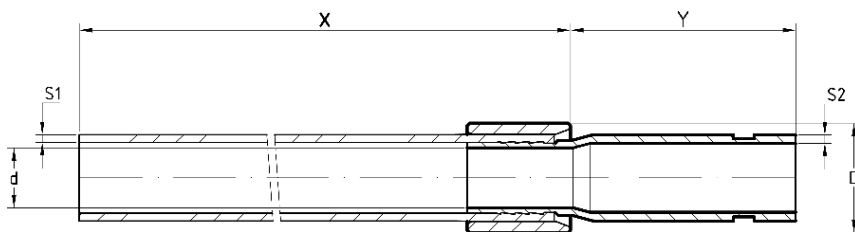

SDR 11 (Standard Dimension Ratio) 200 PSI (Working Pressure at 73.4° F)							
Nom. Size Steel x HDPE (IPS)	X Inches	Y Inches	D Inches	d Inches	S1 Inches	S2 Inches	Item Code
2" x 2"	12.16	13.78	2.87	1.82	0.26	0.15	TR-GR0200-11
3" x 3"	11.97	14.84	4.00	2.71	0.38	0.22	TR-GR0300-11
4" x 4"	12.06	14.88	5.50	3.49	0.48	0.24	TR-GR0400-11

SDR 7 (Standard Dimension Ratio) based on 335 PSI (Working Pressure at 73.4° F)							
Nom. Size Steel x HDPE (IPS)	X Inches	Y Inches	D Inches	d Inches	S1 Inches	S2 Inches	Item Code
2" x 2"	12.16	13.78	2.87	1.82	0.26	0.15	TR-GR0200-7
3" x 3"	11.97	14.84	4.00	2.71	0.38	0.22	TR-GR0300-7
4" x 4"	12.06	14.88	5.50	3.49	0.48	0.24	TR-GR0400-7





IntegriFuse OD Controlled Transition Fitting Threaded - Internally and Externally Coated

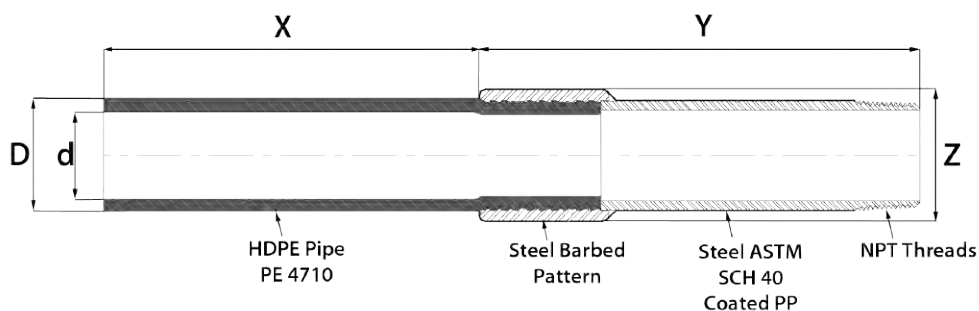

SDR 11 (Standard Dimension Ratio) 200 PSI (Working Pressure at 73.4° F)						
Nom. Size Steel x HDPE (IPS)	X Inches	Y Inches	D Inches	d Inches	Z Inches	Item Code
2" x 2"	9.27	5.83	2.38	1.91	2.64	TI-TH0200-11
3" x 3"	12.05	6.81	3.50	2.82	3.76	TI-TH0300-11
4" x 4"	11.83	7.40	4.50	3.63	4.74	TI-TH0400-11

SDR 9 (Standard Dimension Ratio) 255 PSI (Working Pressure at 73.4° F)						
Nom. Size Steel x HDPE (IPS)	X Inches	Y Inches	D Inches	d Inches	Z Inches	Item Code
2" x 2"	9.27	5.83	2.38	1.81	2.64	TI-TH0200-9
3" x 3"	12.05	6.81	3.50	2.67	3.76	TI-TH0300-9
4" x 4"	11.83	7.40	4.50	3.44	4.74	TI-TH0400-9

SDR 7 (Standard Dimension Ratio) based on 335 PSI (Working Pressure at 73.4° F)						
Nom. Size Steel x HDPE (IPS)	X Inches	Y Inches	D Inches	d Inches	Z Inches	Item Code
2" x 2"	9.27	5.83	2.38	1.66	2.64	TI-TH0200-7
3" x 3"	12.05	6.81	3.50	2.44	3.76	TI-TH0300-7
4" x 4"	11.83	7.40	4.50	3.14	4.74	TI-TH0400-7





IntegriFuse Standard NPT Transition Fitting

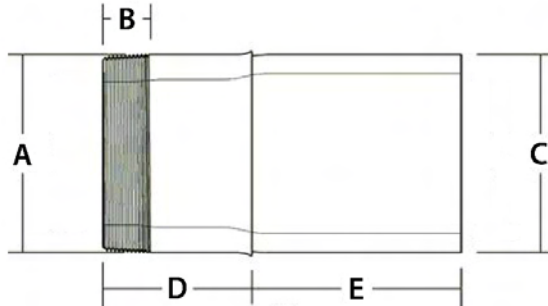

SDR 7, 9 or 11 Pipe. Fittings available in Epoxy Coated Carbon Steel, 304 Stainless Steel and 316 Stainless Steel.

Male (MIPT) NPT Transitions

Nominal IPS Pipe Size	A inches	B inches	C inches	D inches	E inches	Item Code
¾"	1.25	0.70	1.05	1.80	6.20	T-MPT-0075
1"	1.32	0.99	1.32	2.00	6.00	T-MPT-0100
1 ¼"	1.66	1.01	1.66	2.60	5.40	T-MPT-0125
1 ½"	1.90	1.03	1.90	2.60	5.40	T-MPT-0150
2"	2.39	1.06	2.39	3.00	5.00	T-MPT-0200
3"	3.50	1.26	3.50	4.00	4.00	T-MPT-0300
4"	4.50	1.48	4.50	4.00	8.00	T-MPT-0400





IntegriFuse Standard NPT Transition Fitting

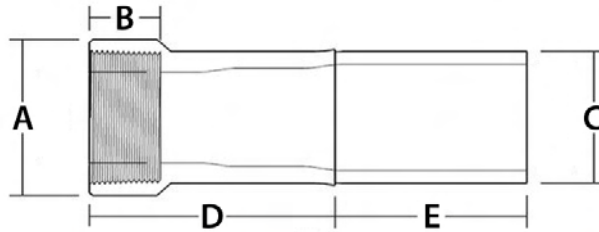

SDR 7, 9 or 11 Pipe. Fittings available in Epoxy Coated Carbon Steel, 304 Stainless Steel and 316 Stainless Steel.

Female (FIPT) NPT Transitions

Nominal IPS Pipe Size	A inches	B inches	C inches	D inches	E inches	Item Code
¾"	1.24	0.70	1.05	1.80	6.90	T-FPT-0075
1"	1.49	0.91	1.32	2.00	6.91	T-FPT-0100
1 ¼"	1.90	0.89	1.66	2.60	6.29	T-FPT-0125
1 ½"	2.25	0.85	1.9	3.00	5.85	T-FPT-0150
2"	2.75	1.00	2.38	4.00	5.00	T-FPT-0200
3"	4.14	1.62	3.5	4.38	5.62	T-FPT-0300
4"	5.16	1.88	4.5	4.62	5.88	T-FPT-0400



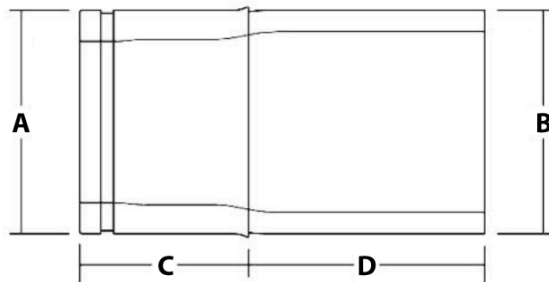

SDR 7, 9 11 or 17 Pipe. Fittings available in Epoxy Coated Carbon Steel

Grooved Transitions

Nominal IPS Pipe Size	A inches	B inches	C inches	D inches	Item Code
3"	3.50	3.50	2.83	4.00	T-GR-03
4"	4.50	4.50	3.63	4.00	T-GR-04
6"	6.63	6.63	5.35	8.00	T-GR-06
8"	8.63	8.63	6.96	8.00	T-GR-08
10"	10.75	10.75	8.68	8.00	T-GR-10
12"	12.75	12.75	10.29	9.00	T-GR-12





IntegriFuse™

Polyethylene Ball Valves



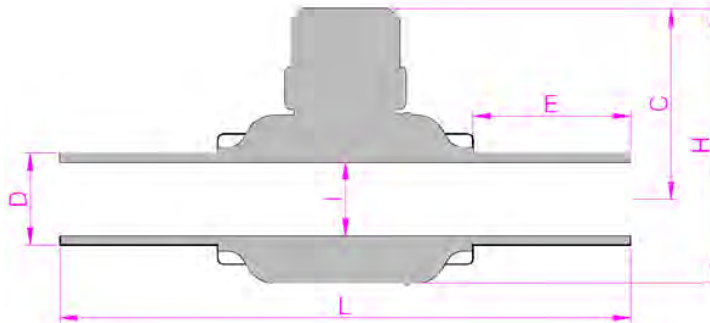
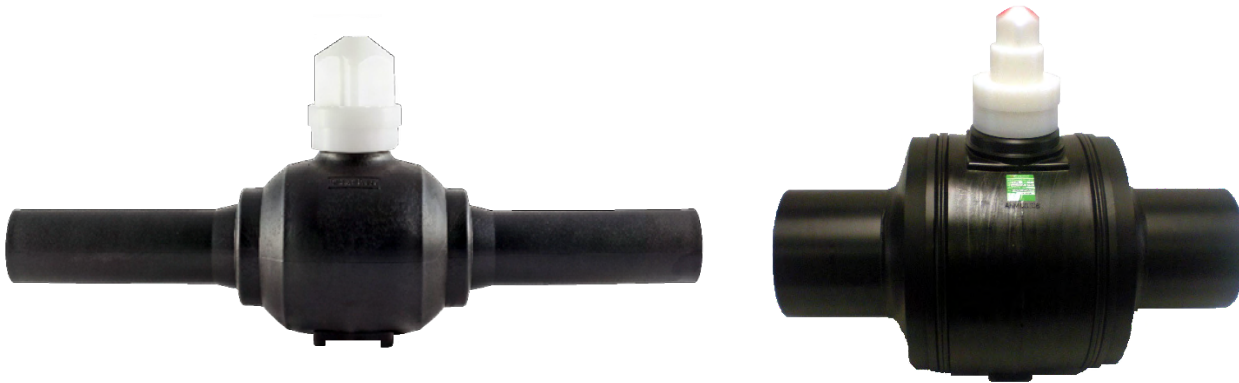

Small Valve Sizes and Dimensions with 2" Operating Nut
Black or Yellow Valves Available

Nominal Valve Size	Port	PE Wall SDR	Normal OD "D"	Min W/T	L	H	C	I	E	CV	Weight lbs.
¾" IPS	Full	SDR 11	1.05	.095	11.50	5.12	3.70	1.06	3.62	32	1.06
1" IPS	Full	SDR 11	1.32	.119	11.50	5.12	3.70	1.06	3.62	50	1.06
1 ¼" IPS	Reduced	SDR 11	1.66	.151	11.50	5.12	3.70	1.06	3.62	79	1.08
1 ½" IPS	Reduced	SDR 11	1.90	.173	11.81	5.51	3.78	1.26	3.15	104	1.74
2" IPS	Full	SDR 11	2.38	.216	19.53	9.65	7.01	1.77	6.69	164	4.63
3" IPS	Full	SDR 11	3.50	.318	21.18	11.81	8.50	2.52	6.69	375	8.82
4" IPS	Full	SDR 11	4.50	.409	24.02	14.92	10.39	3.58	6.69	591	18.74
6" IPS	Full	SDR 11	6.63	.602	26.18	18.94	13.03	4.80	6.69	1280	39.90
8" IPS	Full	SDR 11	8.63	.784	30.12	24.80	16.57	6.69	6.69	2146	91.71

Valves meet ASTM D 2513 requirements, ISO 9001, and are manufactured with materials that are approved for water contact as defined by NSF



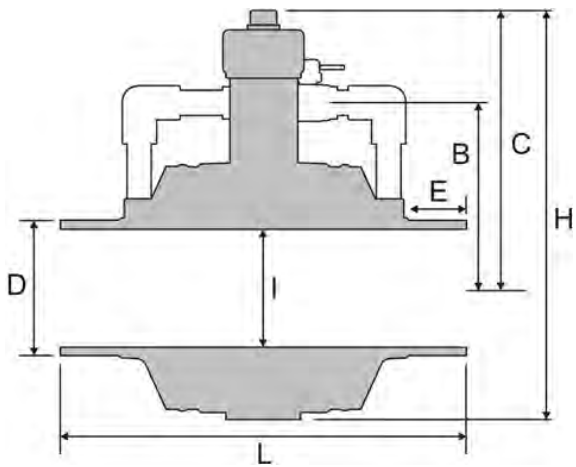

STANDARD 10" IPS Full Port Through 16" IPS PE VALVES Short Gear Actuator & Differential Bypass Assembly

Nominal Valve Size	Port	PE Wall SDR	Normal OD "D"	Min W/T	L	H	C	B	I	E	CV	Weight lbs.
10 IPS	Full	SDR 11	10.750	.977	30.12	31.89	23.66	N/A	7.95	7.09	3074	103.13
12 IPS	Full	SDR 11	12.750	1.159	38.50	38.58	26.16	17.36	11.38	5.71	4746	263.45
14 IPS	Full	SDR 11	14.000	1.273	35.83	38.58	26.16	17.56	11.38	5.71	5736	226.09
16 IPS	Reduced	SDR 11	16.000	1.455	35.83	38.58	26.16	18.23	11.38	5.71	6559	274.91

10" Valves do not include the Differential Bypass Assembly.

Valves meet ASTM D 2513 requirements, ISO 9001, and are manufactured with materials that are approved for water contact as defined by NSF



IntegriFuse™

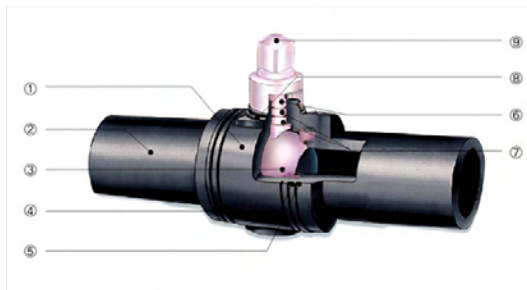

Number	Component	Material	Features
1	Body	Polyethylene	PE4710/PE100, PE 2406
2	End	Polyethylene	PE4710/PE100, or PE 2406
3	Ball	Acetal / Polypropylene*	Excellent Strength & Thermal Resistance
4	Retainer	Polypropylene	Positive seal under any condition. Retains seat under high differential pressure
5	Ball Seat	Nitrile (HNBR)	Reliable sealing from -20° F to 140° F
6	Stem	Acetal	Excellent durability & strength
7	Stem Seal	Nitrile (HNBR)	Redundant sealing with dual O-rings
8	Weather Seal	Nitrile (HNBR)	Protects from ground water and dirt
9	Operating Nut	Polypropylene	2 inch (50mm) square or hexagon
10	Purge Connector	Polyethylene	Integral easy purge connection

Note: The IntegriFuse valve utilizes a specially compounded Nitrile (HNBR) seal, unique in the industry. HNBR = Hydrogenated Nitrile rubber, known for its excellent high temperature performance, tensile strength, as well as high resistance to fuels, oils, solvents, and ozone.

2" IPS Reduced Port valves and smaller—Acetal 2" IPS Full Port valves and larger—Polypropylene

Item	Operating Feature
Designed/Tested	Valves meet ASTM D 2513 requirements, ISO 9001, and are manufactured with materials that are approved for water contact as defined by NSF
Materials	PE4710/PE100 Black SDR 11 rated @ 100 PSI for gas & 200 PSI for water PE2406 Yellow SDR 11 rated @ 80 PSI for gas
Temperature	From -20° F to 140° F (-20° C to 60° C)
Bore	Reduced and Full Port
Pipe Connection	Butt Fusion
Valve Boxes	IntegriFuse valves are supported by all the leading valve box manufacturers

Hydrostatic Strength Test

TEMP: 74° F	TEMP 100° F	TEMP: 176° F
1000 Hours	1000 Hours	170 Hours
265 PSI	214 PSI	136 PSI



IntegriFuse™

Equipment & Tools



Electrofusion Processor



Socket Fusion Kit



Scraper Tools



Re-Rounding Tools

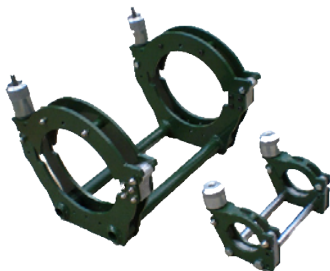

Alignment Clamps

Rechargeable Pipe Cutters





Electrofusion Processor



Fusion Capacity	Scanner	Supply Voltage	Output Voltage	Item Code
1/2" - 63" Electrofusion Fittings	SmartScan	120 V	8 VAC to 48 VAC	INT-EFP-SS
1/2" - 63" Electrofusion Fittings	SmartScan with GPS	120 V	8 VAC to 48 VAC	INT-EFP-GPS

Fuses All Brands and Sizes of Universally Barcoded Electrofusion Fittings



Socket Fusion Kit



Size	Supply Voltage	Temp Control	Screen Type	Item Code
1/2" - 2" IPS	110 V / 60 Hz	Adjustable	Digital	SCKTKT-INT052



IntegriFuse™

Scraper Tools



Model	Size	Item Code
INT-052	1/2" IPS - 2" IPS	SCR-INT-052
INT-36	3" IPS - 6" DIPS	SCR-INT-36
INT-816	8" IPS - 16" DIPS	SCR-INT-816
INT-1832	18" IPS - 32" IPS	SCR-INT-1832

IntegriFuse™

Re-Rounding Tools



Size	Inserts	Type	Item Code
63" IPS	Master	Hydraulic	RRC-INT-63
54" IPS	Master	Hydraulic	RRC-INT-54
48" IPS	Master	Hydraulic	RRC-INT-48
36" DIPS	36" IPS, 34" IPS	Hydraulic	RRC-INT-36
32" IPS/30" DIPS	30" IPS, 28" IPS	Hydraulic	RRC-INT-32
24" DIPS	24" IPS, 22" DIPS, 20" DIPS, 20" IPS	Hydraulic	RRC-INT-24
18" DIPS	18" IPS, 16" DIPS, 16" IPS, 14" DIPS, 14" IPS	Hydraulic	RRC-INT-18
12" DIPS	12" IPS, 10" DIPS, 10" IPS, 8" DIPS, 8" IPS	Manual	RRC-INT-12



Most Sizes Also
Available for Rental

IntegriFuse™

Alignment Clamps



Size	Inserts	Type	Item Code
6" IPS	6" x 5", 6" x 4"	Manual	ALC-INT-6
4" IPS	4" x 3" Master, 4" x 2" Master (1 1/2", 1 1/4", 1", 3/4", 1/2")	Manual	ALC-INT-4
3" IPS	3" x 2" Master (1.5", 1.25", 1", .75", .5")	Manual	ALC-INT-3
2" IPS	1 1/2", 1 1/4", 1", 3/4", 1/2"	Manual	ALC-INT-2

IntegriFuse™

Rechargeable Pipe Cutter



Cutting Range	Supply Voltage	Speed	Battery Type	Item Code
1/2" - 1 1/4"	9.6 V	4-5 Seconds per Cut	Rechargeable	RPC-INT-1



The logo features a stylized green circular emblem composed of several concentric, slightly offset rings, creating a sense of depth and movement. To the right of this emblem, the word "INTEGRITY" is written in a large, bold, black serif font. Below "INTEGRITY", the words "Fusion Products, Inc." are written in a smaller, black serif font.

INTEGRITY Fusion Products, Inc.

Service

Customer service is a priority for Integrity Fusion Products. We are here to serve you. Your phone call and email inquires are answered directly and promptly by one of our sales team members.

Integrity Fusion Products offers the largest range of HDPE fittings inventory in the country. Unmatched products and quantities are in stock and ready to ship. Our warehouse houses a full line and deep quantities of HDPE butt fusion, socket fusion, transitions, poly ball valves, electrofusion fittings and equipment.

Integrity Fusion Products provides top quality products to you and your customer in a timely manner. Most orders ship within 24 hours. With a wide range of shipping options at our service, your products can be delivered how, when, and where you need them.

Innovation

New product development has always been part of our company culture. We listen to our customers and we strive to exceed their expectations by developing new and innovative products that offer solutions to these industry challenges. A few examples of this is our industry exclusive Molded Butt Reducing Tees, unique one step reducer sizes, size on size electrofusion branch saddles, electrofusion fittings up to 63" and high pressure electrofusion fittings up to 480 PSI. Additional new products are currently in development as we work hard to help the HDPE market segment grow.

Integrity

In 2006, when Doug Yelken started Integrity Fusion Products, Inc. the company name was very intentional in both name and a philosophy for doing business. Our goal is that each of our employees acts with integrity in both their work and personal lives. In addition, the products we manufacture are produced with integrity and are among the best in the industry. By selecting the highest quality resin available in the market, and utilizing the most modern and innovative production and quality control practices, we can proudly say that we are "INTEGRITY".

INTEGRITY Fusion Products, Inc.



IntegriFuseTM

Integrity Fusion Products, Inc.

P.O. Box 142607

215 Robinson Drive

Fayetteville, GA 30214

(P) 770-632-7530 (F) 770-632-7540

Info@IntegrityFusion.com

www.IntegrityFusion.com

Integrity Catalog v2.0 - IntegriFuse

Water | Gas Utility | Oil & Gas | Mining | Landfill | Geothermal | Industrial