

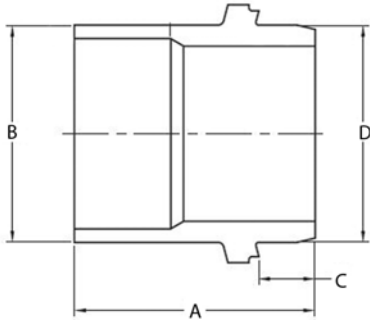

## Molded Butt Fusion MJ Adapter - IPS



SDR 9 (Standard Dimension Ratio) 255 PSI (Working Pressure at 73.4° F)

SDR 11 (Standard Dimension Ratio) 200 PSI (Working Pressure at 73.4° F)

with or without SS Stiffeners

Nominal Size	SDR	A	B	C	D	Weight	Item Code With SS / 20Without
2" IPS	9	8.00"	2.375"	2.34"	2.375"	2.0 lbs.	100503 / 100501
2" IPS	11	8.00"	2.375"	2.34"	2.375"	1.9 lbs.	100502 / 100500
3" IPS	9	9.00"	3.500"	2.34"	3.960"	2.4 lbs.	100507 / 100505
3" IPS	11	9.00"	3.500"	2.34"	3.960"	2.1 lbs.	100506 / 100504
4" IPS	9	10.25"	4.500"	2.34"	4.800"	3.4 lbs.	100515 / 100513
4" IPS	11	10.25"	4.500"	2.34"	4.800"	3.0 lbs.	100514 / 100512
6" IPS	9	11.31"	6.625"	2.34"	6.900"	7.0 lbs.	100523 / 100521
6" IPS	11	11.31"	6.625"	2.34"	6.900"	6.3 lbs.	100522 / 100520
8" IPS	9	11.94"	8.625"	2.34"	9.050"	12.7 lbs.	100531 / 100529
8" IPS	11	11.94"	8.625"	2.34"	9.050"	11.1 lbs.	100530 / 100528
10" IPS	9	13.56"	10.750"	2.34"	11.100"	20.9 lbs.	100539 / 100537
10" IPS	11	13.56"	10.750"	2.34"	11.100"	18.1 lbs.	100538 / 100536
12" IPS	9	13.00"	12.750"	2.34"	13.200"	28.0 lbs.	100547 / 100545
12" IPS	11	13.00"	12.750"	2.34"	13.200"	24.2 lbs.	100546 / 100544
14" IPS	11	13.00"	14.000"	1.75"	15.300"	35.3 lbs.	100551 / 100550
16" IPS	11	13.00"	16.000"	1.75"	17.400"	40.8 lbs.	100555 / 100554
18" IPS	11	13.00"	18.000"	1.75"	19.500"	51.1 lbs.	100559 / 100558
20" IPS	11	15.22"	20.000"	2.54"	21.600"	72.8 lbs.	100563 / 100562
24" IPS	11	16.73"	24.000"	2.67"	25.800"	109.8 lbs.	100567 / 100566



## Molded Butt Fusion MJ Adapter - DIPS

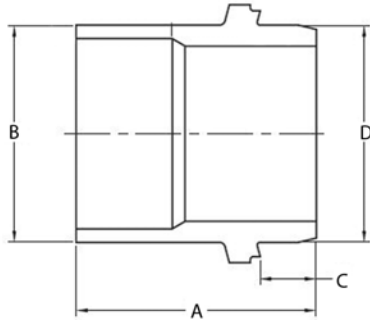

SDR 9 (Standard Dimension Ratio) 255 PSI (Working Pressure at 73.4° F)

SDR 11 (Standard Dimension Ratio) 200 PSI (Working Pressure at 73.4° F)

with or without SS Stiffeners

Nominal Size	SDR	A	B	C	D	Weight	Item Code With SS / Without
4" DIPS	9	10.25"	4.800"	2.34"	4.800"	3.5 lbs.	100511 / 100509
4" DIPS	11	10.25"	4.800"	2.34"	4.800"	3.2 lbs.	100510 / 100508
6" DIPS	9	11.31"	6.900"	2.34"	6.900"	7.7 lbs.	100519 / 100517
6" DIPS	11	11.31"	6.900"	2.34"	6.900"	6.8 lbs.	100518 / 100516
8" DIPS	9	11.94"	9.050"	2.34"	9.050"	13.0 lbs.	100527 / 100525
8" DIPS	11	11.94"	9.050"	2.34"	9.050"	11.3 lbs.	100526 / 100524
10" DIPS	9	13.56"	11.100"	2.34"	11.100"	22.1 lbs.	100535 / 100533
10" DIPS	11	13.56"	11.100"	2.34"	11.100"	19.9 lbs.	100534 / 100532
12" DIPS	9	13.00"	13.200"	2.34"	13.200"	30.2 lbs.	100543 / 100541
12" DIPS	11	13.00"	13.200"	2.34"	13.200"	25.9 lbs.	100542 / 100540
14" DIPS	11	14.00"	15.300"	2.22"	15.300"	33.1 lbs.	100549 / 100548
16" DIPS	11	14.00"	17.400"	2.22"	17.400"	44.1 lbs.	100553 / 100552
18" DIPS	11	15.22"	19.500"	2.63"	19.500"	66.2 lbs.	100557 / 100556
20" DIPS	11	15.22"	21.600"	2.63"	21.600"	94.8 lbs.	100561 / 100560
24" DIPS	11	15.22"	25.800"	2.63"	25.800"	132.3 lbs.	100565 / 100564



## MJ Adapter Accessory Kit



MJ Accessory Kits (Gland, Gasket, and Bolts) for IPS or DIPS

Nominal Size	Type	Bolt Size	Number of Bolts	Weight lbs.	Item Code
2"	C153	5/8" x 5"	2	6.1 lbs.	100568
3"	C153	5/8" x 4.5"	4	6.7 lbs.	100569
4"	C153	3/4" x 4.5"	4	7.4 lbs.	100570
6"	C153	3/4" x 5"	6	11.2 lbs.	100571
8"	C153	3/4" x 6"	6	12.4 lbs.	100572
10"	C153	3/4" x 6"	8	17.6 lbs.	100573
12"	C153	3/4" x 6"	8	19.5 lbs.	100574
14"	C153	3/4" x 7"	10	24.7 lbs.	100575
16"	C153	3/4" x 7"	12	30.8 lbs.	100576
18"	C153	3/4" x 7"	12	41.0 lbs.	100577
20"	C153	3/4" x 7"	14	50.9 lbs.	100578
24"	C153	3/4" x 7"	16	68.1 lbs.	100579



## HDPE Fittings Specifications

IntegriFuse fittings are manufactured from 0% recycled materials with black high density bimodal polyethylene copolymer designed for use in, but not limited to, potable water, natural gas, industrial, landfill, oil & gas, and mining applications.

Fittings meet AWWA and ASTM-D2513 & ASTM-D3261 requirements.  
IntegriFuse fittings are manufactured with resin having a material designation code of PE 3408, PE3608, PE 4710, and PE 100.

Physical Properties	Metric	English	Comments
Density	.959 g/cm <sup>3</sup>	0.0346 lb/in	Black: ASTM D4883
Environmental Stress Crack Resistance	>= 5000 hour	>= 5000 hour	Condition C; ASTM D1693
Carbon Black Loading	2.30%	2.30%	ASTM D1603
Melt Flow	8.00 g/10 min @Load 21.6 kg, Temperature 190 °C	8.00 g/10 min @Load 47.6 lb, Temperature 374 °F	ASTM D1238
Mechanical Properties	Metric	English	Comments
PENT	>= 10000 hour	>= 10000 hour	Notched Tensile; ASTM F1473
Hardness, Shore D	66.0	66.0	ASTM D2240
Tensile Strength at Break	37.9 MPa	5500 PSI	2 in/min; ASTM D638
Tensile Strength Yield	24.99 MPa	3625 PSI	2 in/min; ASTM D638
Elongation at Break	>= 600%	>= 600%	2 in/min; ASTM D638
Flexural Modulus	1.03 GPa	150 KSI	2% Secant-Method; ASTM D790
Izod Impact, Notched	4.81 J/cm	9.00 ft-lb/in	ASTM D256
Hydrostatic Design Basis	6.89 MPa	1000 PSI	At 60 °C; ASTM D2837
	11.0 MPa	1600 PSI	Room Temp; ASTM D2837
Thermal Properties	Metric	English	Comments
Vicat Softening Point	126 °C	259 °F	ASTM D1525
Brittleness Temperature	,= -118 °C	<= -180 °F	ASTM D746
Decomposition Temperature	>= 220 °C	>= 428 °F	Thermal Stability; ASTM D2513
Descriptive Properties	Metric	English	Comments
Cell Classification		445574C	ASTM D3350
Process		Injection Molding	