

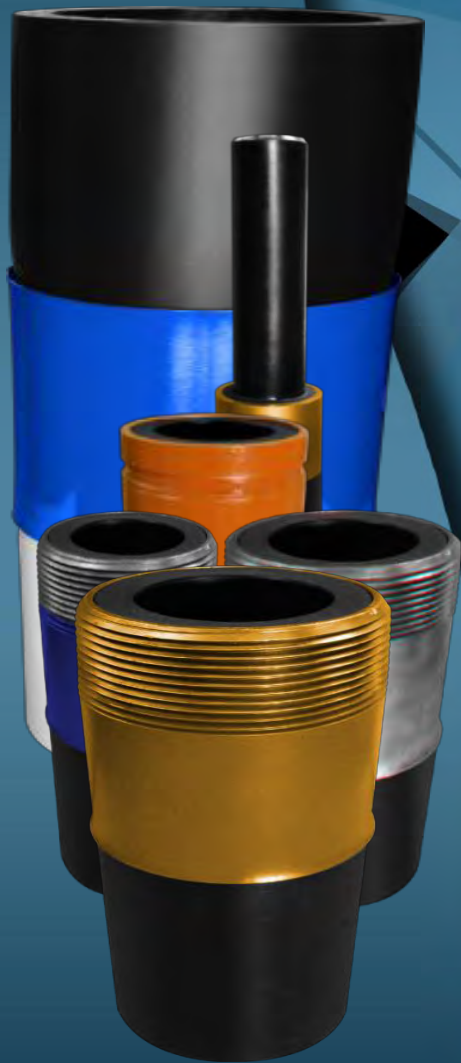

You can trust Premium.

801-963-2663



Premium HDPE Products

TABLE OF CONTENTS

Click page number for easy navigation between pages.

HDPE Transitions

Grooved - A53B Painted	<u>3</u>
Grooved - A53B Powder Coated	<u>4</u>
Grooved - 304 Stainless Steel	<u>5</u>
Grooved - 316 Stainless Steel	<u>6</u>
Male Pipe Thread - A53B Painted	<u>7</u>
Male Pipe Thread - A53B Powder Coated	<u>8</u>
Male Pipe Thread - 304 Stainless Steel	<u>9</u>
Male Pipe Thread - 316 Stainless Steel	<u>10</u>
Male Pipe Thread - Brass	<u>11</u>
PVC x HDPE (Sch 40 - Painted CS Body)	<u>12</u>
PVC x HDPE (Sch 40 - Epoxy CS Body)	<u>13</u>
PVC x HDPE (Sch 40 - 304 Stainless Body)	<u>14</u>
PVC x HDPE (Sch 40 - 316 Stainless Body)	<u>15</u>
PVC x HDPE (Sch 80 - Painted CS Body)	<u>16</u>
PVC x HDPE (Sch 80 - Epoxy CS Body)	<u>17</u>
PVC x HDPE (Sch 80 - 304 Stainless Body)	<u>18</u>
PVC x HDPE (Sch 80 - 316 Stainless Body)	<u>19</u>
Butt Weld - A53B Painted	<u>20</u>
Butt Weld - A53B Powder Coated	<u>21</u>
Butt Weld - A106B Painted	<u>22</u>
Butt Weld - A106B Powder Coated	<u>23</u>
Butt Weld - 304 Stainless Steel	<u>24</u>
Butt Weld - 316 Stainless Steel	<u>25</u>

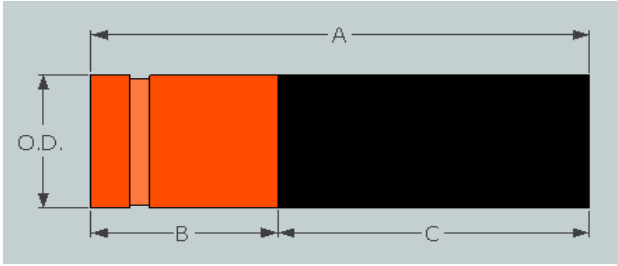

RAW MATERIAL SPECIFICATIONS	
POLY PIPE	High Density Polyethylene PE3408/4710
METALLIC PIPE	Carbon Steel A53 Grade B
FINISH	Industrial Strength Paint "ORANGE"

FINISHED PRODUCT SPECIFICATIONS	
ASTM D1599, D1598, D3350 Category 3	

STANDARD STOCK SIZES / PRESSURE RATINGS					
Size Range	3/4" - 20" IPS				
SDR	7	9	11	17	SDR
PSI	336	252	202	126	PSI

Other O.D's, SDR's and Pressure Ratings available upon Request.
 This transition can be converted to Category 1 upon request
 (Additional charges apply)

Code	Nominal Pipe Size	O.D. (inch)	DIMENSIONAL DATA					WEIGHT PER EACH			
			A	B	C	D	E	SDR-7	SDR-9	SDR-11	SDR-17
007	3/4"	1.050	6.00	2.00	4.00			0.86	0.76	0.79	0.79
010	1"	1.315	6.00	2.50	3.50			0.87	0.84	0.88	0.88
012	1-1/4"	1.660	6.00	2.50	3.50			0.60	0.56	0.53	0.53
015	1-1/2"	1.900	6.00	3.00	3.00			0.76	0.70	0.66	0.77
020	2"	2.370	8.00	4.00	4.00			1.38	1.26	1.07	0.97
030	3"	3.500	8.00	4.00	4.00			3.42	3.16	2.98	2.68
040	4"	4.500	8.00	5.00	3.00			5.23	4.79	4.50	4.00
060	6"	6.625	13.00	7.00	6.00			15.06	13.54	10.44	9.35
080	8"	8.625	15.00	8.00	7.00			30.67	27.68	24.25	19.33
100	10"	10.750	16.00	9.00	7.00			51.42	46.45	41.99	36.63
120	12"	12.750	18.00	9.00	9.00			80.46	72.63	64.23	56.19
140	14"	14.000	20.00	10.00	10.00			102.54	92.03	81.20	70.29
160	16"	16.000	22.00	14.00	8.00			146.65	131.50	116.45	100.62
180	18"	18.000	30.00	16.00	14.00			254.55	228.48	186.44	164.42
200	20"	20.000	32.00	18.00	14.00			344.80	310.44	279.57	242.44
240	24"	24.000									

Warranty / Insurance Information:

All products manufactured shall be free from defects in material and workmanship under normal use and service within limitation. If a product is believed to be defective and on examination by the Quality Assurance department discovers this is the case the product will be repaired or replaced at no cost. General Liability coverage is provided for bodily injury and property damage arising out of products sold or distributed or out of operations performed for someone else after the operations have been completed.

QUALITY ASSURANCE:

QMS2013-01 Revision A (comparable with ANSI ISO/ASQ Q9001-2000)

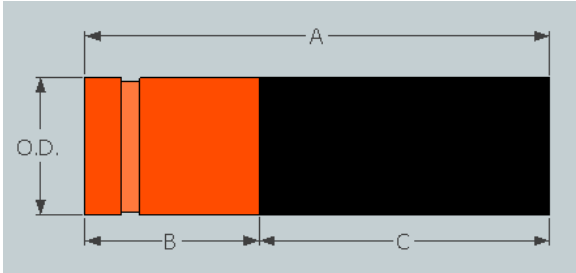

RAW MATERIAL SPECIFICATIONS	
POLY PIPE	High Density Polyethylene PE3408/4710
METALLIC PIPE	Carbon Steel A53 Grade B
FINISH	Epoxy Coated "ORANGE"

FINISHED PRODUCT SPECIFICATIONS	
ASTM D1599, D1598, D3350 Category 3	

STANDARD STOCK SIZES / PRESSURE RATINGS					
Size Range	3/4" - 20" IPS				
SDR	7	9	11	17	SDR
PSI	336	252	202	126	PSI

Other O.D's, SDR's and Pressure Ratings available upon Request.
 This transition can be converted to Category 1 upon request
 (Additional charges apply)

Code	Nominal Pipe Size	O.D. (inch)	DIMENSIONAL DATA					WEIGHT PER EACH			
			A	B	C	D	E	SDR-7	SDR-9	SDR-11	SDR-17
007	3/4"	1.050	6.00	2.00	4.00			0.86	0.76	0.79	0.79
010	1"	1.315	6.00	2.50	3.50			0.87	0.84	0.88	0.88
012	1-1/4"	1.660	6.00	2.50	3.50			0.60	0.56	0.53	0.53
015	1-1/2"	1.900	6.00	3.00	3.00			0.76	0.70	0.66	0.77
020	2"	2.370	8.00	4.00	4.00			1.38	1.26	1.07	0.97
030	3"	3.500	8.00	4.00	4.00			3.42	3.16	2.98	2.68
040	4"	4.500	8.00	5.00	3.00			5.23	4.79	4.50	4.00
060	6"	6.625	13.00	7.00	6.00			15.06	13.54	10.44	9.35
080	8"	8.625	15.00	8.00	7.00			30.67	27.68	24.25	19.33
100	10"	10.750	16.00	9.00	7.00			51.42	46.45	41.99	36.63
120	12"	12.750	18.00	9.00	9.00			80.46	72.63	64.23	56.19
140	14"	14.000	20.00	10.00	10.00			102.54	92.03	81.20	70.29
160	16"	16.000	22.00	14.00	8.00			146.65	131.50	116.45	100.62
180	18"	18.000	30.00	16.00	14.00			254.55	228.48	186.44	164.42
200	20"	20.000	32.00	18.00	14.00			344.80	310.44	279.57	242.44
240	24"	24.000									

Warranty / Insurance Information:

All products manufactured shall be free from defects in material and workmanship under normal use and service within limitation. If a product is believed to be defective and on examination by the Quality Assurance department discovers this is the case the product will be repaired or replaced at no cost. General Liability coverage is provided for bodily injury and property damage arising out of products sold or distributed or out of operations performed for someone else after the operations have been completed.

QUALITY ASSURANCE:

QMS2013-01 Revision A (comparable with ANSI ISO/ASQ Q9001-2000)

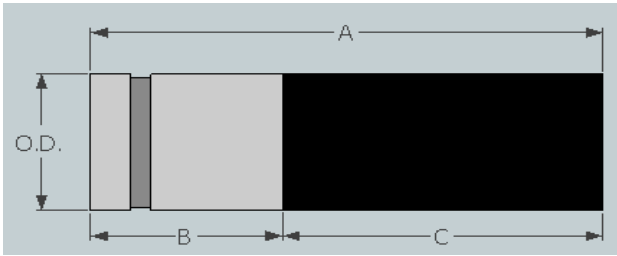

RAW MATERIAL SPECIFICATIONS	
POLY PIPE	High Density Polyethylene PE3408/4710
METALLIC PIPE	304 Stainless Steel
FINISH	Plain

FINISHED PRODUCT SPECIFICATIONS	
ASTM D1599, D1598, D3350 Category 3	

STANDARD STOCK SIZES / PRESSURE RATINGS					
Size Range	3/4" - 20" IPS				
SDR	7	9	11	17	SDR
PSI	336	252	202	126	PSI

Other O.D's, SDR's and Pressure Ratings available upon Request.
 This transition can be converted to Category 1 upon request
 (Additional charges apply)

Code	Nominal Pipe Size	O.D. (inch)	DIMENSIONAL DATA					WEIGHT PER EACH			
			A	B	C	D	E	SDR-7	SDR-9	SDR-11	SDR-17
007	3/4"	1.050	6.00	2.00	4.00			0.86	0.76	0.79	0.79
010	1"	1.315	6.00	2.50	3.50			0.87	0.84	0.88	0.88
012	1-1/4"	1.660	6.00	2.50	3.50			0.60	0.56	0.53	0.53
015	1-1/2"	1.900	6.00	3.00	3.00			0.76	0.70	0.66	0.77
020	2"	2.370	8.00	4.00	4.00			1.38	1.26	1.07	0.97
030	3"	3.500	8.00	4.00	4.00			3.42	3.16	2.98	2.68
040	4"	4.500	8.00	5.00	3.00			5.23	4.79	4.50	4.00
060	6"	6.625	13.00	7.00	6.00			15.06	13.54	10.44	9.35
080	8"	8.625	15.00	8.00	7.00			30.67	27.68	24.25	19.33
100	10"	10.750	16.00	9.00	7.00			51.42	46.45	41.99	36.63
120	12"	12.750	18.00	9.00	9.00			80.46	72.63	64.23	56.19
140	14"	14.000	20.00	10.00	10.00			102.54	92.03	81.20	70.29
160	16"	16.000	22.00	14.00	8.00			146.65	131.50	116.45	100.62
180	18"	18.000	30.00	16.00	14.00			254.55	228.48	186.44	164.42
200	20"	20.000	32.00	18.00	14.00			344.80	310.44	279.57	242.44
240	24"	24.000									

Warranty / Insurance Information:

All products manufactured shall be free from defects in material and workmanship under normal use and service within limitation. If a product is believed to be defective and on examination by the Quality Assurance department discovers this is the case the product will be repaired or replaced at no cost. General Liability coverage is provided for bodily injury and property damage arising out of products sold or distributed or out of operations performed for someone else after the operations have been completed.

QUALITY ASSURANCE:

QMS2013-01 Revision A (comparable with ANSI ISO/ASQ Q9001-2000)

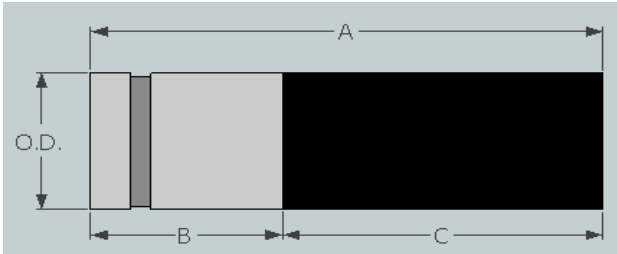

RAW MATERIAL SPECIFICATIONS	
POLY PIPE	High Density Polyethylene PE3408/4710
METALLIC PIPE	316 Stainless Steel
FINISH	Plain

FINISHED PRODUCT SPECIFICATIONS	
ASTM D1599, D1598, D3350 Category 3	

STANDARD STOCK SIZES / PRESSURE RATINGS					
Size Range	3/4" - 20" IPS				
SDR	7	9	11	17	SDR
PSI	336	252	202	126	PSI

Other O.D's, SDR's and Pressure Ratings available upon Request.

This transition can be converted to Category 1 upon request

[Additional charges apply]

Code	Nominal Pipe Size	O.D. (inch)	DIMENSIONAL DATA					WEIGHT PER EACH			
			A	B	C	D	E	SDR-7	SDR-9	SDR-11	SDR-17
007	3/4"	1.050	6.00	2.00	4.00			0.86	0.76	0.79	0.79
010	1"	1.315	6.00	2.50	3.50			0.87	0.84	0.88	0.88
012	1-1/4"	1.660	6.00	2.50	3.50			0.60	0.56	0.53	0.53
015	1-1/2"	1.900	6.00	3.00	3.00			0.76	0.70	0.66	0.77
020	2"	2.370	8.00	4.00	4.00			1.38	1.26	1.07	0.97
030	3"	3.500	8.00	4.00	4.00			3.42	3.16	2.98	2.68
040	4"	4.500	8.00	5.00	3.00			5.23	4.79	4.50	4.00
060	6"	6.625	13.00	7.00	6.00			15.06	13.54	10.44	9.35
080	8"	8.625	15.00	8.00	7.00			30.67	27.68	24.25	19.33
100	10"	10.750	16.00	9.00	7.00			51.42	46.45	41.99	36.63
120	12"	12.750	18.00	9.00	9.00			80.46	72.63	64.23	56.19
140	14"	14.000	20.00	10.00	10.00			102.54	92.03	81.20	70.29
160	16"	16.000	22.00	14.00	8.00			146.65	131.50	116.45	100.62
180	18"	18.000	30.00	16.00	14.00			254.55	228.48	186.44	164.42
200	20"	20.000	32.00	18.00	14.00			344.80	310.44	279.57	242.44
240	24"	24.000									

Warranty / Insurance Information:

All products manufactured shall be free from defects in material and workmanship under normal use and service within limitation. If a product is believed to be defective and on examination by the Quality Assurance department discovers this is the case the product will be repaired or replaced at no cost. General Liability coverage is provided for bodily injury and property damage arising out of products sold or distributed or out of operations performed for someone else after the operations have been completed.

QUALITY ASSURANCE:

QMS2013-01 Revision A [comparable with ANSI ISO/ASQ G9001-2000]

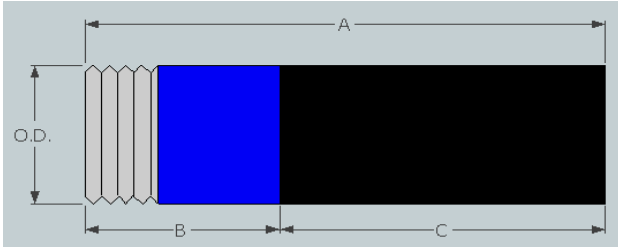

RAW MATERIAL SPECIFICATIONS	
POLY PIPE	High Density Polyethylene PE3408/4710
METALLIC PIPE	Carbon Steel A53 Grade B
FINISH	Industrial Strength Paint "Blue"

FINISHED PRODUCT SPECIFICATIONS	
ASTM D1599, D1598, D3350 Category 3	

STANDARD STOCK SIZES / PRESSURE RATINGS					
Size Range	3/4" - 12" IPS				
SDR	7	9	11	17	SDR
PSI	336	252	202	126	PSI

Other O.D's, SDR's and Pressure Ratings available upon Request.
 This transition can be converted to Category 1 upon request
 (Additional charges apply)

Code	Nominal Pipe Size	O.D. (inch)	DIMENSIONAL DATA					WEIGHT PER EACH			
			A	B	C	D	E	SDR-7	SDR-9	SDR-11	SDR-17
007	3/4"	1.050	6.00	2.00	4.00			0.86	0.76	0.79	0.79
010	1"	1.315	6.00	2.50	3.50			0.87	0.84	0.88	0.88
012	1-1/4"	1.660	6.00	2.50	3.50			0.60	0.56	0.53	0.53
015	1-1/2"	1.900	6.00	3.00	3.00			0.76	0.70	0.66	0.77
020	2"	2.370	8.00	4.00	4.00			1.38	1.26	1.07	0.97
030	3"	3.500	8.00	4.00	4.00			3.42	3.16	2.98	2.68
040	4"	4.500	8.00	5.00	3.00			5.23	4.79	4.50	4.00
060	6"	6.625	13.00	7.00	6.00			15.06	13.54	10.44	9.35
080	8"	8.625	15.00	8.00	7.00			30.67	27.68	24.25	19.33
100	10"	10.750	16.00	9.00	7.00			51.42	46.45	41.99	36.63
120	12"	12.750	18.00	9.00	9.00			80.46	72.63	64.23	56.19
140	14"	14.000									
160	16"	16.000									
180	18"	18.000									
200	20"	20.000									
240	24"	24.000									

Warranty / Insurance Information:

All products manufactured shall be free from defects in material and workmanship under normal use and service within limitation. If a product is believed to be defective and on examination by the Quality Assurance department discovers this is the case the product will be repaired or replaced at no cost. General Liability coverage is provided for bodily injury and property damage arising out of products sold or distributed or out of operations performed for someone else after the operations have been completed.

QUALITY ASSURANCE:

QMS2013-01 Revision A (comparable with ANSI ISO/ASQ Q9001-2000)

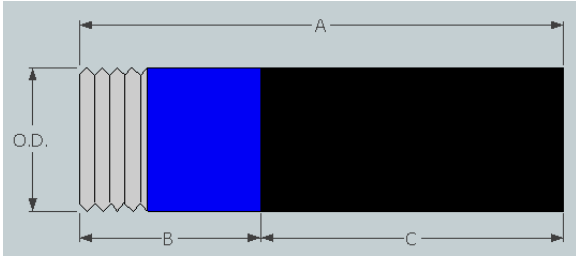

RAW MATERIAL SPECIFICATIONS	
POLY PIPE	High Density Polyethylene PE3408/4710
METALLIC PIPE	Carbon Steel A53 Grade B
FINISH	Epoxy Coated "Blue"

FINISHED PRODUCT SPECIFICATIONS	
ASTM D1599, D1598, D3350 Category 3	

STANDARD STOCK SIZES / PRESSURE RATINGS					
Size Range	3/4" - 12" IPS				
SDR	7	9	11	17	SDR
PSI	336	252	202	126	PSI

Other O.D's, SDR's and Pressure Ratings available upon Request.
 This transition can be converted to Category 1 upon request
 (Additional charges apply)

Code	Nominal Pipe Size	O.D. (inch)	DIMENSIONAL DATA					WEIGHT PER EACH			
			A	B	C	D	E	SDR-7	SDR-9	SDR-11	SDR-17
007	3/4"	1.050	6.00	2.00	4.00			0.86	0.76	0.79	0.79
010	1"	1.315	6.00	2.50	3.50			0.87	0.84	0.88	0.88
012	1-1/4"	1.660	6.00	2.50	3.50			0.60	0.56	0.53	0.53
015	1-1/2"	1.900	6.00	3.00	3.00			0.76	0.70	0.66	0.77
020	2"	2.370	8.00	4.00	4.00			1.38	1.26	1.07	0.97
030	3"	3.500	8.00	4.00	4.00			3.42	3.16	2.98	2.68
040	4"	4.500	8.00	5.00	3.00			5.23	4.79	4.50	4.00
060	6"	6.625	13.00	7.00	6.00			15.06	13.54	10.44	9.35
080	8"	8.625	15.00	8.00	7.00			30.67	27.68	24.25	19.33
100	10"	10.750	16.00	9.00	7.00			51.42	46.45	41.99	36.63
120	12"	12.750	18.00	9.00	9.00			80.46	72.63	64.23	56.19
140	14"	14.000									
160	16"	16.000									
180	18"	18.000									
200	20"	20.000									
240	24"	24.000									

Warranty / Insurance Information:

All products manufactured shall be free from defects in material and workmanship under normal use and service within limitation. If a product is believed to be defective and on examination by the Quality Assurance department discovers this is the case the product will be repaired or replaced at no cost. General Liability coverage is provided for bodily injury and property damage arising out of products sold or distributed or out of operations performed for someone else after the operations have been completed.

QUALITY ASSURANCE:

QMS2013-01 Revision A (comparable with ANSI ISO/ASQ Q9001-2000)

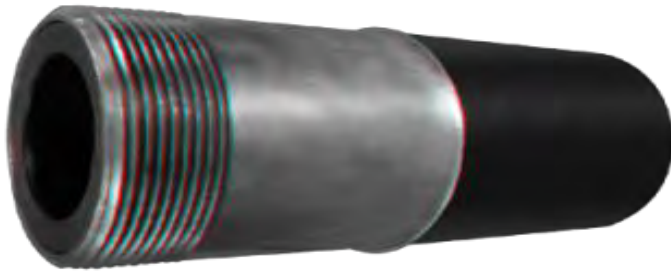
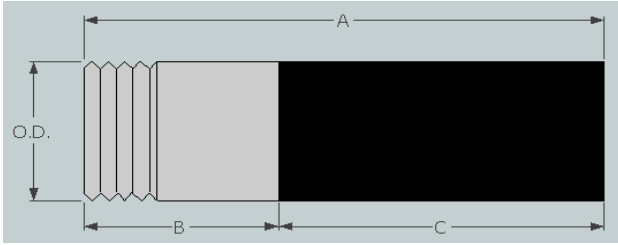

RAW MATERIAL SPECIFICATIONS	
POLY PIPE	High Density Polyethylene PE3408/4710
METALLIC PIPE	304 Stainless Steel
FINISH	Plain

FINISHED PRODUCT SPECIFICATIONS	
ASTM D1599, D1598, D3350 Category 3	

STANDARD STOCK SIZES / PRESSURE RATINGS					
Size Range	3/4" - 12" IPS				
SDR	7	9	11	17	SDR
PSI	336	252	202	126	PSI

Other O.D's, SDR's and Pressure Ratings available upon Request.
 This transition can be converted to Category 1 upon request
 (Additional charges apply)

Code	Nominal Pipe Size	O.D. (inch)	DIMENSIONAL DATA					WEIGHT PER EACH			
			A	B	C	D	E	SDR-7	SDR-9	SDR-11	SDR-17
007	3/4"	1.050	6.00	2.00	4.00			0.86	0.76	0.79	0.79
010	1"	1.315	6.00	2.50	3.50			0.87	0.84	0.88	0.88
012	1-1/4"	1.660	6.00	2.50	3.50			0.60	0.56	0.53	0.53
015	1-1/2"	1.900	6.00	3.00	3.00			0.76	0.70	0.66	0.77
020	2"	2.370	8.00	4.00	4.00			1.38	1.26	1.07	0.97
030	3"	3.500	8.00	4.00	4.00			3.42	3.16	2.98	2.68
040	4"	4.500	8.00	5.00	3.00			5.23	4.79	4.50	4.00
060	6"	6.625	13.00	7.00	6.00			15.06	13.54	10.44	9.35
080	8"	8.625	15.00	8.00	7.00			30.67	27.68	24.25	19.33
100	10"	10.750	16.00	9.00	7.00			51.42	46.45	41.99	36.63
120	12"	12.750	18.00	9.00	9.00			80.46	72.63	64.23	56.19
140	14"	14.000									
160	16"	16.000									
180	18"	18.000									
200	20"	20.000									
240	24"	24.000									

Warranty / Insurance Information:

All products manufactured shall be free from defects in material and workmanship under normal use and service within limitation. If a product is believed to be defective and on examination by the Quality Assurance department discovers this is the case the product will be repaired or replaced at no cost. General Liability coverage is provided for bodily injury and property damage arising out of products sold or distributed or out of operations performed for someone else after the operations have been completed.

QUALITY ASSURANCE:

QMS2013-01 Revision A (comparable with ANSI ISO/ASQ Q9001-2000)

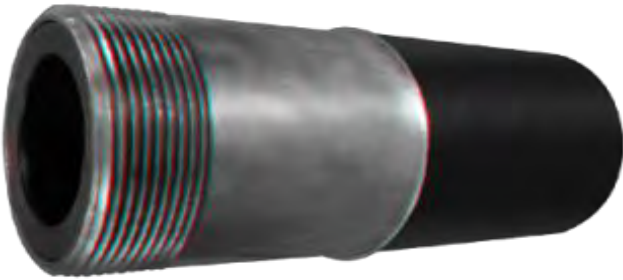
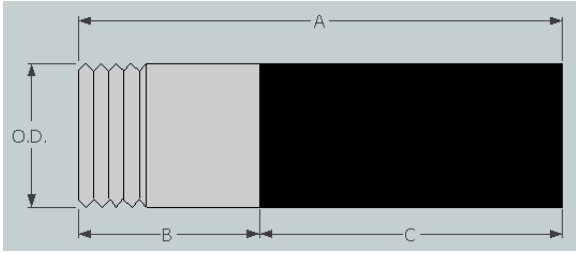

RAW MATERIAL SPECIFICATIONS	
POLY PIPE	High Density Polyethylene PE3408/4710
METALLIC PIPE	316 Stainless Steel
FINISH	Plain

FINISHED PRODUCT SPECIFICATIONS	
ASTM D1599, D1598, D3350 Category 3	

STANDARD STOCK SIZES / PRESSURE RATINGS					
Size Range	3/4" - 12" IPS				
SDR	7	9	11	17	SDR
PSI	336	252	202	126	PSI

Other O.D's, SDR's and Pressure Ratings available upon Request.
 This transition can be converted to Category 1 upon request
 (Additional charges apply)

Code	Nominal Pipe Size	O.D. (inch)	DIMENSIONAL DATA					WEIGHT PER EACH			
			A	B	C	D	E	SDR-7	SDR-9	SDR-11	SDR-17
007	3/4"	1.050	6.00	2.00	4.00			0.86	0.76	0.79	0.79
010	1"	1.315	6.00	2.50	3.50			0.87	0.84	0.88	0.88
012	1-1/4"	1.660	6.00	2.50	3.50			0.60	0.56	0.53	0.53
015	1-1/2"	1.900	6.00	3.00	3.00			0.76	0.70	0.66	0.77
020	2"	2.370	8.00	4.00	4.00			1.38	1.26	1.07	0.97
030	3"	3.500	8.00	4.00	4.00			3.42	3.16	2.98	2.68
040	4"	4.500	8.00	5.00	3.00			5.23	4.79	4.50	4.00
060	6"	6.625	13.00	7.00	6.00			15.06	13.54	10.44	9.35
080	8"	8.625	15.00	8.00	7.00			30.67	27.68	24.25	19.33
100	10"	10.750	16.00	9.00	7.00			51.42	46.45	41.99	36.63
120	12"	12.750	18.00	9.00	9.00			80.46	72.63	64.23	56.19
140	14"	14.000									
160	16"	16.000									
180	18"	18.000									
200	20"	20.000									
240	24"	24.000									

Warranty / Insurance Information:

All products manufactured shall be free from defects in material and workmanship under normal use and service within limitation. If a product is believed to be defective and on examination by the Quality Assurance department discovers this is the case the product will be repaired or replaced at no cost. General Liability coverage is provided for bodily injury and property damage arising out of products sold or distributed or out of operations performed for someone else after the operations have been completed.

QUALITY ASSURANCE:

QMS2013-01 Revision A (comparable with ANSI ISO/ASQ Q9001-2000)

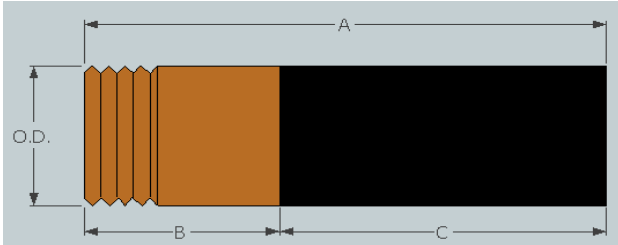

RAW MATERIAL SPECIFICATIONS	
POLY PIPE	High Density Polyethylene PE3408/4710
METALLIC PIPE	Red Brass ASTM B43 (Copper Alloy c230)
FINISH	Plain

FINISHED PRODUCT SPECIFICATIONS	
ASTM D1599, D1598, D3350 Category 3	

STANDARD STOCK SIZES / PRESSURE RATINGS					
Size Range	3/4" - 6" IPS				
SDR	7	9	11	17	SDR
PSI	336	252	202	126	PSI

Other O.D's, SDR's and Pressure Ratings available upon Request.
 This transition can be converted to Category 1 upon request
 (Additional charges apply)

Code	Nominal Pipe Size	O.D. (inch)	DIMENSIONAL DATA					WEIGHT PER EACH			
			A	B	C	D	E	SDR-7	SDR-9	SDR-11	SDR-17
007	3/4"	1.050	6.00	2.00	4.00			0.86	0.76	0.79	0.79
010	1"	1.315	6.00	2.50	3.50			0.87	0.84	0.88	0.88
012	1-1/4"	1.660	6.00	2.50	3.50			0.60	0.56	0.53	0.53
015	1-1/2"	1.900	6.00	3.00	3.00			0.76	0.70	0.66	0.77
020	2"	2.370	8.00	4.00	4.00			1.38	1.26	1.07	0.97
030	3"	3.500	8.00	4.00	4.00			3.42	3.16	2.98	2.68
040	4"	4.500	8.00	5.00	3.00			5.23	4.79	4.50	4.00
060	6"	6.625	13.00	7.00	6.00			15.06	13.54	10.44	9.35
080	8"	8.625									
100	10"	10.750									
120	12"	12.750									
140	14"	14.000									
160	16"	16.000									
180	18"	18.000									
200	20"	20.000									
240	24"	24.000									

Warranty / Insurance Information:

All products manufactured shall be free from defects in material and workmanship under normal use and service within limitation. If a product is believed to be defective and on examination by the Quality Assurance department discovers this is the case the product will be repaired or replaced at no cost. General Liability coverage is provided for bodily injury and property damage arising out of products sold or distributed or out of operations performed for someone else after the operations have been completed.

QUALITY ASSURANCE:

QMS2013-01 Revision A (comparable with ANSI ISO/ASQ Q9001-2000)

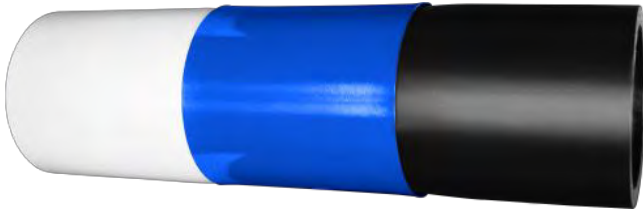
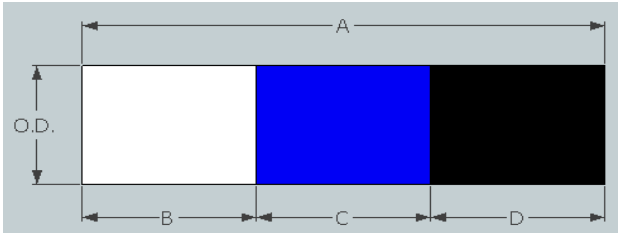

For higher pressure rating use Sch 80 PVC

RAW MATERIAL SPECIFICATIONS	
POLY PIPE	High Density Polyethylene PE3408/4710
METALLIC PIPE	Carbon Steel A53 Grade B
FINISH	Industrial Strength Paint "Blue"

FINISHED PRODUCT SPECIFICATIONS
ASTM D1599, D1598, D3350 Category 3 / PVC = ASTM D2466 - 06

STANDARD STOCK SIZES / PRESSURE RATINGS					
Size Range	3/4" - 20" IPS				
SDR	7	9	11	17	SDR
PSI	336	252	202	126	PSI

**** NOTE ****

Other O.D's, SDR's and Pressure Ratings available upon Request.
 Pressure Rating decreased due to PVC Maximum Operating PSI
 2"@280; 3"@260; 4"@220; 6"@180; 8"@160; 10"@140; 12"@130

Code	Nominal Pipe Size	O.D. (inch)	DIMENSIONAL DATA					WEIGHT PER EACH			
			A	B	C	D	E	SDR-7	SDR-9	SDR-11	SDR-17
007	3/4"	1.050	12.00	4.00	4.00	4.00		1.21	1.12	1.06	1.06
010	1"	1.315	12.00	4.00	4.00	4.00		1.21	1.12	1.06	1.06
012	1-1/4"	1.660	12.00	4.00	4.00	4.00		1.51	1.40	1.32	1.53
015	1-1/2"	1.900	12.00	4.00	4.00	4.00		2.76	2.52	2.14	1.93
020	2"	2.370	16.00	5.75	4.50	5.75		6.84	6.31	5.95	5.35
030	3"	3.500	16.00	5.50	5.00	5.50		10.46	9.59	8.99	7.99
040	4"	4.500	26.00	10.00	6.00	10.00		30.13	27.07	20.87	18.71
060	6"	6.625	30.00	11.00	8.00	11.00		61.34	55.35	48.49	38.66
080	8"	8.625	30.00	10.50	9.00	10.50		102.84	92.89	83.98	73.26
100	10"	10.750	34.00	12.50	9.00	12.50		160.93	145.25	128.45	112.37
120	12"	12.750	36.00	12.00	12.00	12.00		205.08	184.06	162.39	140.59
140	14"	14.000									
160	16"	16.000									
180	18"	18.000									
200	20"	20.000									
240	24"	24.000									

Warranty / Insurance Information:

All products manufactured shall be free from defects in material and workmanship under normal use and service within limitation. If a product is believed to be defective and on examination by the Quality Assurance department discovers this is the case the product will be repaired or replaced at no cost. General Liability coverage is provided for bodily injury and property damage arising out of products sold or distributed or out of operations performed for someone else after the operations have been completed.

QUALITY ASSURANCE:

QMS2013-01 Revision A (comparable with ANSI ISO/ASQ Q9001-2000)

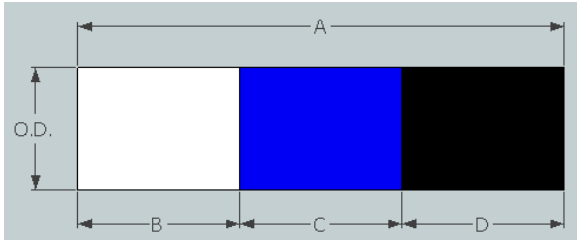

For higher pressure rating use Sch 80 PVC

RAW MATERIAL SPECIFICATIONS	
POLY PIPE	High Density Polyethylene PE3408/4710
METALLIC PIPE	Carbon Steel A53 Grade B
FINISH	Epoxy Coated "Blue"

FINISHED PRODUCT SPECIFICATIONS	
ASTM D1599, D1598, D3350 Category 3 / PVC = ASTM D2466 - 06	

STANDARD STOCK SIZES / PRESSURE RATINGS					
Size Range	3/4" - 20" IPS				
SDR	7	9	11	17	SDR
PSI	336	252	202	126	PSI

**** NOTE ****

Other O.D's, SDR's and Pressure Ratings available upon Request.
 Pressure Rating decreased due to PVC Maximum Operating PSI
 2"@280; 3"@260; 4"@220; 6"@180; 8"@160; 10"@140; 12"@130

Code	Nominal Pipe Size	O.D. (inch)	DIMENSIONAL DATA					WEIGHT PER EACH			
			A	B	C	D	E	SDR-7	SDR-9	SDR-11	SDR-17
007	3/4"	1.050	12.00	4.00	4.00	4.00		1.21	1.12	1.06	1.06
010	1"	1.315	12.00	4.00	4.00	4.00		1.21	1.12	1.06	1.06
012	1-1/4"	1.660	12.00	4.00	4.00	4.00		1.51	1.40	1.32	1.53
015	1-1/2"	1.900	12.00	4.00	4.00	4.00		2.76	2.52	2.14	1.93
020	2"	2.370	16.00	5.75	4.50	5.75		6.84	6.31	5.95	5.35
030	3"	3.500	16.00	5.50	5.00	5.50		10.46	9.59	8.99	7.99
040	4"	4.500	26.00	10.00	6.00	10.00		30.13	27.07	20.87	18.71
060	6"	6.625	30.00	11.00	8.00	11.00		61.34	55.35	48.49	38.66
080	8"	8.625	30.00	10.50	9.00	10.50		102.84	92.89	83.98	73.26
100	10"	10.750	34.00	12.50	9.00	12.50		160.93	145.25	128.45	112.37
120	12"	12.750	36.00	12.00	12.00	12.00		205.08	184.06	162.39	140.59
140	14"	14.000									
160	16"	16.000									
180	18"	18.000									
200	20"	20.000									
240	24"	24.000									

Warranty / Insurance Information:

All products manufactured shall be free from defects in material and workmanship under normal use and service within limitation. If a product is believed to be defective and on examination by the Quality Assurance department discovers this is the case the product will be repaired or replaced at no cost. General Liability coverage is provided for bodily injury and property damage arising out of products sold or distributed or out of operations performed for someone else after the operations have been completed.

QUALITY ASSURANCE:

QMS2013-01 Revision A (comparable with ANSI ISO/ASQ Q9001-2000)

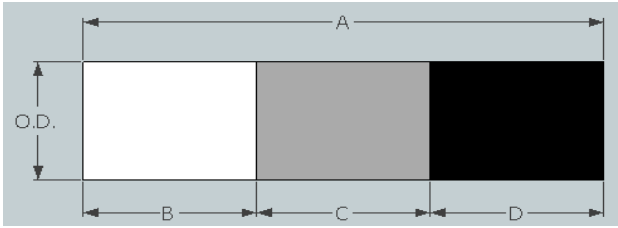

RAW MATERIAL SPECIFICATIONS	
POLY PIPE	High Density Polyethylene PE3408/4710
METALLIC PIPE	304 Stainless Steel
FINISH	Plain

FINISHED PRODUCT SPECIFICATIONS	
ASTM D1599, D1598, D3350 Category 3 / PVC = ASTM D2466 - 06	

STANDARD STOCK SIZES / PRESSURE RATINGS					
Size Range	3/4" - 20" IPS				
SDR	7	9	11	17	SDR
PSI	336	252	202	126	PSI

**** NOTE ****

Other O.D's, SDR's and Pressure Ratings available upon Request.
 Pressure Rating decreased due to PVC Maximum Operating PSI
 2"@280; 3"@260; 4"@220; 6"@180; 8"@160; 10"@140; 12"@130

For higher pressure rating use Sch 80 PVC

Code	Nominal Pipe Size	O.D. (inch)	DIMENSIONAL DATA					WEIGHT PER EACH			
			A	B	C	D	E	SDR-7	SDR-9	SDR-11	SDR-17
007	3/4"	1.050	12.00	4.00	4.00	4.00		1.21	1.12	1.06	1.06
010	1"	1.315	12.00	4.00	4.00	4.00		1.21	1.12	1.06	1.06
012	1-1/4"	1.660	12.00	4.00	4.00	4.00		1.51	1.40	1.32	1.53
015	1-1/2"	1.900	12.00	4.00	4.00	4.00		2.76	2.52	2.14	1.93
020	2"	2.370	16.00	5.75	4.50	5.75		6.84	6.31	5.95	5.35
030	3"	3.500	16.00	5.50	5.00	5.50		10.46	9.59	8.99	7.99
040	4"	4.500	26.00	10.00	6.00	10.00		30.13	27.07	20.87	18.71
060	6"	6.625	30.00	11.00	8.00	11.00		61.34	55.35	48.49	38.66
080	8"	8.625	30.00	10.50	9.00	10.50		102.84	92.89	83.98	73.26
100	10"	10.750	34.00	12.50	9.00	12.50		160.93	145.25	128.45	112.37
120	12"	12.750	36.00	12.00	12.00	12.00		205.08	184.06	162.39	140.59
140	14"	14.000									
160	16"	16.000									
180	18"	18.000									
200	20"	20.000									
240	24"	24.000									

Warranty / Insurance Information:

All products manufactured shall be free from defects in material and workmanship under normal use and service within limitation. If a product is believed to be defective and on examination by the Quality Assurance department discovers this is the case the product will be repaired or replaced at no cost. General Liability coverage is provided for bodily injury and property damage arising out of products sold or distributed or out of operations performed for someone else after the operations have been completed.

QUALITY ASSURANCE:

QMS2013-01 Revision A [comparable with ANSI ISO/ASQ Q9001-2000]

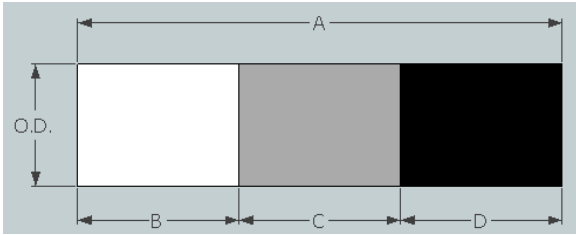

RAW MATERIAL SPECIFICATIONS	
POLY PIPE	High Density Polyethylene PE3408/4710
METALLIC PIPE	316 Stainless Steel
FINISH	Plain

FINISHED PRODUCT SPECIFICATIONS	
ASTM D1599, D1598, D3350 Category 3 / PVC = ASTM D2466 - 06	

STANDARD STOCK SIZES / PRESSURE RATINGS					
Size Range	3/4" - 20" IPS				
SDR	7	9	11	17	SDR
PSI	336	252	202	126	PSI

**** NOTE ****

Other O.D's, SDR's and Pressure Ratings available upon Request.
 Pressure Rating decreased due to PVC Maximum Operating PSI
 2"@280; 3"@260; 4"@220; 6"@180; 8"@160; 10"@140; 12"@130

For higher pressure rating use Sch 80 PVC

Code	Nominal Pipe Size	O.D. (inch)	DIMENSIONAL DATA					WEIGHT PER EACH			
			A	B	C	D	E	SDR-7	SDR-9	SDR-11	SDR-17
007	3/4"	1.050	12.00	4.00	4.00	4.00		1.21	1.12	1.06	1.06
010	1"	1.315	12.00	4.00	4.00	4.00		1.21	1.12	1.06	1.06
012	1-1/4"	1.660	12.00	4.00	4.00	4.00		1.51	1.40	1.32	1.53
015	1-1/2"	1.900	12.00	4.00	4.00	4.00		2.76	2.52	2.14	1.93
020	2"	2.370	16.00	5.75	4.50	5.75		6.84	6.31	5.95	5.35
030	3"	3.500	16.00	5.50	5.00	5.50		10.46	9.59	8.99	7.99
040	4"	4.500	26.00	10.00	6.00	10.00		30.13	27.07	20.87	18.71
060	6"	6.625	30.00	11.00	8.00	11.00		61.34	55.35	48.49	38.66
080	8"	8.625	30.00	10.50	9.00	10.50		102.84	92.89	83.98	73.26
100	10"	10.750	34.00	12.50	9.00	12.50		160.93	145.25	128.45	112.37
120	12"	12.750	36.00	12.00	12.00	12.00		205.08	184.06	162.39	140.59
140	14"	14.000									
160	16"	16.000									
180	18"	18.000									
200	20"	20.000									
240	24"	24.000									

Warranty / Insurance Information:

All products manufactured shall be free from defects in material and workmanship under normal use and service within limitation. If a product is believed to be defective and on examination by the Quality Assurance department discovers this is the case the product will be repaired or replaced at no cost. General Liability coverage is provided for bodily injury and property damage arising out of products sold or distributed or out of operations performed for someone else after the operations have been completed.

QUALITY ASSURANCE:

QMS2013-01 Revision A (comparable with ANSI ISO/ASQ Q9001-2000)

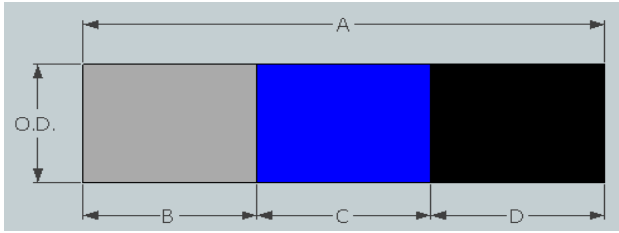

RAW MATERIAL SPECIFICATIONS	
POLY PIPE	High Density Polyethylene PE3408/4710
METALLIC PIPE	Carbon Steel A53 Grade B
FINISH	Industrial Strength Paint "Blue"

FINISHED PRODUCT SPECIFICATIONS	
ASTM D1599, D1598, D3350 Category 3 / PVC = ASTM D2467-04e1	

STANDARD STOCK SIZES / PRESSURE RATINGS					
Size Range	3/4" - 12" IPS				
SDR	7	9	11	17	SDR
PSI	336	252	202	126	PSI

**** NOTE ****

Other O.D's, SDR's and Pressure Ratings available upon Request.
 Pressure Rating decreased due to PVC Maximum Operating PSI
 6"@280; 8"@250; 10"@230; 12"@230

Code	Nominal Pipe Size	O.D. (inch)	DIMENSIONAL DATA					WEIGHT PER EACH			
			A	B	C	D	E	SDR-7	SDR-9	SDR-11	SDR-17
007	3/4"	1.050	12.00	4.00	4.00	4.00		1.27	1.18	1.12	1.12
010	1"	1.315	12.00	4.00	4.00	4.00		1.27	1.18	1.12	1.12
012	1-1/4"	1.660	12.00	4.00	4.00	4.00		1.59	1.47	1.39	1.61
015	1-1/2"	1.900	12.00	4.00	4.00	4.00		2.90	2.65	2.25	2.03
020	2"	2.370	16.00	5.75	4.50	5.75		7.20	6.65	6.27	5.63
030	3"	3.500	16.00	5.50	5.00	5.50		11.01	10.09	9.47	8.42
040	4"	4.500	26.00	10.00	6.00	10.00		31.71	28.50	21.97	19.69
060	6"	6.625	30.00	11.00	8.00	11.00		64.57	58.26	51.04	40.69
080	8"	8.625	30.00	10.50	9.00	10.50		108.25	97.78	88.40	77.11
100	10"	10.750	34.00	12.50	9.00	12.50		169.40	152.90	135.21	118.29
120	12"	12.750	36.00	12.00	12.00	12.00		215.88	193.75	170.94	147.99
140	14"	14.000									
160	16"	16.000									
180	18"	18.000									
200	20"	20.000									
240	24"	24.000									

Warranty / Insurance Information:

All products manufactured shall be free from defects in material and workmanship under normal use and service within limitation. If a product is believed to be defective and on examination by the Quality Assurance department discovers this is the case the product will be repaired or replaced at no cost. General Liability coverage is provided for bodily injury and property damage arising out of products sold or distributed or out of operations performed for someone else after the operations have been completed.

QUALITY ASSURANCE:

QMS2013-01 Revision A (comparable with ANSI ISO/ASQ Q9001-2000)

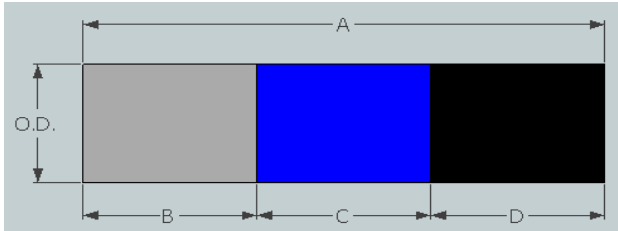

RAW MATERIAL SPECIFICATIONS	
POLY PIPE	High Density Polyethylene PE3408/4710
METALLIC PIPE	Carbon Steel A53 Grade B
FINISH	Epoxy Coated "Blue"

FINISHED PRODUCT SPECIFICATIONS	
ASTM D1599, D1598, D3350 Category 3 / PVC = ASTM D2467-04e1	

STANDARD STOCK SIZES / PRESSURE RATINGS					
Size Range	3/4" - 12" IPS				
SDR	7	9	11	17	SDR
PSI	336	252	202	126	PSI

**** NOTE ****

Other O.D's, SDR's and Pressure Ratings available upon Request.
 Pressure Rating decreased due to PVC Maximum Operating PSI
 6"@280; 8"@250; 10"@230; 12"@230

Code	Nominal Pipe Size	O.D. (inch)	DIMENSIONAL DATA					WEIGHT PER EACH			
			A	B	C	D	E	SDR-7	SDR-9	SDR-11	SDR-17
007	3/4"	1.050	12.00	4.00	4.00	4.00		1.27	1.18	1.12	1.12
010	1"	1.315	12.00	4.00	4.00	4.00		1.27	1.18	1.12	1.12
012	1-1/4"	1.660	12.00	4.00	4.00	4.00		1.59	1.47	1.39	1.61
015	1-1/2"	1.900	12.00	4.00	4.00	4.00		2.90	2.65	2.25	2.03
020	2"	2.370	16.00	5.75	4.50	5.75		7.20	6.65	6.27	5.63
030	3"	3.500	16.00	5.50	5.00	5.50		11.01	10.09	9.47	8.42
040	4"	4.500	26.00	10.00	6.00	10.00		31.71	28.50	21.97	19.69
060	6"	6.625	30.00	11.00	8.00	11.00		64.57	58.26	51.04	40.69
080	8"	8.625	30.00	10.50	9.00	10.50		108.25	97.78	88.40	77.11
100	10"	10.750	34.00	12.50	9.00	12.50		169.40	152.90	135.21	118.29
120	12"	12.750	36.00	12.00	12.00	12.00		215.88	193.75	170.94	147.99
140	14"	14.000									
160	16"	16.000									
180	18"	18.000									
200	20"	20.000									
240	24"	24.000									

Warranty / Insurance Information:

All products manufactured shall be free from defects in material and workmanship under normal use and service within limitation. If a product is believed to be defective and on examination by the Quality Assurance department discovers this is the case the product will be repaired or replaced at no cost. General Liability coverage is provided for bodily injury and property damage arising out of products sold or distributed or out of operations performed for someone else after the operations have been completed.

QUALITY ASSURANCE:

QMS2013-01 Revision A [comparable with ANSI ISO/ASQ Q9001-2000]

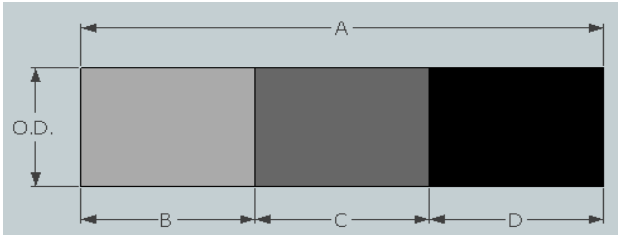

RAW MATERIAL SPECIFICATIONS	
POLY PIPE	High Density Polyethylene PE3408/4710
METALLIC PIPE	304 Stainless Steel
FINISH	Plain

FINISHED PRODUCT SPECIFICATIONS	
ASTM D1599, D1598, D3350 Category 3 / PVC = ASTM D2467-04e1	

STANDARD STOCK SIZES / PRESSURE RATINGS					
Size Range	3/4" - 20" IPS				
SDR	7	9	11	17	SDR
PSI	336	252	202	126	PSI

**** NOTE ****

Other O.D's, SDR's and Pressure Ratings available upon Request.
 Pressure Rating decreased due to PVC Maximum Operating PSI
 6"@280; 8"@250; 10"@230; 12"@230

Code	Nominal Pipe Size	O.D. (inch)	DIMENSIONAL DATA					WEIGHT PER EACH			
			A	B	C	D	E	SDR-7	SDR-9	SDR-11	SDR-17
007	3/4"	1.050	12.00	4.00	4.00	4.00		1.27	1.18	1.12	1.12
010	1"	1.315	12.00	4.00	4.00	4.00		1.27	1.18	1.12	1.12
012	1-1/4"	1.660	12.00	4.00	4.00	4.00		1.59	1.47	1.39	1.61
015	1-1/2"	1.900	12.00	4.00	4.00	4.00		2.90	2.65	2.25	2.03
020	2"	2.370	16.00	5.75	4.50	5.75		7.20	6.65	6.27	5.63
030	3"	3.500	16.00	5.50	5.00	5.50		11.01	10.09	9.47	8.42
040	4"	4.500	26.00	10.00	6.00	10.00		31.71	28.50	21.97	19.69
060	6"	6.625	30.00	11.00	8.00	11.00		64.57	58.26	51.04	40.69
080	8"	8.625	30.00	10.50	9.00	10.50		108.25	97.78	88.40	77.11
100	10"	10.750	34.00	12.50	9.00	12.50		169.40	152.90	135.21	118.29
120	12"	12.750	36.00	12.00	12.00	12.00		215.88	193.75	170.94	147.99
140	14"	14.000									
160	16"	16.000									
180	18"	18.000									
200	20"	20.000									
240	24"	24.000									

Warranty / Insurance Information:

All products manufactured shall be free from defects in material and workmanship under normal use and service within limitation. If a product is believed to be defective and on examination by the Quality Assurance department discovers this is the case the product will be repaired or replaced at no cost. General Liability coverage is provided for bodily injury and property damage arising out of products sold or distributed or out of operations performed for someone else after the operations have been completed.

QUALITY ASSURANCE:

QMS2013-01 Revision A (comparable with ANSI ISO/ASQ Q9001-2000)

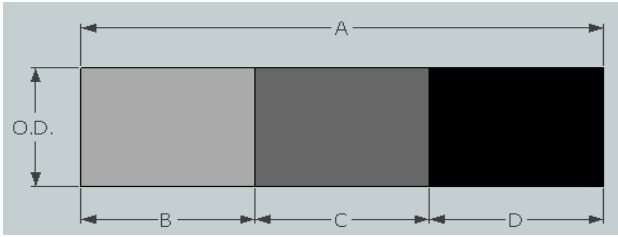

RAW MATERIAL SPECIFICATIONS	
POLY PIPE	High Density Polyethylene PE3408/4710
METALLIC PIPE	316 Stainless Steel
FINISH	Plain

FINISHED PRODUCT SPECIFICATIONS	
ASTM D1599, D1598, D3350 Category 3 / PVC = ASTM D2467-04e1	

STANDARD STOCK SIZES / PRESSURE RATINGS					
Size Range	3/4" - 20" IPS				
SDR	7	9	11	17	SDR
PSI	336	252	202	126	PSI

**** NOTE ****

Other O.D's, SDR's and Pressure Ratings available upon Request.
 Pressure Rating decreased due to PVC Maximum Operating PSI
 6"@280; 8"@250; 10"@230; 12"@230

Code	Nominal Pipe Size	O.D. (inch)	DIMENSIONAL DATA					WEIGHT PER EACH			
			A	B	C	D	E	SDR-7	SDR-9	SDR-11	SDR-17
007	3/4"	1.050	12.00	4.00	4.00	4.00		1.27	1.18	1.12	1.12
010	1"	1.315	12.00	4.00	4.00	4.00		1.27	1.18	1.12	1.12
012	1-1/4"	1.660	12.00	4.00	4.00	4.00		1.59	1.47	1.39	1.61
015	1-1/2"	1.900	12.00	4.00	4.00	4.00		2.90	2.65	2.25	2.03
020	2"	2.370	16.00	5.75	4.50	5.75		7.20	6.65	6.27	5.63
030	3"	3.500	16.00	5.50	5.00	5.50		11.01	10.09	9.47	8.42
040	4"	4.500	26.00	10.00	6.00	10.00		31.71	28.50	21.97	19.69
060	6"	6.625	30.00	11.00	8.00	11.00		64.57	58.26	51.04	40.69
080	8"	8.625	30.00	10.50	9.00	10.50		108.25	97.78	88.40	77.11
100	10"	10.750	34.00	12.50	9.00	12.50		169.40	152.90	135.21	118.29
120	12"	12.750	36.00	12.00	12.00	12.00		215.88	193.75	170.94	147.99
140	14"	14.000									
160	16"	16.000									
180	18"	18.000									
200	20"	20.000									
240	24"	24.000									

Warranty / Insurance Information:

All products manufactured shall be free from defects in material and workmanship under normal use and service within limitation. If a product is believed to be defective and on examination by the Quality Assurance department discovers this is the case the product will be repaired or replaced at no cost. General Liability coverage is provided for bodily injury and property damage arising out of products sold or distributed or out of operations performed for someone else after the operations have been completed.

QUALITY ASSURANCE:

QMS2013-01 Revision A (comparable with ANSI ISO/ASQ Q9001-2000)

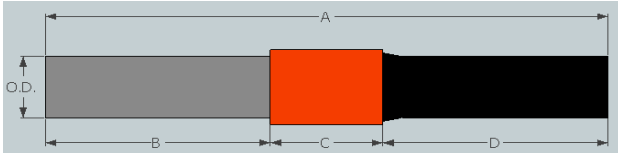

RAW MATERIAL SPECIFICATIONS	
POLY PIPE	High Density Polyethylene PE3408/4710
METALLIC PIPE	Carbon Steel A53 Grade B
FINISH	Industrial Strength Paint "ORANGE" & "Black"

FINISHED PRODUCT SPECIFICATIONS
ASTM D2513, ASTM 1973-05, D1599, D1598 Category 1

STANDARD STOCK SIZES / PRESSURE RATINGS					
Size Range	3/4" - 14" IPS				
SDR	7	9	11	17	SDR
PSI	336	252	202	126	PSI

Other O.D's, SDR's and Pressure Ratings available upon Request.
 This transition can be converted to Category 1 upon request
 (Additional charges apply)

Code	Nominal Pipe Size	O.D. (inch)	DIMENSIONAL DATA					WEIGHT PER EACH			
			A	B	C	D	E	SDR-7	SDR-9	SDR-11	SDR-17
007	3/4"	1.050	17.00	7.00	3.00	7.00		3.08	2.75	3.22	3.22
010	1"	1.315	17.00	7.00	3.00	7.00		3.08	2.75	3.22	3.22
012	1-1/4"	1.660	17.00	7.00	3.00	7.00		2.33	2.24	2.19	1.88
015	1-1/2"	1.900	17.00	7.00	3.00	7.00		2.97	2.86	2.78	2.37
020	2"	2.370	26.00	12.00	3.00	11.00		6.02	5.78	5.61	5.34
030	3"	3.500	29.00	14.00	4.00	11.00		14.91	14.31	13.91	13.23
040	4"	4.500	31.00	15.00	5.00	11.00		24.99	23.90	23.16	21.91
060	6"	6.625	36.00	16.00	6.00	14.00		54.86	52.28	50.51	47.53
080	8"	8.625	38.00	16.00	8.00	14.00		94.21	89.42	86.16	77.08
100	10"	10.750	40.00	16.00	10.00	14.00		154.40	146.32	140.83	131.54
120	12"	12.750	42.00	16.00	12.00	14.00		231.48	219.29	210.96	196.90
140	14"	14.000	42.00	16.00	12.00	14.00		279.45	264.73	254.70	237.75
160	16"	16.000	42.00	16.00	12.00	14.00		373.47	354.18	341.13	318.96
180	18"	18.000	42.00	14.00	14.00	14.00		467.86	443.53	426.94	398.92
200	20"	20.000	42.00	14.00	14.00	14.00		573.40	543.34	522.88	488.22
240	24"	24.000									

Warranty / Insurance Information:

All products manufactured shall be free from defects in material and workmanship under normal use and service within limitation. If a product is believed to be defective and on examination by the Quality Assurance department discovers this is the case the product will be repaired or replaced at no cost. General Liability coverage is provided for bodily injury and property damage arising out of products sold or distributed or out of operations performed for someone else after the operations have been completed.

QUALITY ASSURANCE:

QMS2013-01 Revision A (comparable with ANSI ISO/ASQ Q9001-2000)

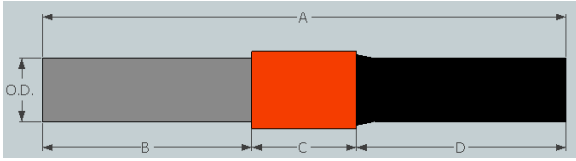

RAW MATERIAL SPECIFICATIONS	
POLY PIPE	High Density Polyethylene PE3408/4710
METALLIC PIPE	Carbon Steel A53 Grade B
FINISH	Epoxy Coated "ORANGE" & "Black"

FINISHED PRODUCT SPECIFICATIONS
ASTM D2513, ASTM 1973-05, D1599, D1598 Category 1

STANDARD STOCK SIZES / PRESSURE RATINGS					
Size Range	3/4" - 14" IPS				
SDR	7	9	11	17	SDR
PSI	336	252	202	126	PSI

Other O.D's, SDR's and Pressure Ratings available upon Request.
 This transition can be converted to Category 1 upon request
 (Additional charges apply)

Code	Nominal Pipe Size	O.D. (inch)	DIMENSIONAL DATA					WEIGHT PER EACH			
			A	B	C	D	E	SDR-7	SDR-9	SDR-11	SDR-17
007	3/4"	1.050	17.00	7.00	3.00	7.00		3.08	2.75	3.22	3.22
010	1"	1.315	17.00	7.00	3.00	7.00		3.08	2.75	3.22	3.22
012	1-1/4"	1.660	17.00	7.00	3.00	7.00		2.33	2.24	2.19	1.88
015	1-1/2"	1.900	17.00	7.00	3.00	7.00		2.97	2.86	2.78	2.37
020	2"	2.370	26.00	12.00	3.00	11.00		6.02	5.78	5.61	5.34
030	3"	3.500	29.00	14.00	4.00	11.00		14.91	14.31	13.91	13.23
040	4"	4.500	31.00	15.00	5.00	11.00		24.99	23.90	23.16	21.91
060	6"	6.625	36.00	16.00	6.00	14.00		54.86	52.28	50.51	47.53
080	8"	8.625	38.00	16.00	8.00	14.00		94.21	89.42	86.16	77.08
100	10"	10.750	40.00	16.00	10.00	14.00		154.40	146.32	140.83	131.54
120	12"	12.750	42.00	16.00	12.00	14.00		231.48	219.29	210.96	196.90
140	14"	14.000	42.00	16.00	12.00	14.00		279.45	264.73	254.70	237.75
160	16"	16.000	42.00	16.00	12.00	14.00		373.47	354.18	341.13	318.96
180	18"	18.000	42.00	14.00	14.00	14.00		467.86	443.53	426.94	398.92
200	20"	20.000	42.00	14.00	14.00	14.00		573.40	543.34	522.88	488.22
240	24"	24.000									

Warranty / Insurance Information:

All products manufactured shall be free from defects in material and workmanship under normal use and service within limitation. If a product is believed to be defective and on examination by the Quality Assurance department discovers this is the case the product will be repaired or replaced at no cost. General Liability coverage is provided for bodily injury and property damage arising out of products sold or distributed or out of operations performed for someone else after the operations have been completed.

QUALITY ASSURANCE:

QMS2013-01 Revision A [comparable with ANSI ISO/ASQ Q9001-2000]

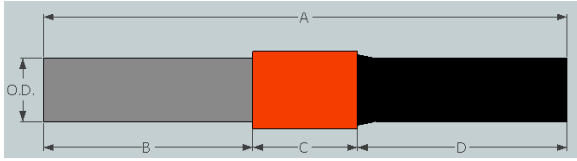

RAW MATERIAL SPECIFICATIONS	
POLY PIPE	High Density Polyethylene PE3408/4710
METALLIC PIPE	Carbon Steel A106 Grade B "Seamless"
FINISH	Industrial Strength Paint "ORANGE" & "Black"

FINISHED PRODUCT SPECIFICATIONS
ASTM D2513, ASTM 1973-05, D1599, D1598 Category 1

STANDARD STOCK SIZES / PRESSURE RATINGS					
Size Range	3/4" - 14" IPS				
SDR	7	9	11	17	SDR
PSI	336	252	202	126	PSI

Other O.D's, SDR's and Pressure Ratings available upon Request.
 This transition can be converted to Category 1 upon request
 (Additional charges apply)

Code	Nominal Pipe Size	O.D. (inch)	DIMENSIONAL DATA					WEIGHT PER EACH			
			A	B	C	D	E	SDR-7	SDR-9	SDR-11	SDR-17
007	3/4"	1.050	17.00	7.00	3.00	7.00		3.08	2.75	3.22	3.22
010	1"	1.315	17.00	7.00	3.00	7.00		3.08	2.75	3.22	3.22
012	1-1/4"	1.660	17.00	7.00	3.00	7.00		2.33	2.24	2.19	1.88
015	1-1/2"	1.900	17.00	7.00	3.00	7.00		2.97	2.86	2.78	2.37
020	2"	2.370	26.00	12.00	3.00	11.00		6.02	5.78	5.61	5.34
030	3"	3.500	29.00	14.00	4.00	11.00		14.91	14.31	13.91	13.23
040	4"	4.500	31.00	15.00	5.00	11.00		24.99	23.90	23.16	21.91
060	6"	6.625	36.00	16.00	6.00	14.00		54.86	52.28	50.51	47.53
080	8"	8.625	38.00	16.00	8.00	14.00		94.21	89.42	86.16	77.08
100	10"	10.750	40.00	16.00	10.00	14.00		154.40	146.32	140.83	131.54
120	12"	12.750	42.00	16.00	12.00	14.00		231.48	219.29	210.96	196.90
140	14"	14.000	42.00	16.00	12.00	14.00		279.45	264.73	254.70	237.75
160	16"	16.000	42.00	16.00	12.00	14.00		373.47	354.18	341.13	318.96
180	18"	18.000	42.00	14.00	14.00	14.00		467.86	443.53	426.94	398.92
200	20"	20.000	42.00	14.00	14.00	14.00		573.40	543.34	522.88	488.22
240	24"	24.000									

Warranty / Insurance Information:

All products manufactured shall be free from defects in material and workmanship under normal use and service within limitation. If a product is believed to be defective and on examination by the Quality Assurance department discovers this is the case the product will be repaired or replaced at no cost. General Liability coverage is provided for bodily injury and property damage arising out of products sold or distributed or out of operations performed for someone else after the operations have been completed.

QUALITY ASSURANCE:

QMS2013-01 Revision A [comparable with ANSI ISO/ASQ Q9001-2000]

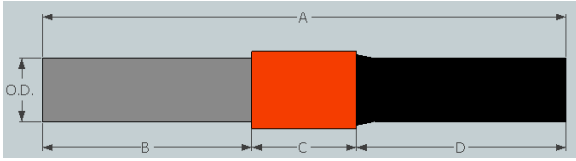

RAW MATERIAL SPECIFICATIONS	
POLY PIPE	High Density Polyethylene PE3408/4710
METALLIC PIPE	Carbon Steel A106 Grade B "Seamless"
FINISH	Epoxy Coated "ORANGE" & "Black"

FINISHED PRODUCT SPECIFICATIONS
ASTM D2513, ASTM 1973-05, D1599, D1598 Category 1

STANDARD STOCK SIZES / PRESSURE RATINGS					
Size Range	3/4" - 14" IPS				
SDR	7	9	11	17	SDR
PSI	336	252	202	126	PSI

Other O.D's, SDR's and Pressure Ratings available upon Request.
 This transition can be converted to Category 1 upon request
 (Additional charges apply)

Code	Nominal Pipe Size	O.D. (inch)	DIMENSIONAL DATA					WEIGHT PER EACH			
			A	B	C	D	E	SDR-7	SDR-9	SDR-11	SDR-17
007	3/4"	1.050	17.00	7.00	3.00	7.00		3.08	2.75	3.22	3.22
010	1"	1.315	17.00	7.00	3.00	7.00		3.08	2.75	3.22	3.22
012	1-1/4"	1.660	17.00	7.00	3.00	7.00		2.33	2.24	2.19	1.88
015	1-1/2"	1.900	17.00	7.00	3.00	7.00		2.97	2.86	2.78	2.37
020	2"	2.370	26.00	12.00	3.00	11.00		6.02	5.78	5.61	5.34
030	3"	3.500	29.00	14.00	4.00	11.00		14.91	14.31	13.91	13.23
040	4"	4.500	31.00	15.00	5.00	11.00		24.99	23.90	23.16	21.91
060	6"	6.625	36.00	16.00	6.00	14.00		54.86	52.28	50.51	47.53
080	8"	8.625	38.00	16.00	8.00	14.00		94.21	89.42	86.16	77.08
100	10"	10.750	40.00	16.00	10.00	14.00		154.40	146.32	140.83	131.54
120	12"	12.750	42.00	16.00	12.00	14.00		231.48	219.29	210.96	196.90
140	14"	14.000	42.00	16.00	12.00	14.00		279.45	264.73	254.70	237.75
160	16"	16.000	42.00	16.00	12.00	14.00		373.47	354.18	341.13	318.96
180	18"	18.000	42.00	14.00	14.00	14.00		467.86	443.53	426.94	398.92
200	20"	20.000	42.00	14.00	14.00	14.00		573.40	543.34	522.88	488.22
240	24"	24.000									

Warranty / Insurance Information:

All products manufactured shall be free from defects in material and workmanship under normal use and service within limitation. If a product is believed to be defective and on examination by the Quality Assurance department discovers this is the case the product will be repaired or replaced at no cost. General Liability coverage is provided for bodily injury and property damage arising out of products sold or distributed or out of operations performed for someone else after the operations have been completed.

QUALITY ASSURANCE:

QMS2013-01 Revision A (comparable with ANSI ISO/ASQ Q9001-2000)

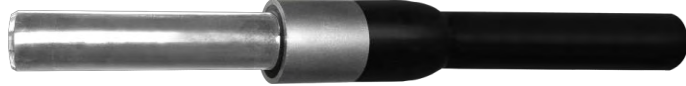
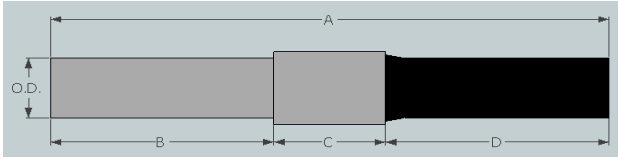

RAW MATERIAL SPECIFICATIONS	
POLY PIPE	High Density Polyethylene PE3408/4710
METALLIC PIPE	304 Stainless Steel
FINISH	Plain

FINISHED PRODUCT SPECIFICATIONS
ASTM D2513, ASTM 1973-05, D1599, D1598 Category 1

STANDARD STOCK SIZES / PRESSURE RATINGS					
Size Range	3/4" - 14" IPS				
SDR	7	9	11	17	SDR
PSI	336	252	202	126	PSI

Other O.D's, SDR's and Pressure Ratings available upon Request.
 This transition can be converted to Category 1 upon request
 (Additional charges apply)

Code	Nominal Pipe Size	O.D. (inch)	DIMENSIONAL DATA					WEIGHT PER EACH			
			A	B	C	D	E	SDR-7	SDR-9	SDR-11	SDR-17
007	3/4"	1.050	17.00	7.00	3.00	7.00		3.08	2.75	3.22	3.22
010	1"	1.315	17.00	7.00	3.00	7.00		3.08	2.75	3.22	3.22
012	1-1/4"	1.660	17.00	7.00	3.00	7.00		2.33	2.24	2.19	1.88
015	1-1/2"	1.900	17.00	7.00	3.00	7.00		2.97	2.86	2.78	2.37
020	2"	2.370	26.00	12.00	3.00	11.00		6.02	5.78	5.61	5.34
030	3"	3.500	29.00	14.00	4.00	11.00		14.91	14.31	13.91	13.23
040	4"	4.500	31.00	15.00	5.00	11.00		24.99	23.90	23.16	21.91
060	6"	6.625	36.00	16.00	6.00	14.00		54.86	52.28	50.51	47.53
080	8"	8.625	38.00	16.00	8.00	14.00		94.21	89.42	86.16	77.08
100	10"	10.750	40.00	16.00	10.00	14.00		154.40	146.32	140.83	131.54
120	12"	12.750	42.00	16.00	12.00	14.00		231.48	219.29	210.96	196.90
140	14"	14.000	42.00	16.00	12.00	14.00		279.45	264.73	254.70	237.75
160	16"	16.000	42.00	16.00	12.00	14.00		373.47	354.18	341.13	318.96
180	18"	18.000	42.00	14.00	14.00	14.00		467.86	443.53	426.94	398.92
200	20"	20.000	42.00	14.00	14.00	14.00		573.40	543.34	522.88	488.22
240	24"	24.000									

Warranty / Insurance Information:

All products manufactured shall be free from defects in material and workmanship under normal use and service within limitation. If a product is believed to be defective and on examination by the Quality Assurance department discovers this is the case the product will be repaired or replaced at no cost. General Liability coverage is provided for bodily injury and property damage arising out of products sold or distributed or out of operations performed for someone else after the operations have been completed.

QUALITY ASSURANCE:

QMS2013-01 Revision A (comparable with ANSI ISO/ASQ Q9001-2000)

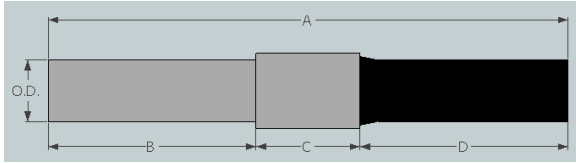

RAW MATERIAL SPECIFICATIONS	
POLY PIPE	High Density Polyethylene PE3408/4710
METALLIC PIPE	316 Stainless Steel
FINISH	Plain

FINISHED PRODUCT SPECIFICATIONS
ASTM D2513, ASTM 1973-05, D1599, D1598 Category 1

STANDARD STOCK SIZES / PRESSURE RATINGS					
Size Range	3/4" - 14" IPS				
SDR	7	9	11	17	SDR
PSI	336	252	202	126	PSI

Other O.D's, SDR's and Pressure Ratings available upon Request.
This transition can be converted to Category 1 upon request
(Additional charges apply)

Code	Nominal Pipe Size	O.D. (inch)	DIMENSIONAL DATA					WEIGHT PER EACH			
			A	B	C	D	E	SDR-7	SDR-9	SDR-11	SDR-17
007	3/4"	1.050	17.00	7.00	3.00	7.00		3.08	2.75	3.22	3.22
010	1"	1.315	17.00	7.00	3.00	7.00		3.08	2.75	3.22	3.22
012	1-1/4"	1.660	17.00	7.00	3.00	7.00		2.33	2.24	2.19	1.88
015	1-1/2"	1.900	17.00	7.00	3.00	7.00		2.97	2.86	2.78	2.37
020	2"	2.370	26.00	12.00	3.00	11.00		6.02	5.78	5.61	5.34
030	3"	3.500	29.00	14.00	4.00	11.00		14.91	14.31	13.91	13.23
040	4"	4.500	31.00	15.00	5.00	11.00		24.99	23.90	23.16	21.91
060	6"	6.625	36.00	16.00	6.00	14.00		54.86	52.28	50.51	47.53
080	8"	8.625	38.00	16.00	8.00	14.00		94.21	89.42	86.16	77.08
100	10"	10.750	40.00	16.00	10.00	14.00		154.40	146.32	140.83	131.54
120	12"	12.750	42.00	16.00	12.00	14.00		231.48	219.29	210.96	196.90
140	14"	14.000	42.00	16.00	12.00	14.00		279.45	264.73	254.70	237.75
160	16"	16.000	42.00	16.00	12.00	14.00		373.47	354.18	341.13	318.96
180	18"	18.000	42.00	14.00	14.00	14.00		467.86	443.53	426.94	398.92
200	20"	20.000	42.00	14.00	14.00	14.00		573.40	543.34	522.88	488.22
240	24"	24.000									

Warranty / Insurance Information:

All products manufactured shall be free from defects in material and workmanship under normal use and service within limitation. If a product is believed to be defective and on examination by the Quality Assurance department discovers this is the case the product will be repaired or replaced at no cost. General Liability coverage is provided for bodily injury and property damage arising out of products sold or distributed or out of operations performed for someone else after the operations have been completed.

QUALITY ASSURANCE:

QMS2013-01 Revision A [comparable with ANSI ISO/ASQ Q9001-2000]